

Jeep® JK Wrangler Mirror Relocation Brackets

Contents:

1. Left Relocation Bracket (1)
2. Right Relocation Bracket (1)
3. Filler Plate (2)
4. Shim (2)

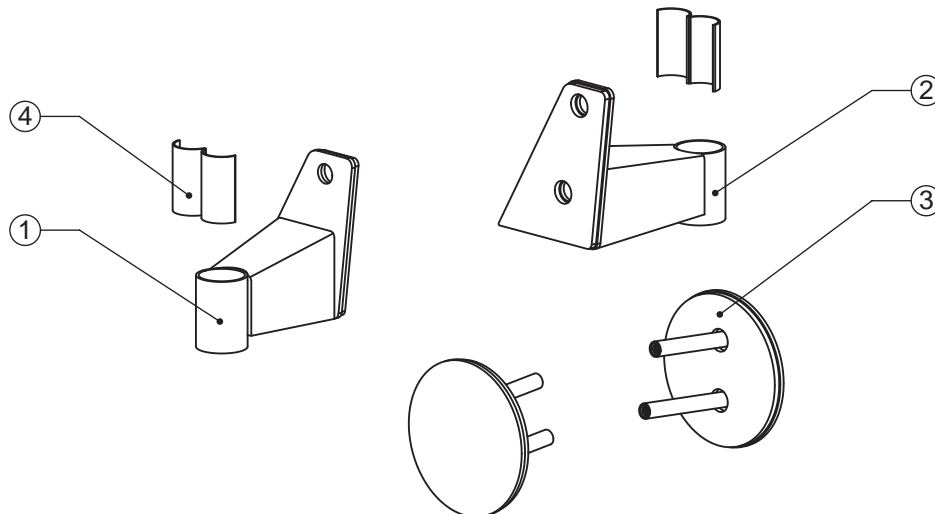

1. Using a #40 torx head bit or socket, unscrew the torx head bolt located under the head of the mirror. Do not discard this bolt, as it will be used later for reassembly. Remove the mirror head.

NOTE: Some force may be needed to remove the mirror head from the bracket.

Carefully work the mirror head from side to side until it is free.



2. Open the front door and lower the window. Working through the window, use a #40 torx to remove the 2 bolts located on the inside in front of the door panel. Hold the mirror bracket to keep it from falling and damaging the door or paint. Do not discard these bolts, as they will be used later for reassembly.



3. Remove the front 2 torx head bolts from the windshield retainer bracket. Do not discard these bolts, as they will be used later for reassembly.



4. Install the mirror relocation bracket using the bolts removed in step 3. Alternate between the upper and lower bolts while tightening. Adjust the bracket as you tighten to properly align it to the top of the fender and door line.



5. Install the door filler plate using the bolts removed in step 2, again working through the open window. The longer mounting boss gets installed in the lower hole and the shorter boss in the upper hole. Alternate between the upper and lower bolts while tightening.



6. Due to production changes made in late 2008, on newer Wranglers it is required that the plastic shim be used when installing the mirror head into the mirror relocation bracket. This is to account for the smaller shaft diameter on these later model mirrors. If your mirrors fit snugly into the Relocation Brackets then the shims can be discarded.



7. Insert the mirror into the new relocation bracket as shown. Start the torx head bolt that was removed in step 1. Tighten the bolt so that the mirror is snug but still movable inside of the mirror relocation bracket. Open the door and adjust the mirror parallel to the door. After the mirror has been repositioned, tighten the bolt until the breakaway feature works.

NOTE: DO NOT OVERTIGHTEN! The mirror head base is made of aluminum and can easily be stripped.



LIMITED 12 MONTH WARRANTY **Applies to Rugged Ridge by Omix-Ada Inc. Products**

Rugged Ridge Off Road (the Company) warrants to the original purchaser of this product that should the product or any part thereof, under normal use and conditions, be proven defective in material or workmanship within 12 MONTHS from the date of original purchase, such defect(s) will be repaired or replaced or credited at the Company's sole option.

To obtain repair or replacement within the terms of this Warranty, the product is to be delivered with proof of warranty coverage (e.g. Dated bill of sale), specification of defect(s) to the place of purchase or, with prior approval from the Company (Return Authorization Number is required), freight pre-paid to the Company address listed below.

This warranty does not apply to any product or part thereof which, in the opinion of the Company, has suffered or been damaged through alteration, improper installation, mishandling, misuse, neglect, accident or by acts of nature. THE EXTENT OF THE COMPANY'S LIABILITY UNDER THIS WARRANTY IS LIMITED TO THE REPAIR OR REPLACEMENT PROVIDED ABOVE AND, IN NO EVENT, SHALL THE COMPANY'S LIABILITY EXCEED THE PURCHASE PRICE PAID BY PURCHASER FOR THE PRODUCT.

This Warranty is in lieu of all express warranties or liabilities. ANY IMPLIED WARRANTIES, INCLUDING ANY IMPLIED WARRANTY OF MERCHANTABILITY, SHALL BE LIMITED TO THE DURATION OF THIS WRITTEN WARRANTY. ANY ACTION FOR BREACH OF ANY WARRANTY HEREUNDER INCLUDING ANY IMPLIED WARRANTY OF MERCHANTABILITY MUST BE BROUGHT WITHIN THE PERIOD OF 12 MONTHS FROM DATE OF ORIGINAL PURCHASE.

IN NO CASE SHALL THE COMPANY BE LIABLE FOR ANY CONSEQUENTIAL OR INCIDENTAL DAMAGES FOR BREACH OF THIS OR ANY OTHER WARRANTY, EXPRESS OR IMPLIED, WHATSOEVER. No person or representative is authorized to assume for the Company any liability other than expressed herein in connection with the sale of this product.

Some States do not allow limitations on how long an implied warranty lasts or the exclusion or limitation of incidental or consequential damage, so the above limitations may not apply to you. This warranty gives you specific legal rights and you may also have other rights, which vary from state to state.

Omix-Ada Inc.
460 Horizon Dr. Suite 400
Suwanee, Georgia 30024