

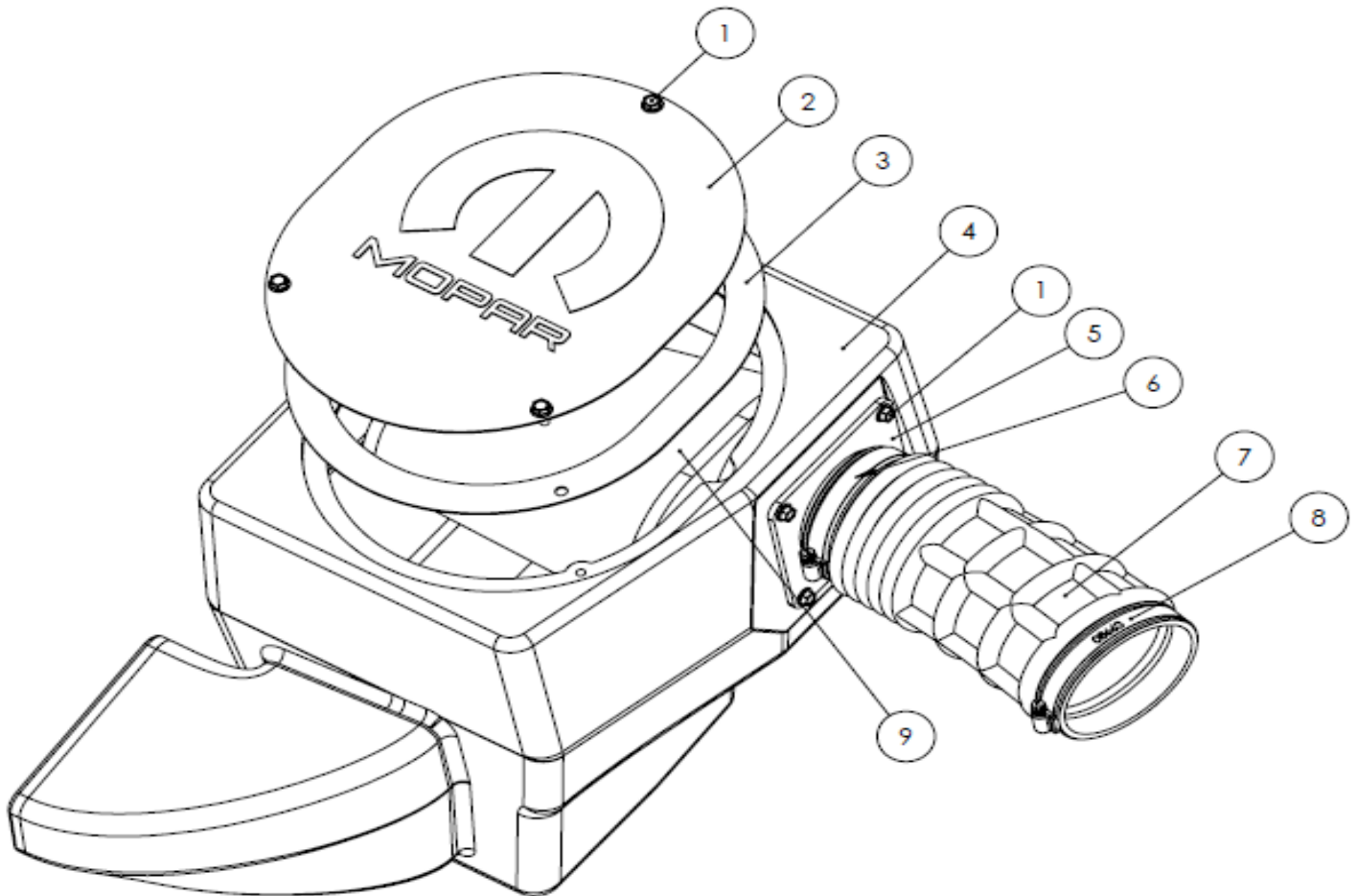

INSTALLATION INSTRUCTIONS
AIR INTAKE KIT
2013-2014 RAM 3.6L V6
PART NUMBER 77070055

Bill of Materials for 77070055

No.	Qty.	Part No.	Description
1	7	08373	Bolt; M6 x 1.00 x 16 Hex; FLG
2	1	010142M	MOPAR Closing Panel
3	1	346001	Seal, Closing Panel
4	1	341012	Air Box
5	1	27371M	Air Filter Adaptor Tube
6	1	9456	#56 Hose Clamp
7	1	08663	Hose, Coupler, Ram DS 3.6L
8	1	9460	#60 Hose Clamp
9	1	MP-M-1013	Filter
Not Shown	1	08514	Plug, 5/8", Nylon
Not Shown	1	L77070055	Instructions





INSTALLATION INSTRUCTIONS
AIR INTAKE KIT
2013-2014 RAM 3.6L V6
PART NUMBER 77070055



IMPORTANT:

This kit includes a high-performance DRYFLOW Air Filter.

DO NOT APPLY ANY OIL TO THIS FILTER!

See Step 5 for cleaning instructions.

Read and understand these instructions **BEFORE** attempting to install this product.

1) Getting Started

- a) If engine has run within the past two hours, open the hood and allow it to cool down.
- b) Make sure the vehicle is parked on a level surface.
- c) Set the parking brake.
- d) Disconnect the negative battery terminal.
- e) Open the air intake kit package and make sure all parts are included.

2) Removal of the stock intake system



a) The stock air intake system should look like this.



INSTALLATION INSTRUCTIONS
AIR INTAKE KIT
2013-2014 RAM 3.6L V6
PART NUMBER 77070055

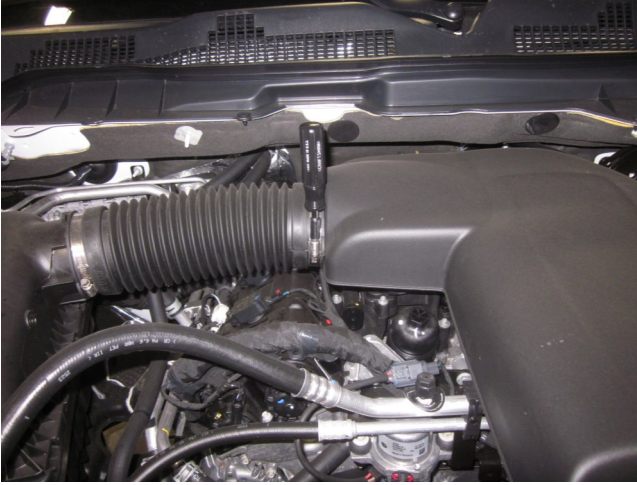

b) Loosen the hose clamp that secures the intake tube to the intake plenum.

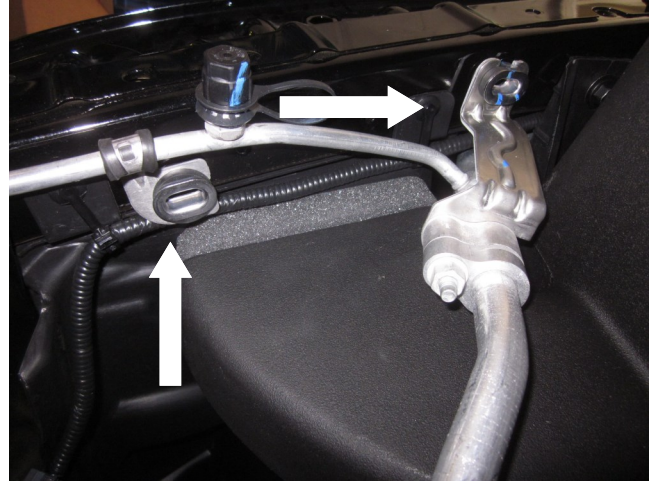

c) Remove the two (2) M6 bolts that secure the A/C line to the core support to provide more room during the air box removal in the next step.



d) Remove the stock intake by lifting up on the air box and sliding it out of vehicle.



INSTALLATION INSTRUCTIONS
AIR INTAKE KIT
2013-2014 RAM 3.6L V6
PART NUMBER 77070055

3) Installation of MOPAR Air Intake System

NOTE: When installing the MOPAR Air Intake System, DO NOT completely tighten the hose clamps or mounting hardware until instructed to do so.

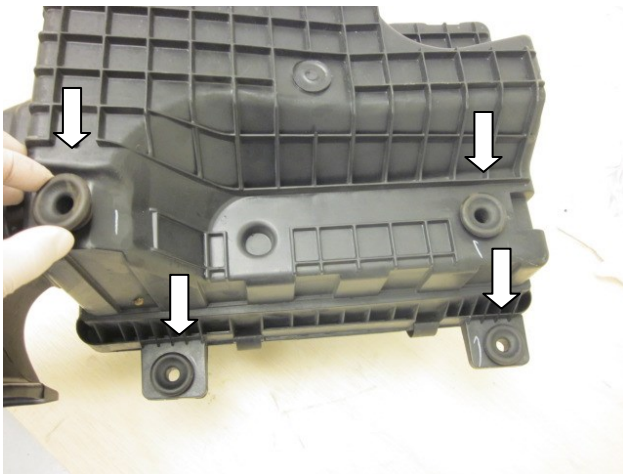

a) Remove the 4 rubber grommets on the bottom of the factory air box.

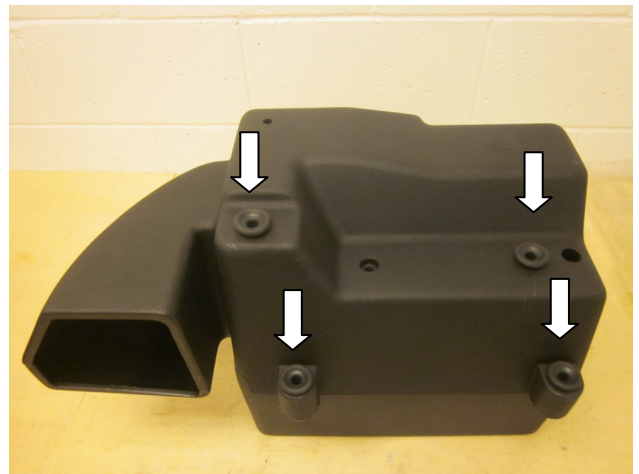

b) Insert the 4 rubber grommets removed in step 3a) into the bottom of the MOPAR air box.



c) Attach the flanged air filter adaptor to the MOPAR air box with four (4) M6 bolts provided to 7 N.m (62 in/lb).



d) Install the supplied adaptor plug into the hole on the air filter.



INSTALLATION INSTRUCTIONS
AIR INTAKE KIT
2013-2014 RAM 3.6L V6
PART NUMBER 77070055



e) Install the hose coupler onto the adapter with the provided hose clamp. **Note:** Do not fully tighten at this time.

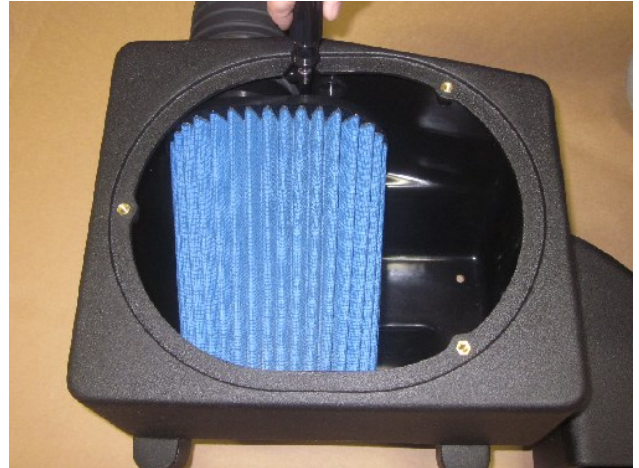

f) Install the air filter into the MOPAR air box and secure the air filter with the provided hose clamp to 3.4 N.m (30 in/lb)



g) Install the complete air box assembly into the engine compartment. **Note:** Make sure the locator pins are fully engaged on the air box once its seated.



h) Connect the intake tube to the intake plenum. **Note:** You may need to rotate the intake tube to achieve correct alignment.



INSTALLATION INSTRUCTIONS
AIR INTAKE KIT
2013-2014 RAM 3.6L V6
PART NUMBER 77070055

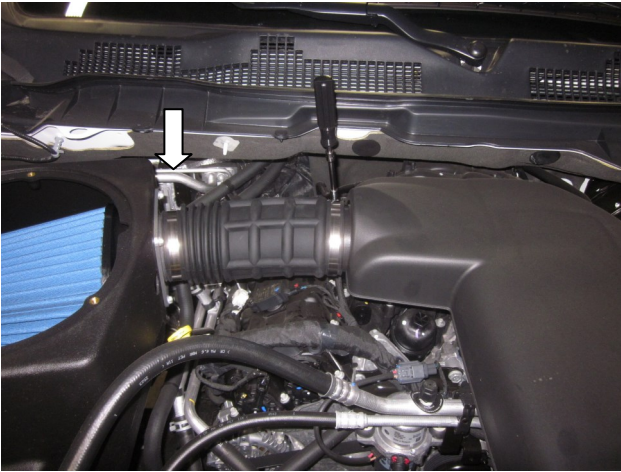

i) Once the intake tube is aligned and the air box is seated, tighten both hose clamps to 3.4 N.m (30 in/lb)

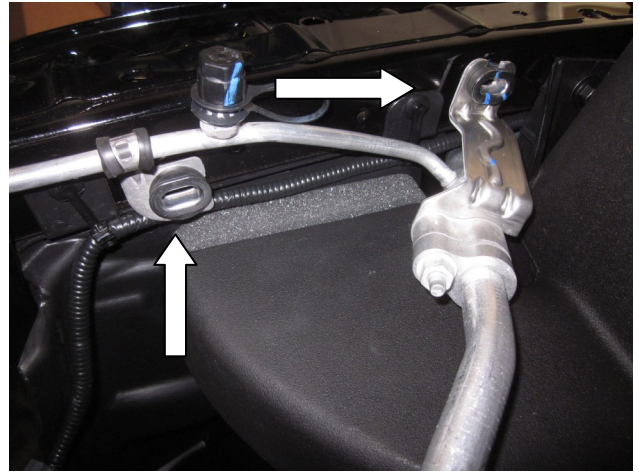

j) Reinstall the (2) M6 bolts securing the A/C line to the core support removed in 2c) and tighten to 9 N.m (80 in/lb).



k) Install the seal on the **back side** of the closing panel making sure to align the 3 holes properly. **Note:** Avoid stretching the seal material while applying it to the panel.

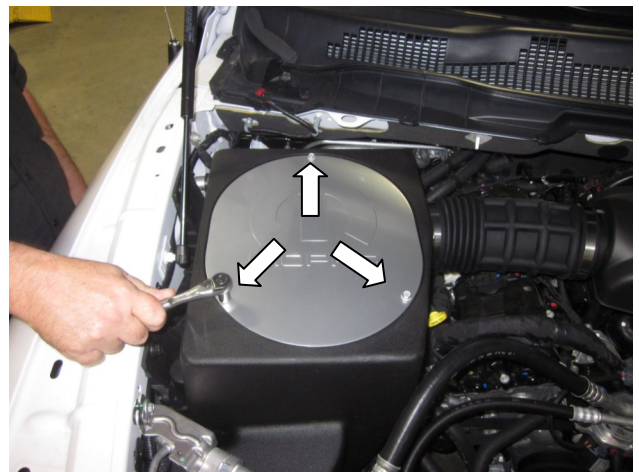

l) Install the MOPAR air box closure panel with the (3) M6 bolts provided and tighten to 7 N.m (62 in/lb).



INSTALLATION INSTRUCTIONS
AIR INTAKE KIT
2013-2014 RAM 3.6L V6
PART NUMBER 77070055



o) Your MOPAR Air Intake system should look like this when properly installed.



INSTALLATION INSTRUCTIONS
AIR INTAKE KIT
2013-2014 RAM 3.6L V6
PART NUMBER 77070055

4) Re-assemble the vehicle

- Inspect all MOPAR Air Intake kit components proximity to A/C lines, dip sticks, hoses for ample clearance.
- Tighten all fasteners and hose clamps.**
- Inspect the engine bay for any loose tools, and then check that all fasteners are tight, and that the IAT sensor cable is properly connected.
- Start the engine and allow it to idle, and then perform a final inspection before driving the vehicle.

5) Cleaning Instructions: MOPAR DRYFLOW Air Filter

(It is recommended that you service your MOPAR air filter every 20,000 miles for optimum performance.)

- Remove the air filter from intake system and set the filter clamp aside.
- Measure the length of the filter media.
- Fill a pail with warm clean water to the depth determined in Step B. Add a mild household detergent or DRYFLOW air filter cleaning solution to the water.
- Without allowing the solution to flow into the filter neck, submerge the filter into the water and let it soak for 10 minutes. After soaking, rotate the filter back and forth to agitate the water and knock off dirt.
- Empty the bucket of dirty water. Repeat steps C and D.
- Refill the pail with clean warm water and rinse by rotating the filter as in step D. The water should be clear with no signs of dirt in the pail.
- Allow the filter to air dry. Re-install the filter on the intake system once it is dry.

DO NOT APPLY ANY OIL TO THIS FILTER.

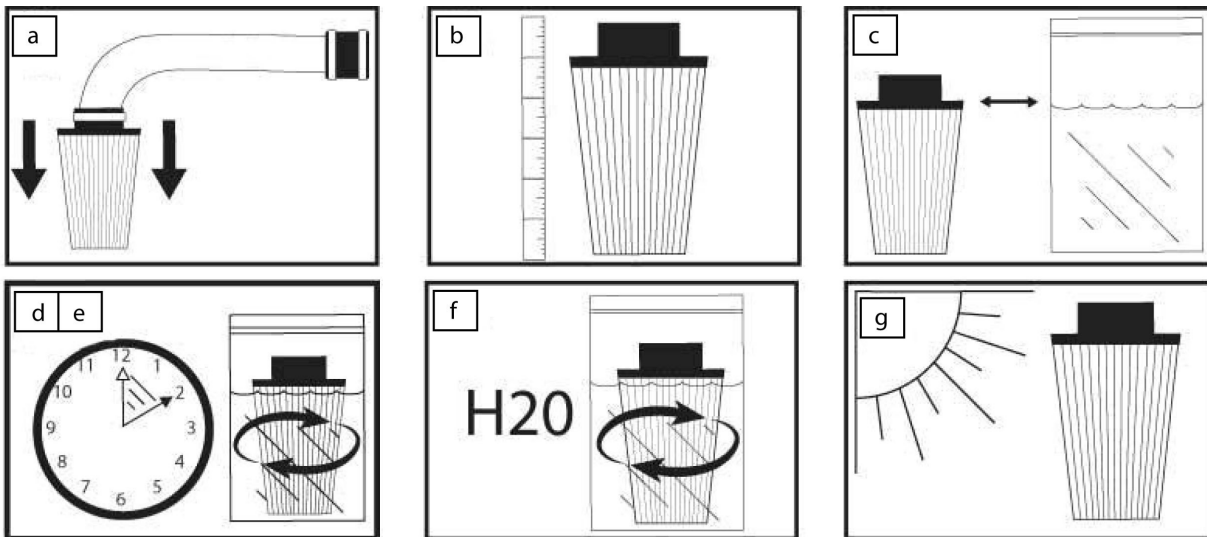

For technical assistance regarding MOPAR Cold Air Intake Systems, please call toll-free 1-888-528-HEMI (528-4364).