

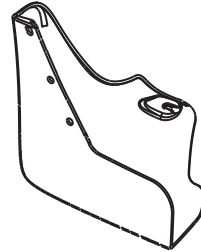

# CHRYSLER 300

## Rear Splash Guards

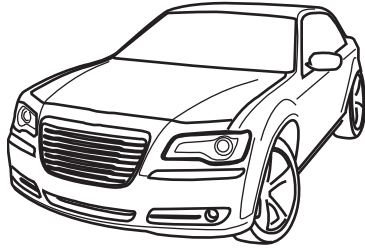

**A** X2

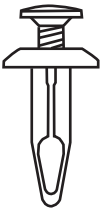

**C** X2

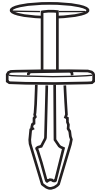

**D** X6

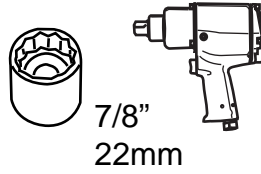
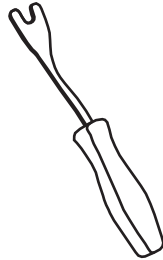

7/8"  
22mm

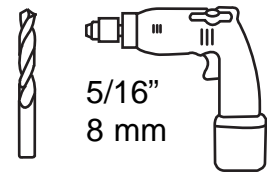

5/16"  
8 mm

1/4"  
6 mm

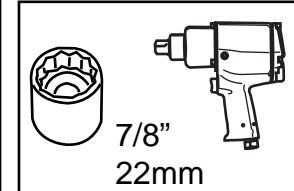
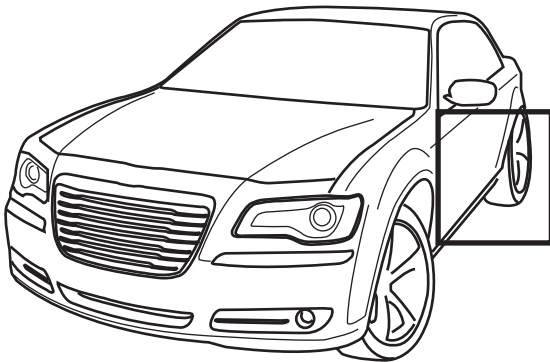

7/8"  
22mm

x5

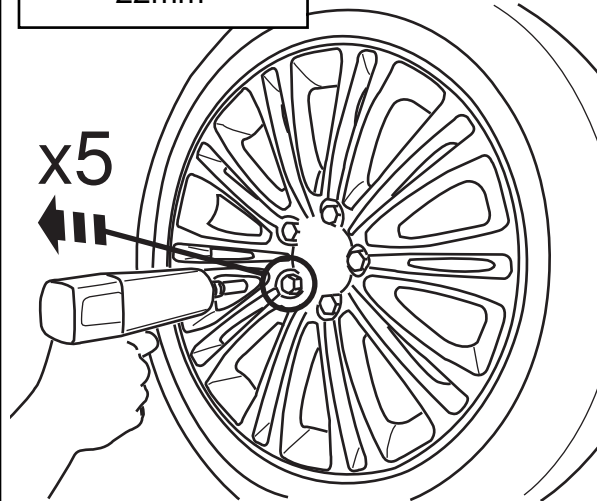

**1**

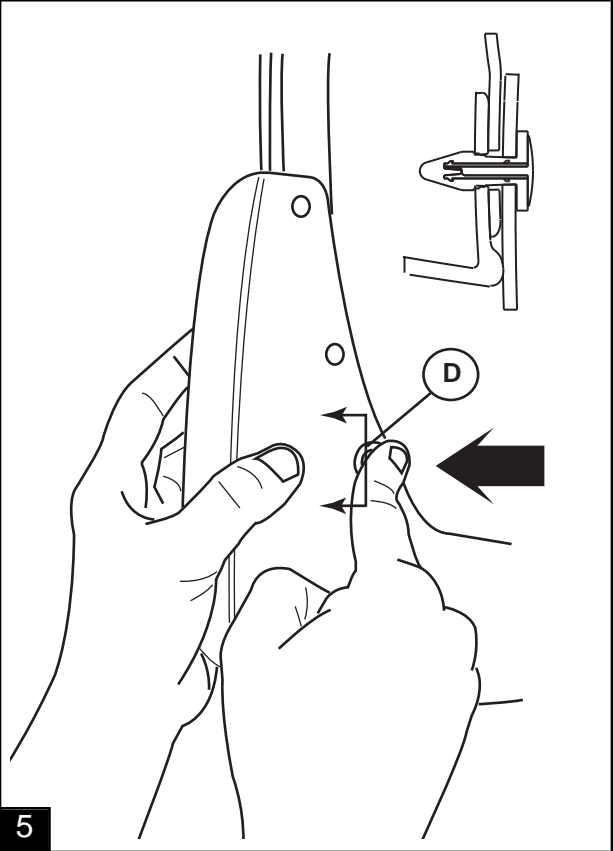
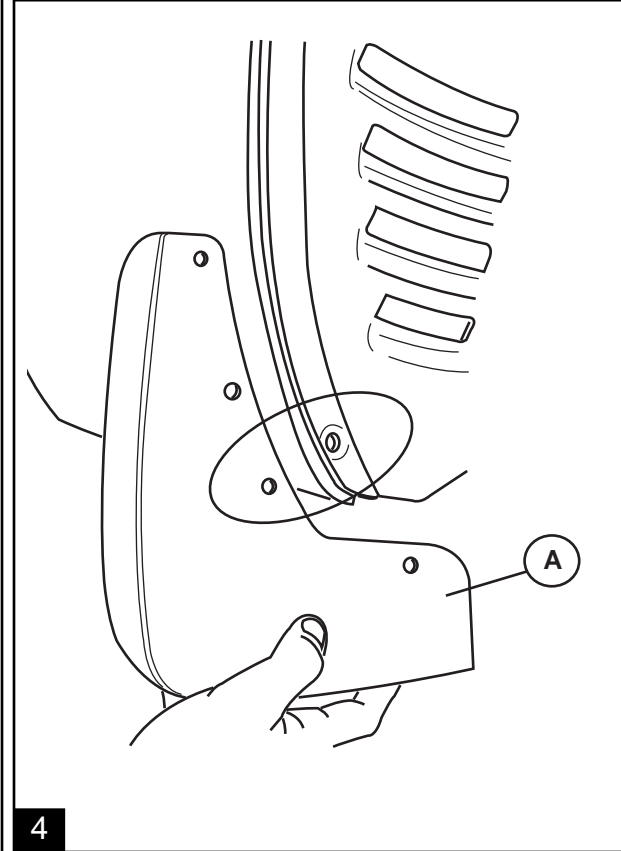
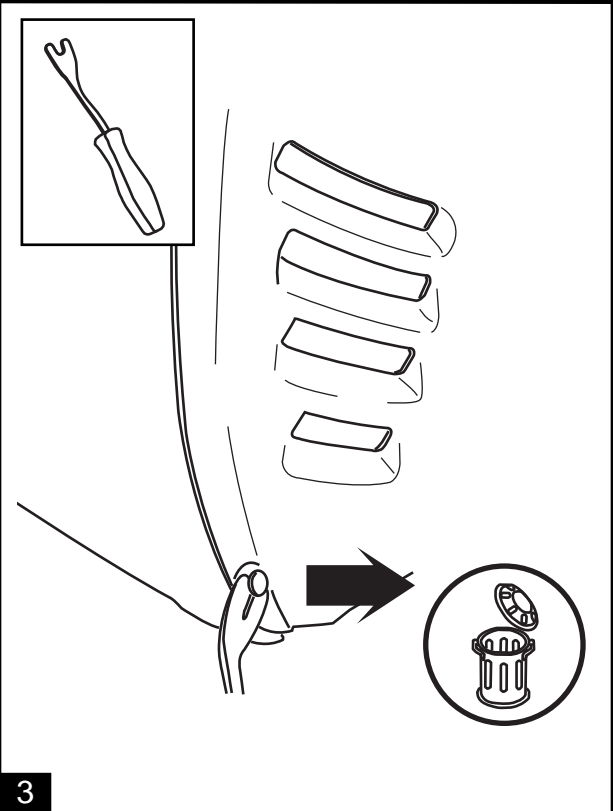
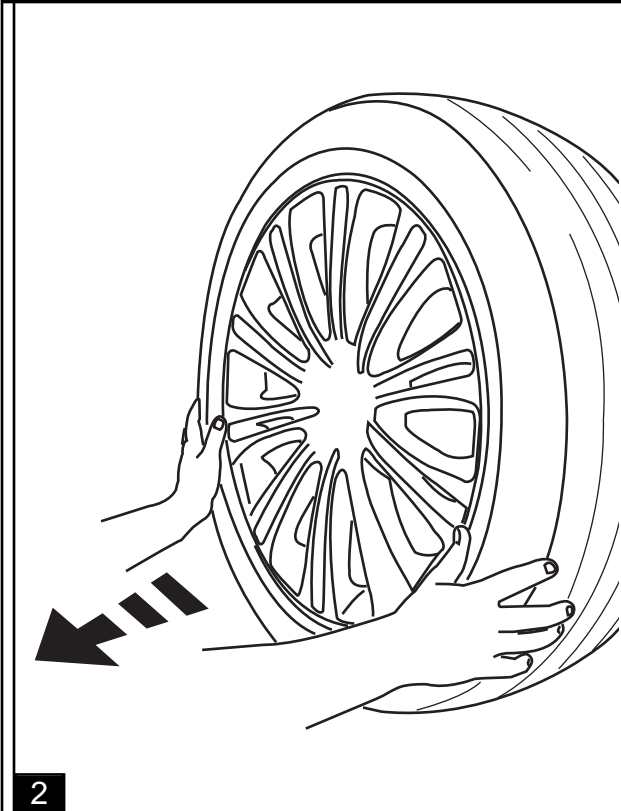

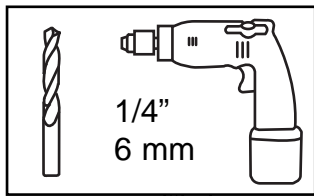

1/4"  
6 mm

No Gap  
Ningún Gap  
Aucun Gap

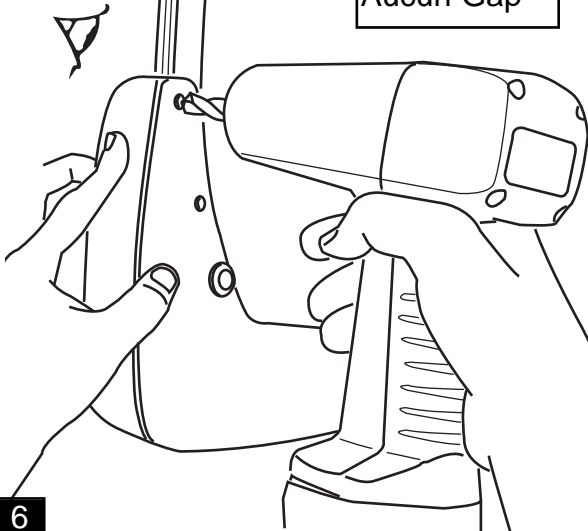

6

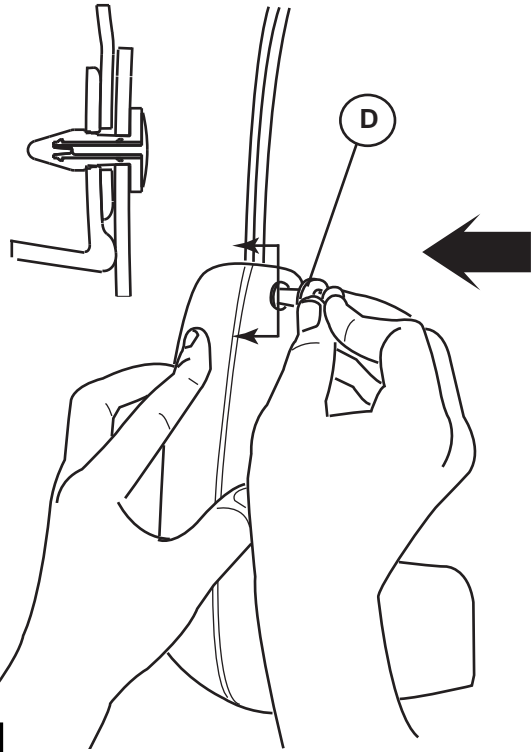

7

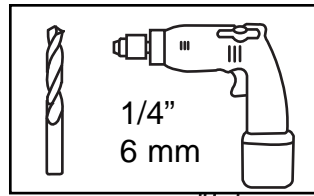

1/4"  
6 mm

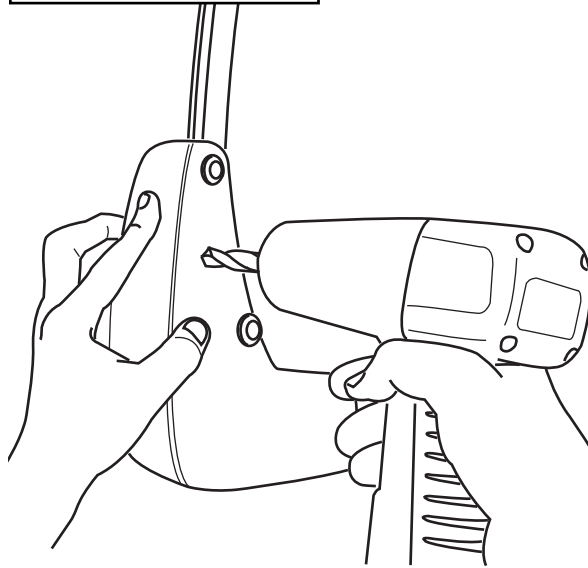

8

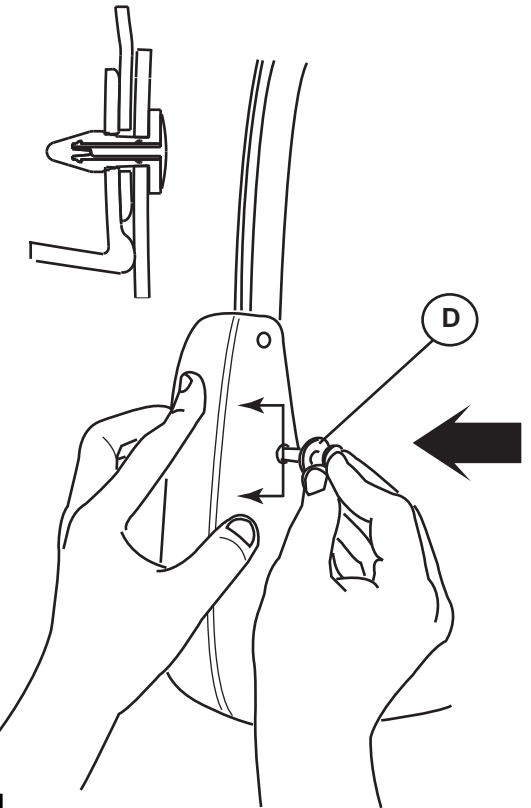

9

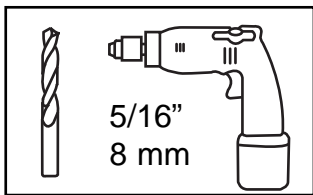

5/16"  
8 mm

No Gap  
Ningún Gap  
Aucun Gap

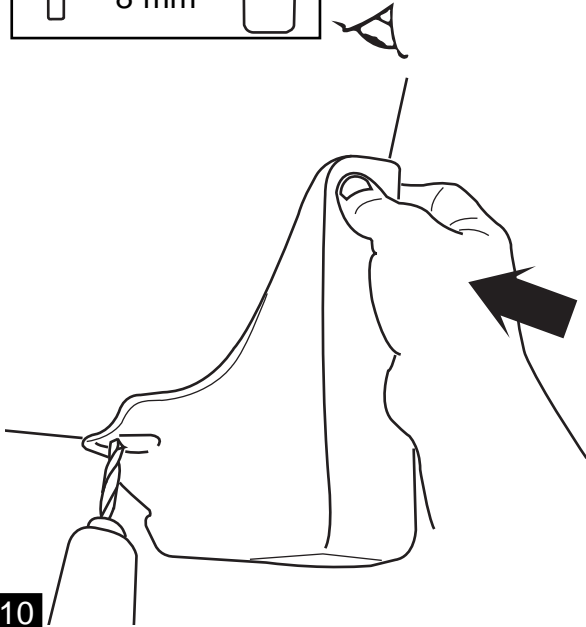

10

No Gap  
Ningún Gap  
Aucun Gap

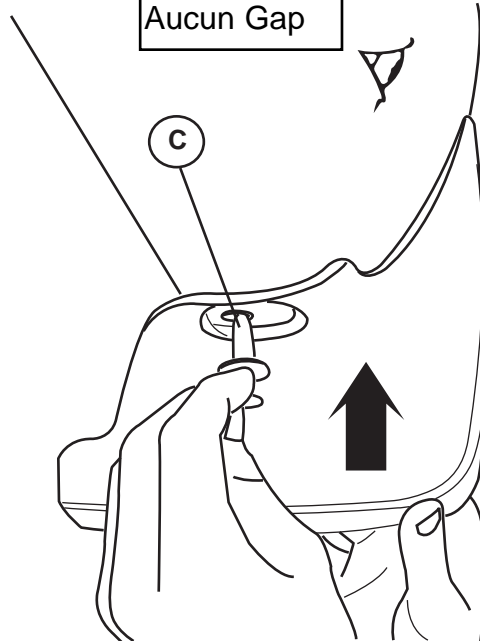

11

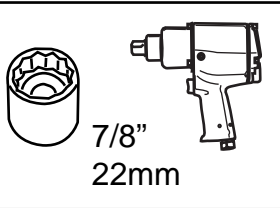

7/8"  
22mm

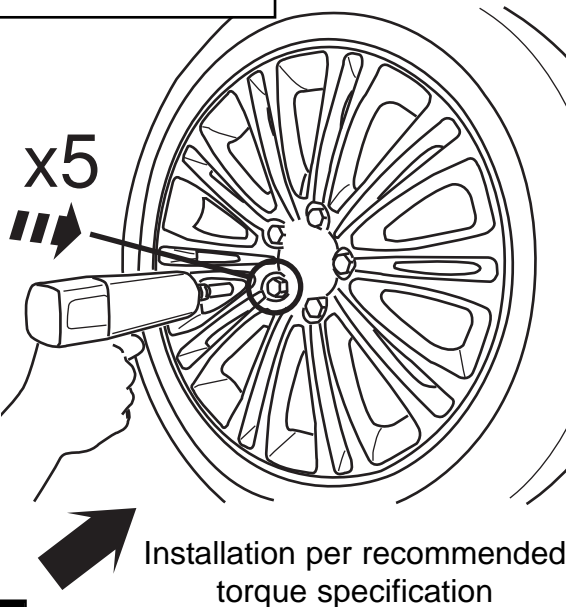

12

- GB** NOTE: Repeat steps 1-12 on the other side
- E** NOTA: Repita estos pasos 1-12 en otro lado
- F** NOTE: Répétez les étapes 1-12 pour l'autre côté
- G** ANMERKUNG: Wiederhole Schritte 1-12 auf der piher Seite
- I** NOTA: Ripetere i passaggi da 1 a 12 su lato

13