

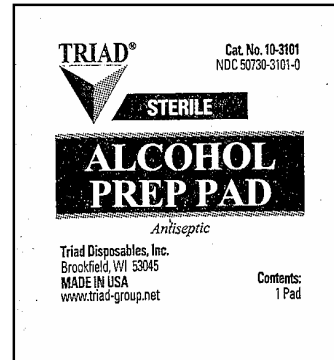

# Cross Vehicle Applications B-Pillar Exterior Trim Appliqué

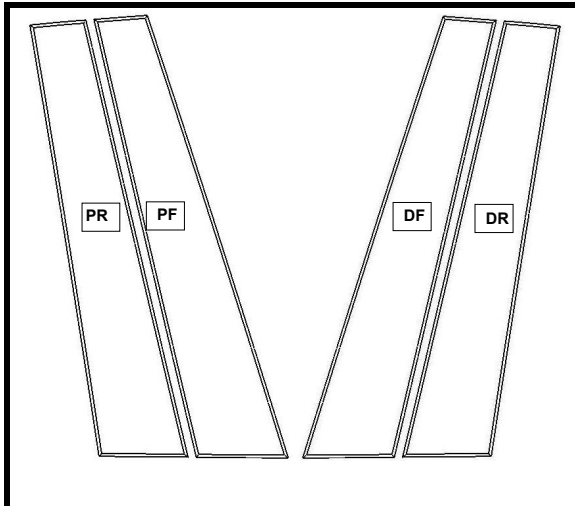

**A**

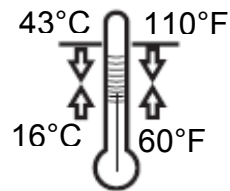

Do not wash vehicle for 24 hours after installation

- Insure that the surface which the trim is to be applied is clean, dry, and free of all oil, grease and wax.

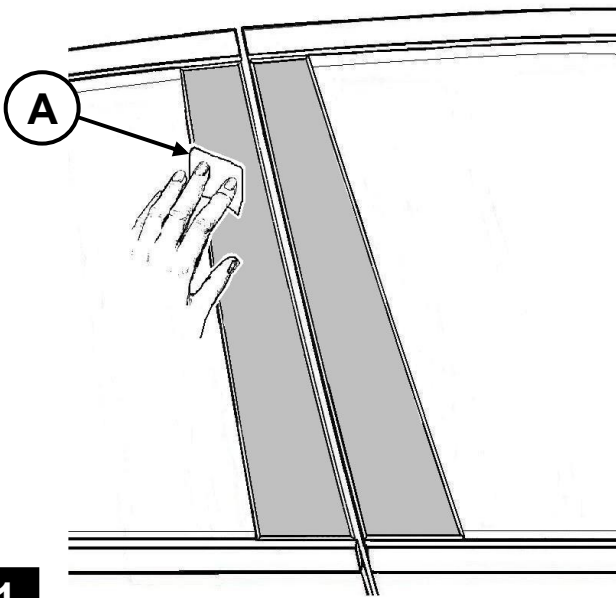

- Prior to removing tape backing on trim piece place the front and rear pillar on the vehicle.

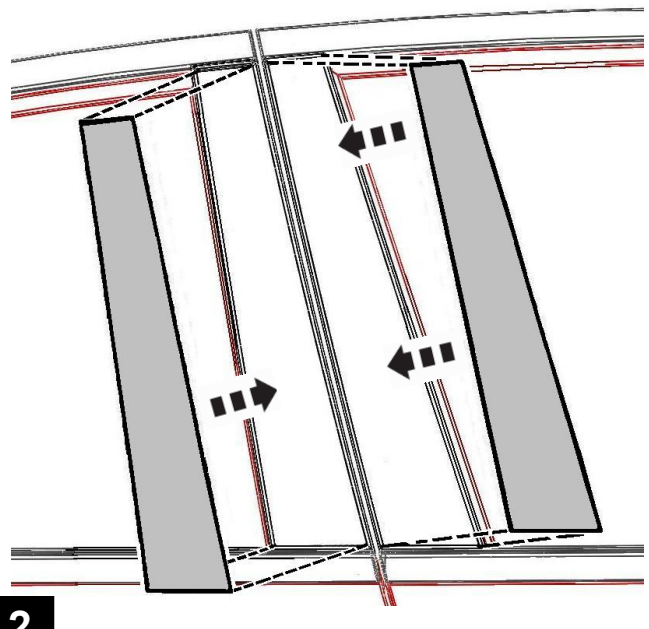

- Align trim pieces so that front and rear doors are equally aligned at the top of door post.

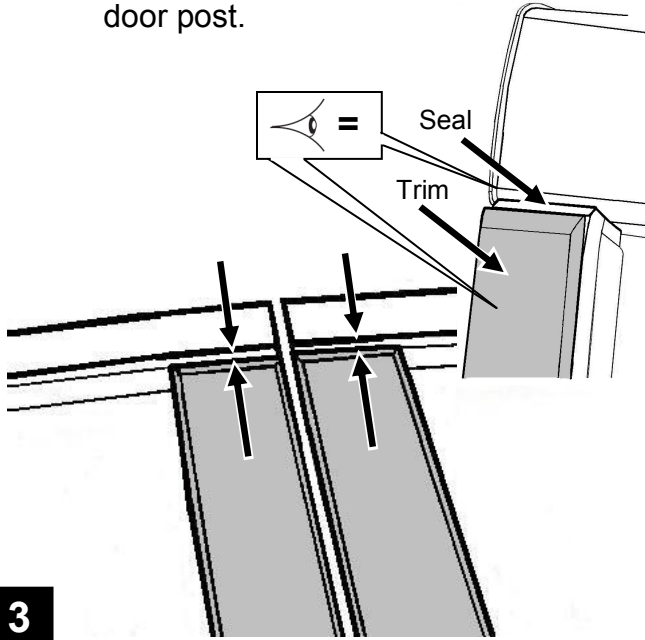

3

- With trim pieces aligned at the top remove tape backing from trim pieces and discard.

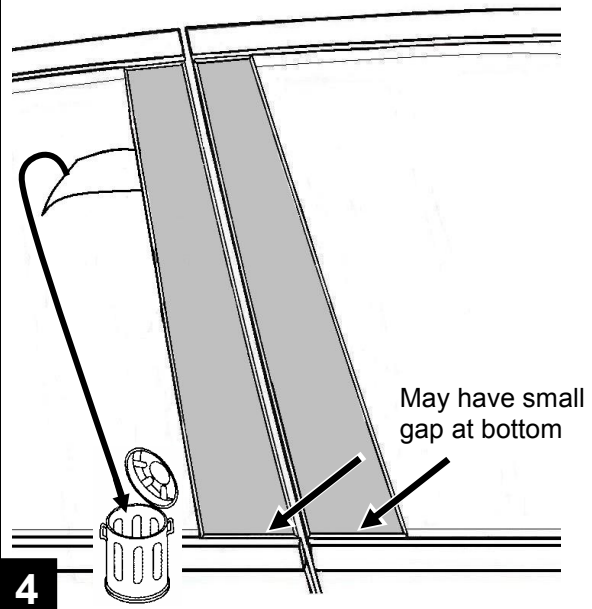

4

- Apply even firm pressure for a minimum of 30 seconds

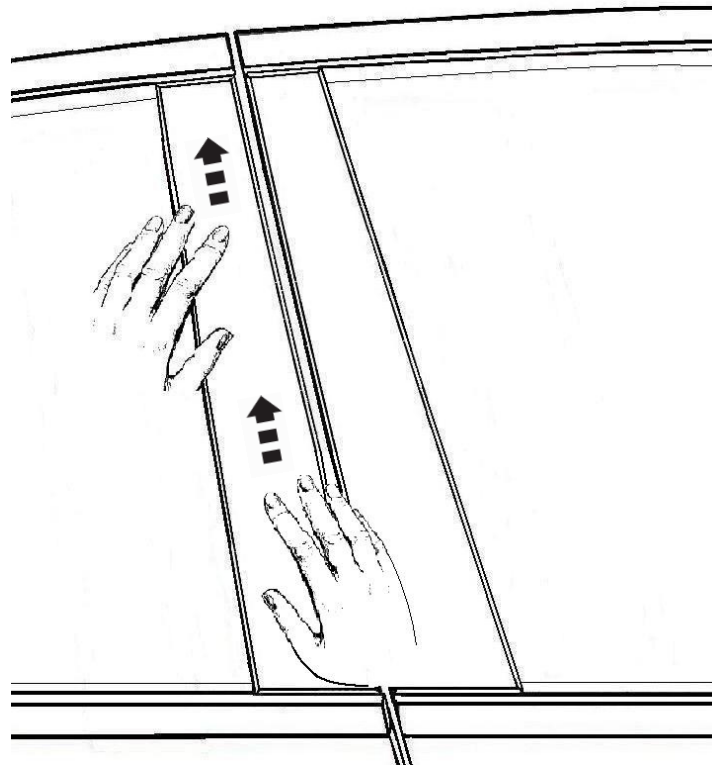

5



# Molduras Exteriores Para Vehiculos

## Molduras Exteriores de Poste B

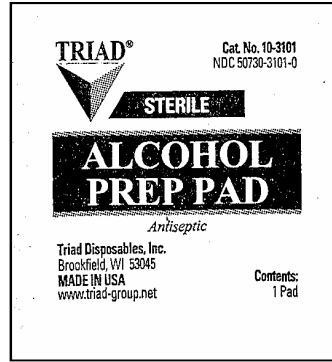
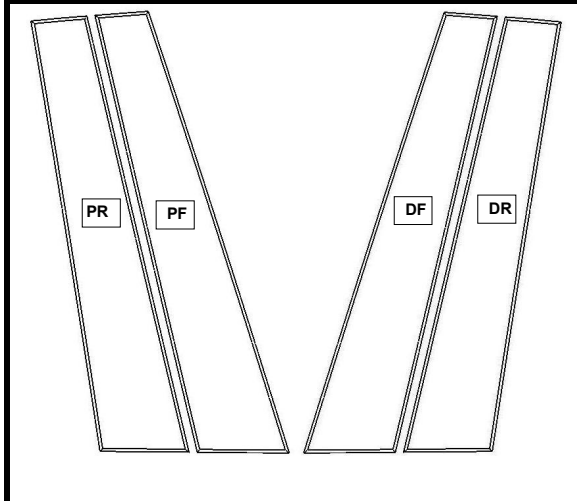

**A**

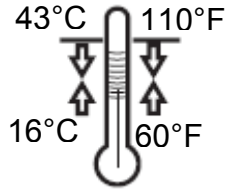

No lave el vehículo por 24 horas después de la instalación

- Asegúrese de que la superficie en que se va a aplicar la moldura esté limpia, seca y libre de aceite, grasa y/o cera.

- Antes de retirar la cubierta de la cinta de la moldura, colóquela en el lugar correspondiente (delantera y trasera).

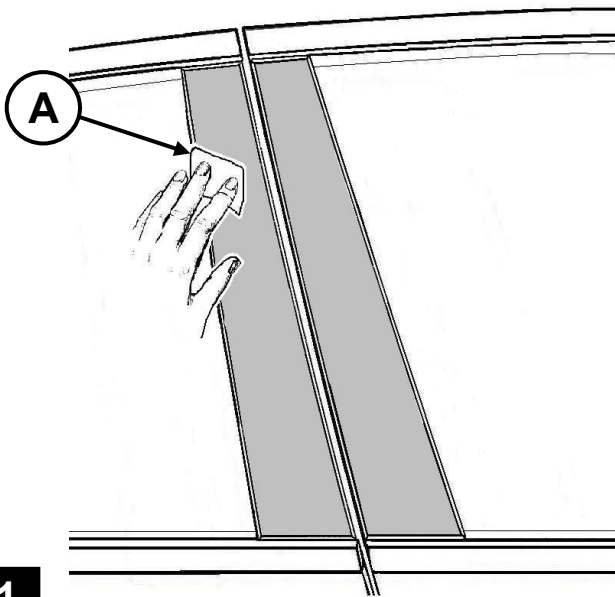

**1**

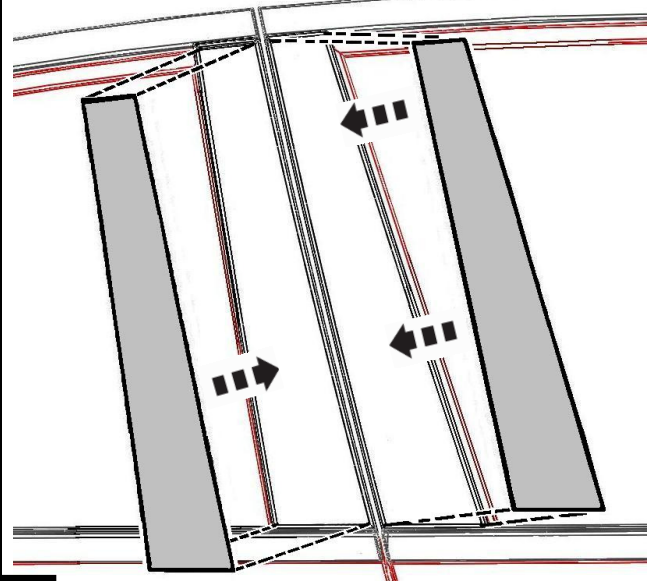

**2**

- Alinee las piezas delantera y trasera de manera que coincidan en la parte superior del poste de la puerta.

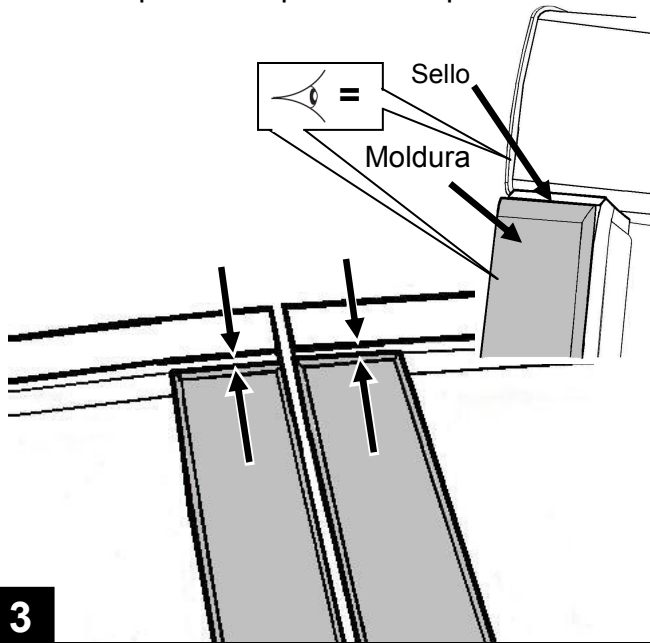

3

- Con las piezas alineadas en la parte superior, retire la cubierta de la cinta y deséchela.

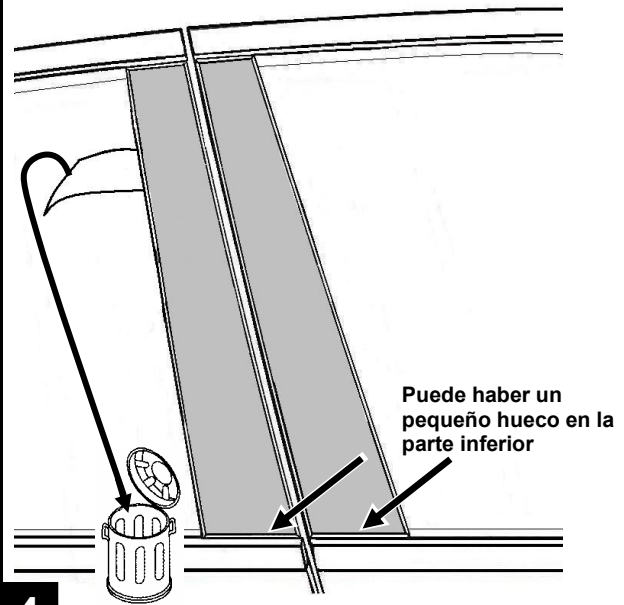

4

- Presione firmemente por un mínimo de 30 segundos

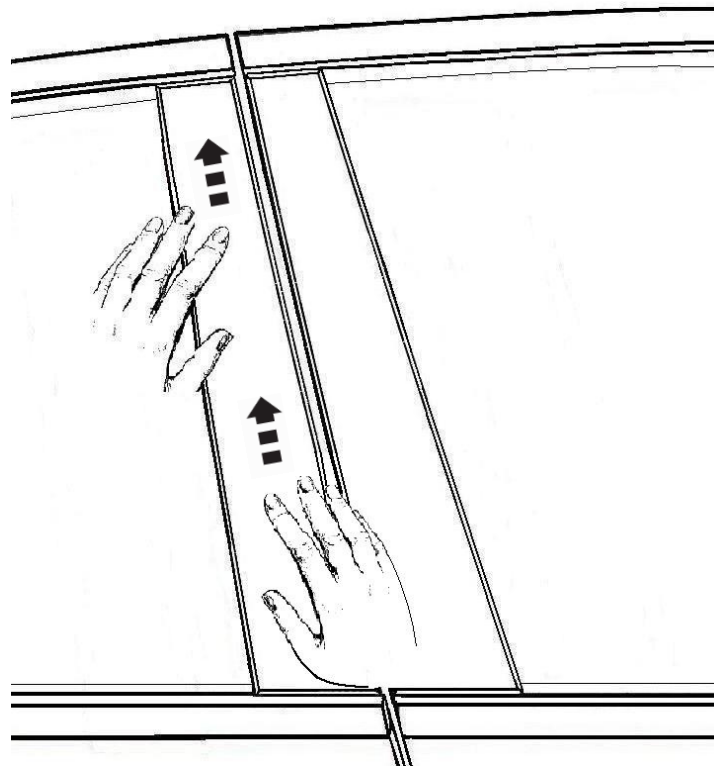

5



# Traverser l'Application Véhicule Appliqué Extérieur Du Pillier-B

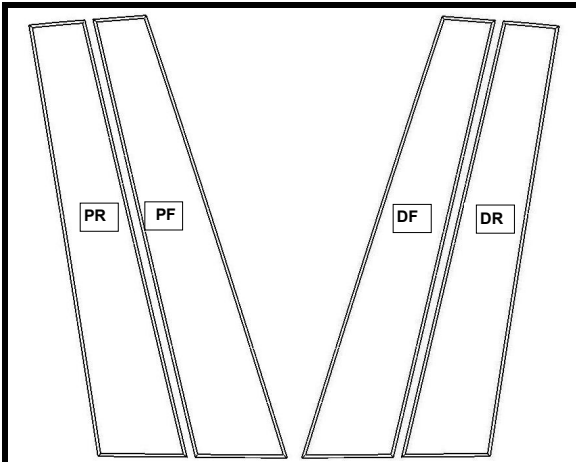

**A**

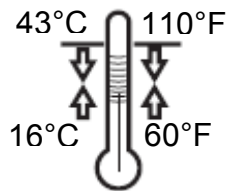
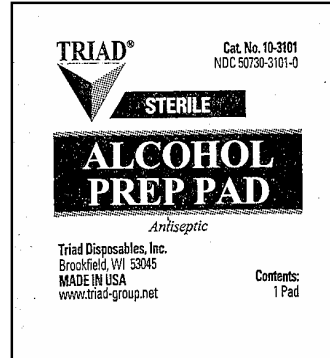

Ne pas laver véhicule pendant  
24 heures après l'installation

S'assurer que la surface ou la garniture doit être appliquée est propre, sèche et exempte d'huile, de graisse et de cire.

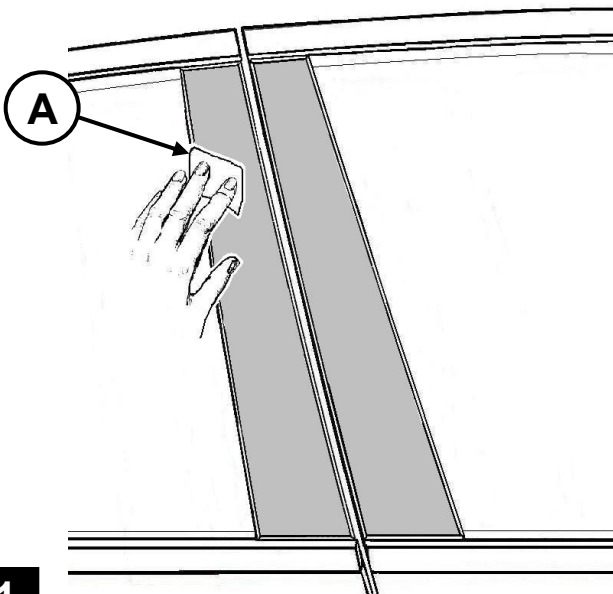

**1**

Avant de retirer l'endos du ruban adhésif sur la garniture, placez la pièce de garniture sur les piliers avant et arrière du véhicule.

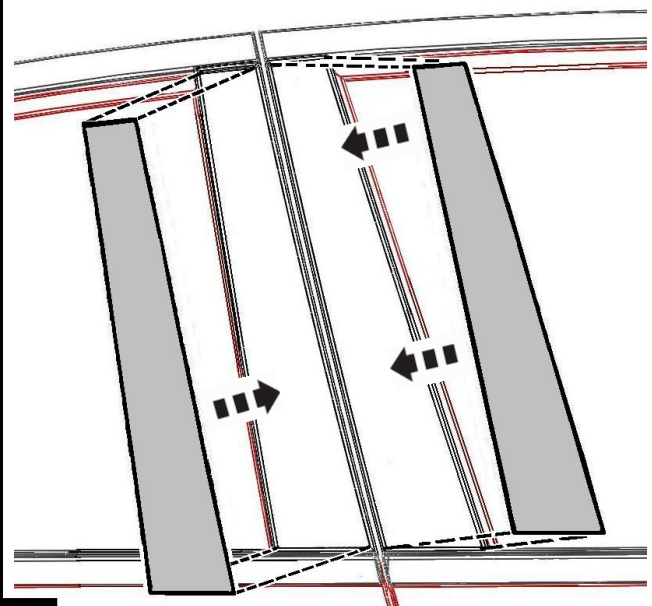

**2**

Alignez les garnitures afin que les portes avant et arrières soient également alignées sur le haut du montant de porte

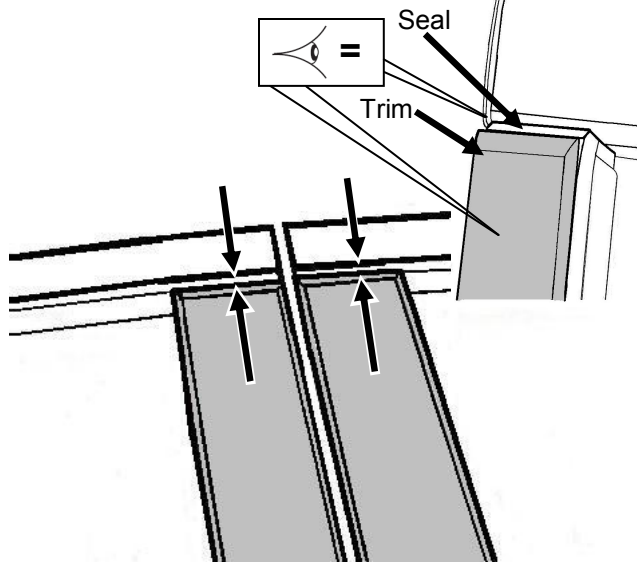

3

Avec les garnitures alignées en haut, retirez la pellicule protectrice du ruban collant des garnitures et jetez-la. Il peut y avoir un petit espace au bas.

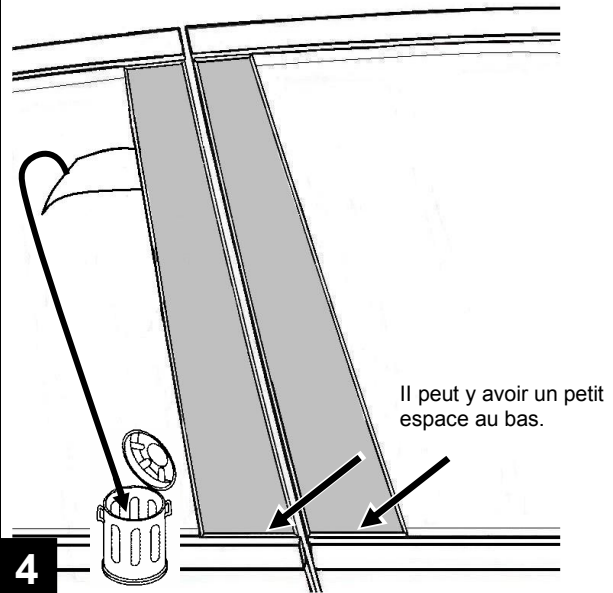

4

Appliquez une pression ferme pour un minimum de 30 secondes

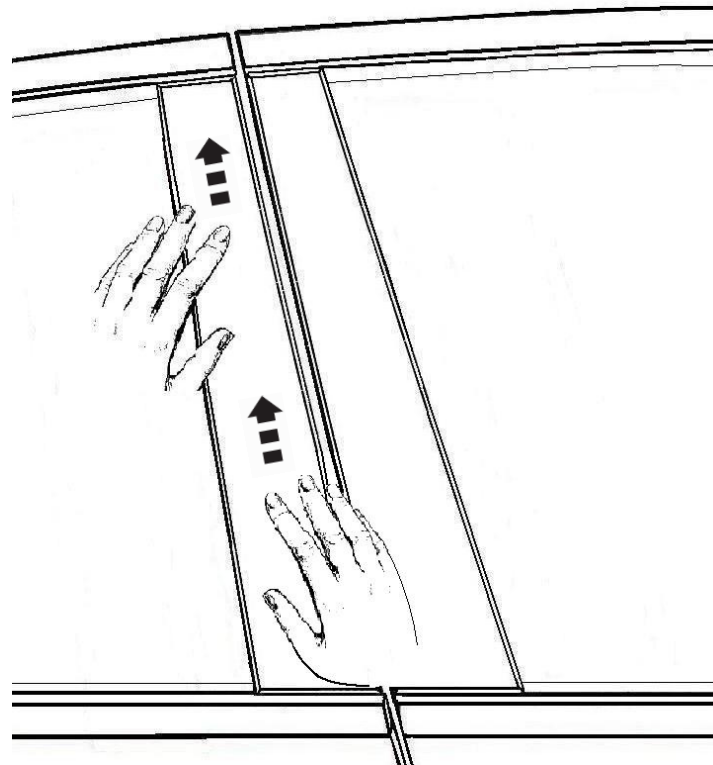

5