

PROCEDURE TO CODE THE LOCK CYLINDER

DO NOT PUT A SIDE LOAD ON LEVER WHILE CODING.

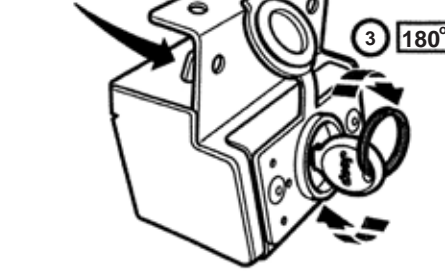

3 WHILE MAINTAINING FULL KEY INSERTION, TURN THE KEY 180° CLOCKWISE. DO NOT PULL UP/DOWN ON KEY WHILE CODING.

PROCEDURE TO LOCK HOOD

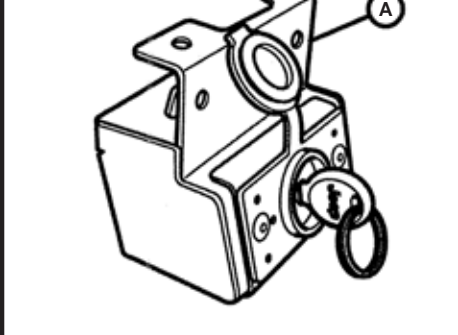

4 KEY IS IN LOCKED POSITION. THE KEY CAN ONLY BE REMOVED IN THE LOCKED POSITION. LOCK IS NOW CODED TO YOUR IGNITION KEY

CYCLE LOCK WITH KEY PRIOR TO RIVETING TO CROSSMEMBER TO ENSURE SUCCESSFUL CODING

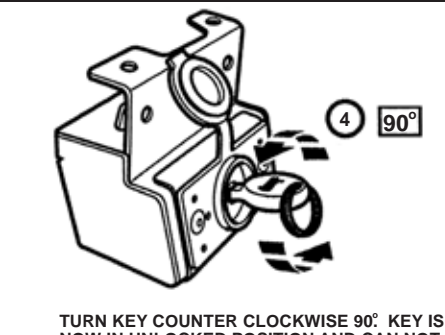

5 TURN KEY COUNTER CLOCKWISE 90°. KEY IS NOW IN UNLOCKED POSITION AND CAN NOT BE REMOVED. LEAVE KEY IN THIS POSITION (UNLOCKED) UNTIL UNIT ASSEMBLED INTO VEHICLE.

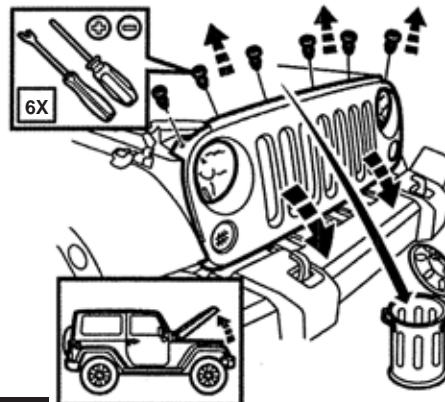

6

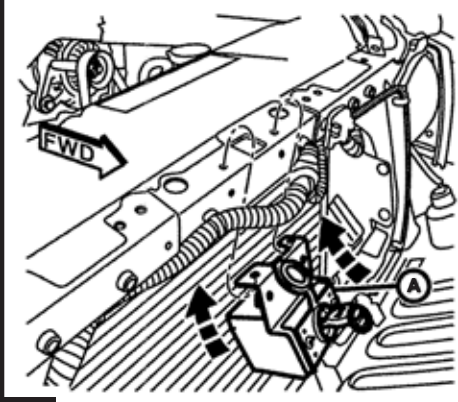

7

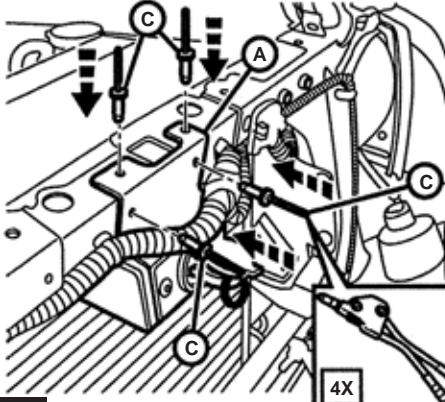

8

PROCEDURE TO LOCK HOOD

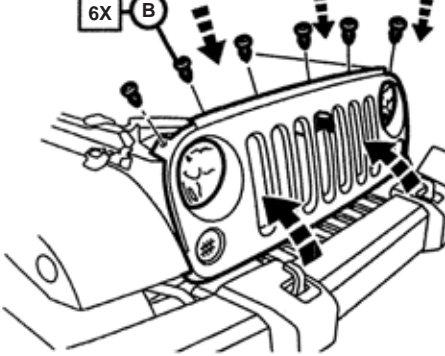

9

PROCEDURE TO LOCK HOOD

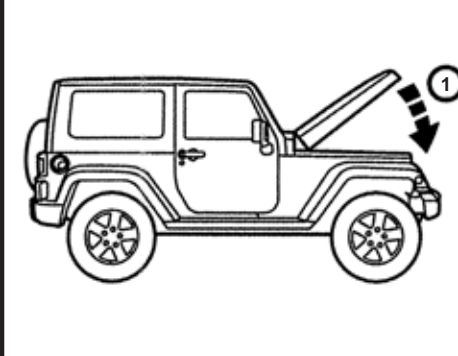

10 CLOSE HOOD.

PROCEDURE TO LOCK HOOD

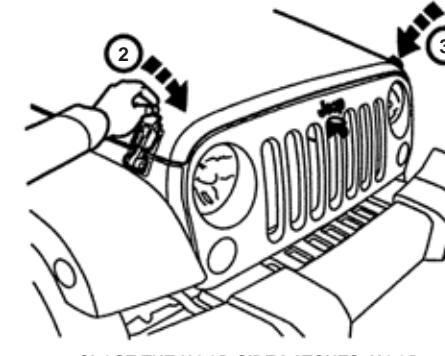

11A CLOSE THE HOOD SIDE LATCHES. HOOD IS CLOSED BUT NOT LOCKED. THE LOCK CYLINDER IS IN THE UNLOCKED POSITION.

PROCEDURE TO LOCK HOOD

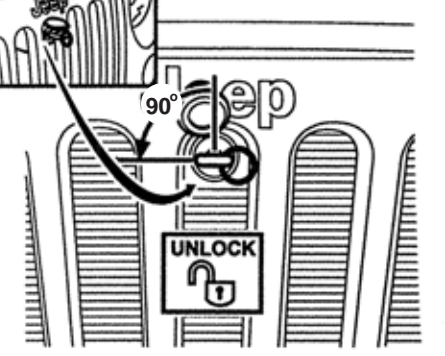

11B NOTE: KEY CAN NOT BE REMOVED IN THE HORIZONTAL CYLINDER POSITION.

PROCEDURE TO LOCK HOOD

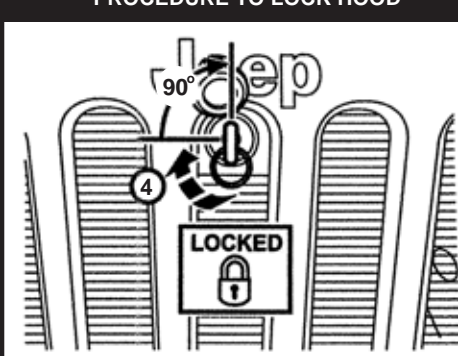

12 TURN KEY CLOCKWISE 90° TO LOCK.

PROCEDURE TO LOCK HOOD

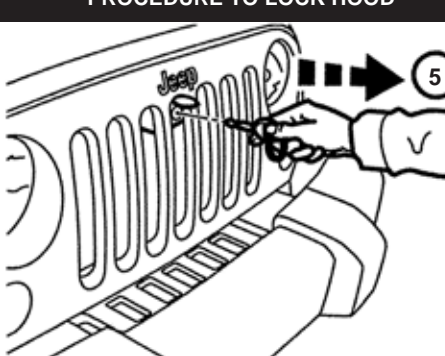

13 HOOD IS NOW LOCKED. KEY CAN NOW BE REMOVED.



JEEP WRANGLER Hood Lock Kit

CODE LOCK BEFORE UNIT IS ASSEMBLED INTO VEHICLE.

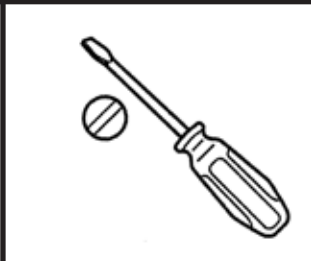
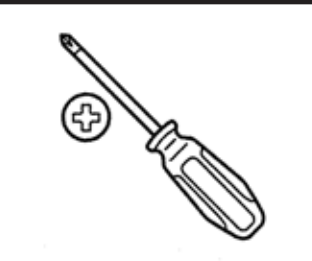
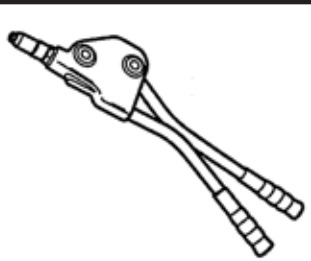
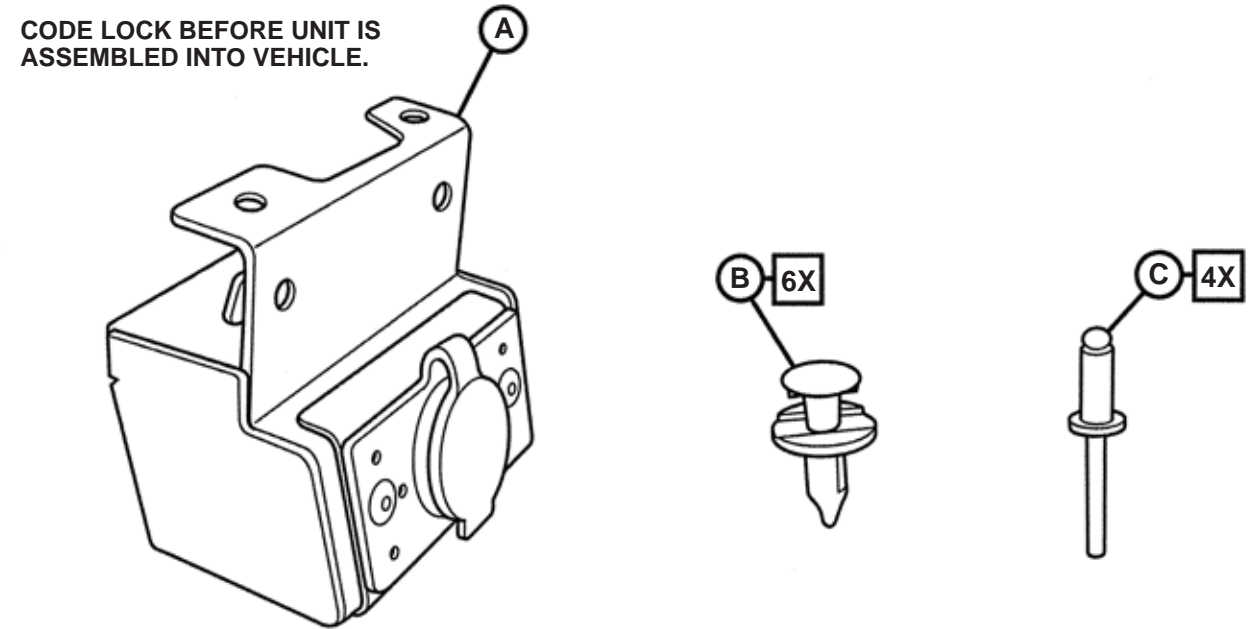

PROCEDURE TO CODE THE LOCK CYLINDER

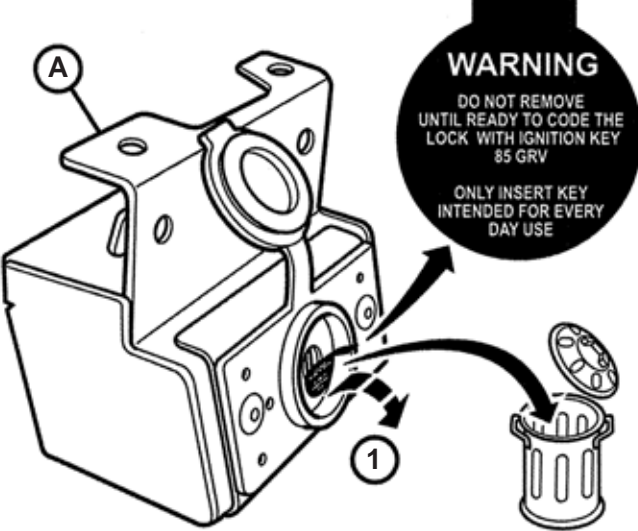

1 READ WARNING LABEL AND REMOVE IT.

PROCEDURE TO CODE THE LOCK CYLINDER

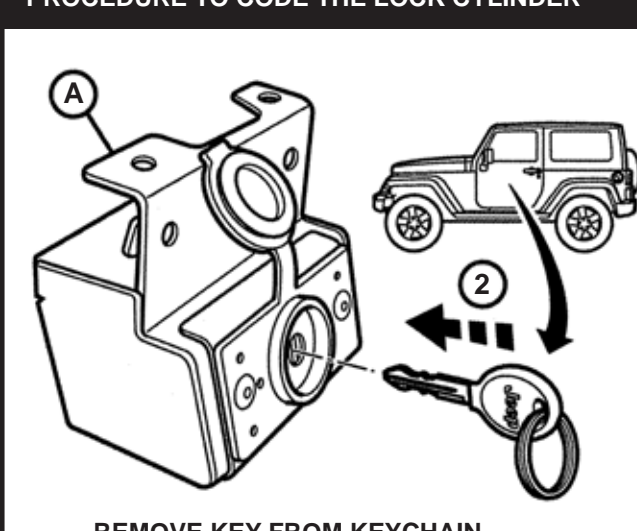

2 REMOVE KEY FROM KEYCHAIN PRIOR TO INSERTING INTO LOCK. FULLY INSERT THE IGNITION KEY.