



DODGE CHARGER FOG LIGHTS

DODGE CHARGER PHARES ANTIBROUILLARD

DODGE CHARGER LUCES DE NIEBLA

www.mopar.com

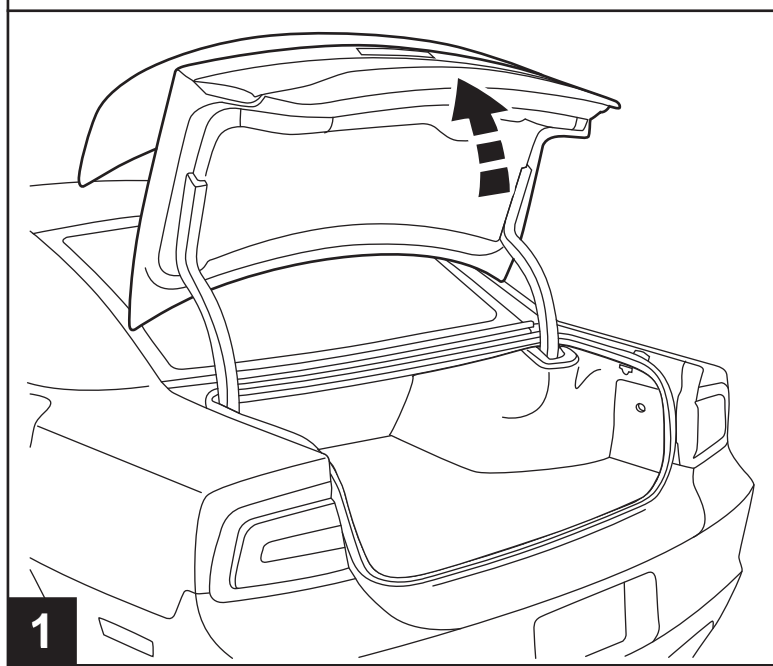
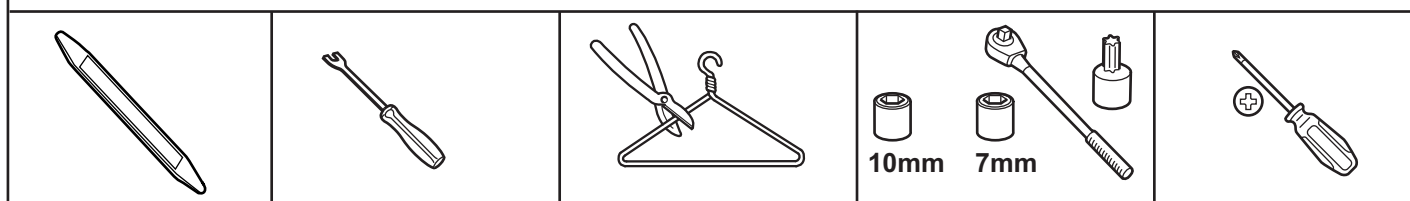
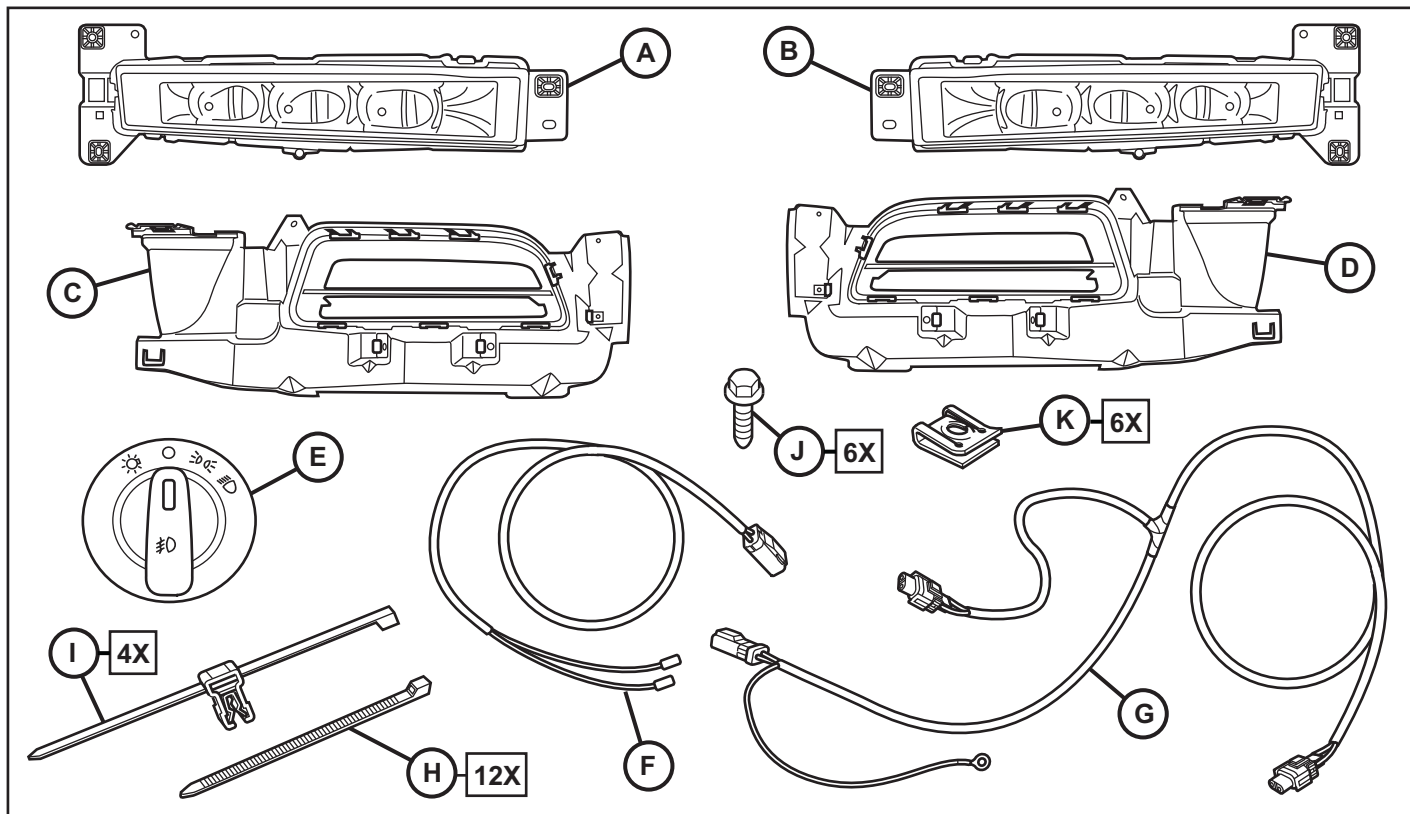

RETAIN ALL FASTENERS FOR REINSTALLATION
Maintenir toutes les vis pour la réinstallation
Mantenga todos los tornillos para la reinstalación

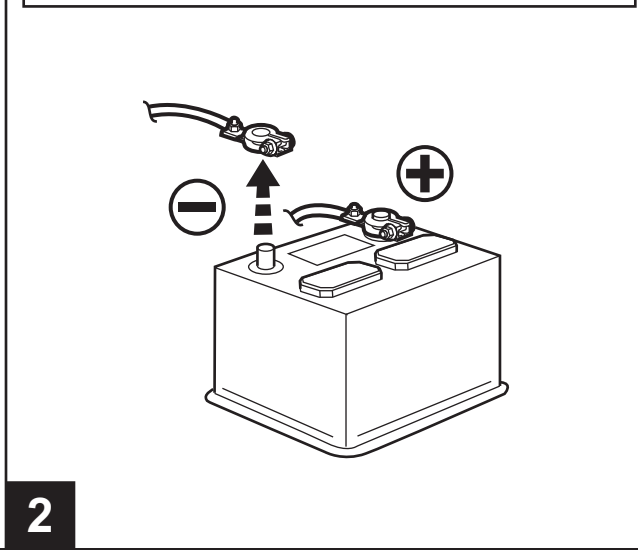

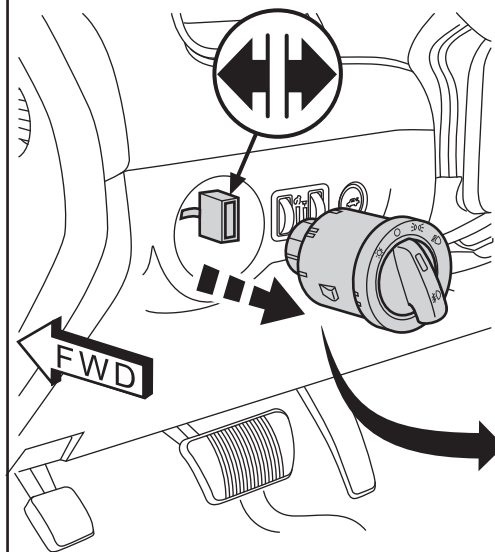

3

- 1) Turn the knob to the OFF position.
- 2) Push in on the knob to engage the retractor mechanism.
- 3) With the knob pushed in, rotate the knob clockwise (right) to retract the two retaining tabs.

- 1) Placez le commutateur à la position OFF.
- 2) Repoussez le bouton pour engager le mécanisme de retrait.
- 3) Dans cette position repoussée, tournez le bouton en sens horaire (vers la droite) pour dégager les languettes de retenue.

- 1) Gire la perilla a la posición apagada (OFF).
- 2) Presione la perilla para acoplar el mecanismo de retracción.
- 3) Cuando presione la perilla, gírela en el sentido de las manecillas del reloj (hacia la derecha) para retraer las dos lengüetas de retención.

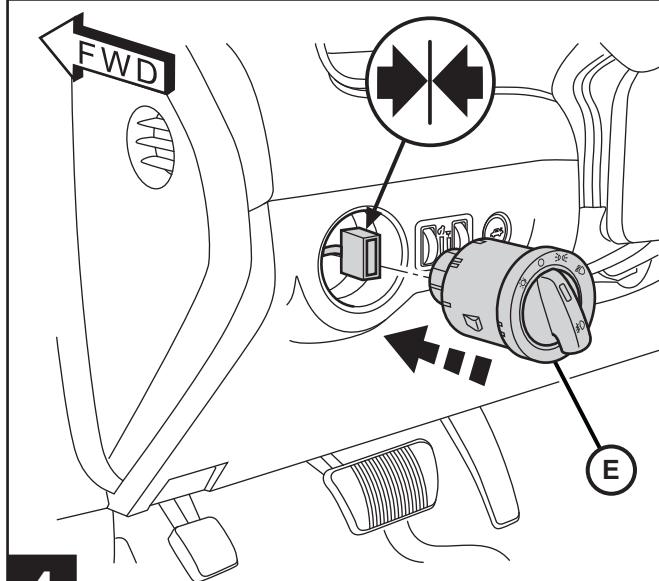
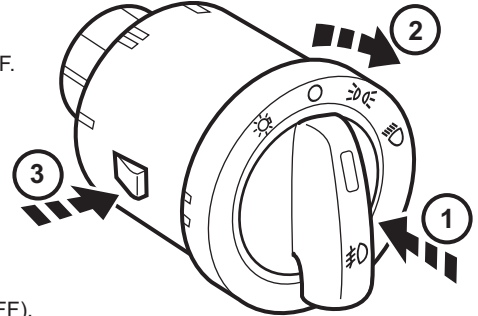

4

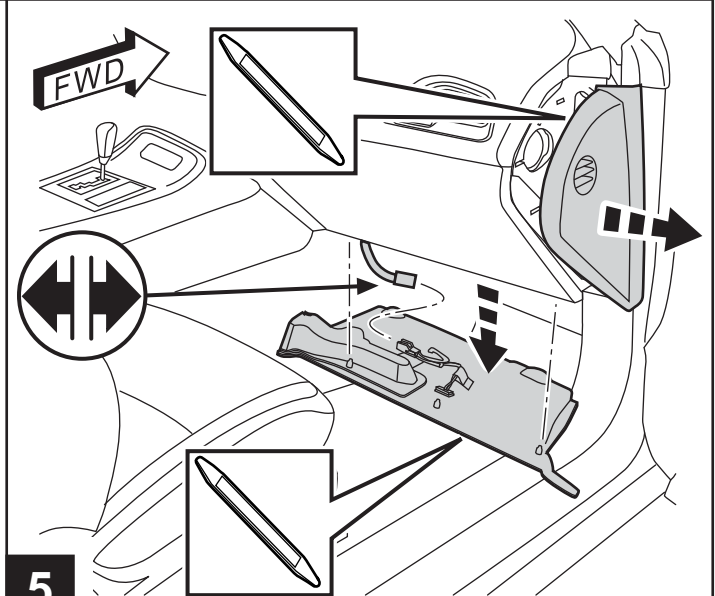

5

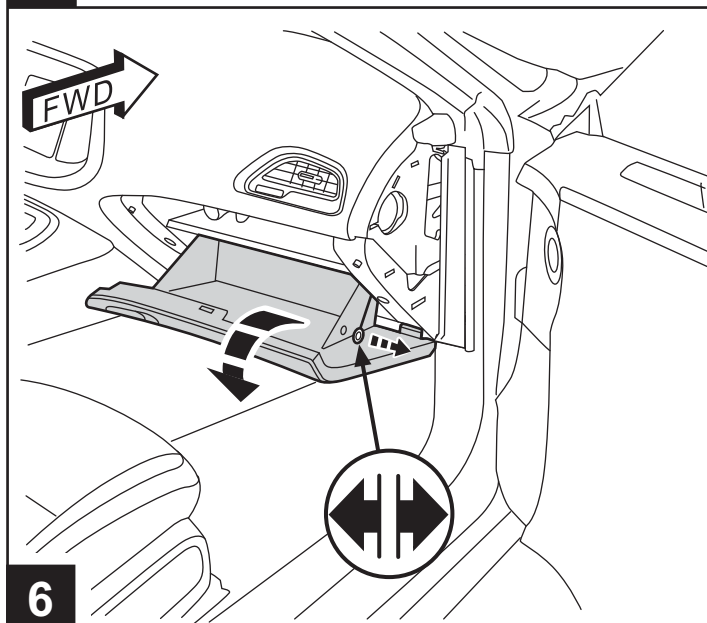

6

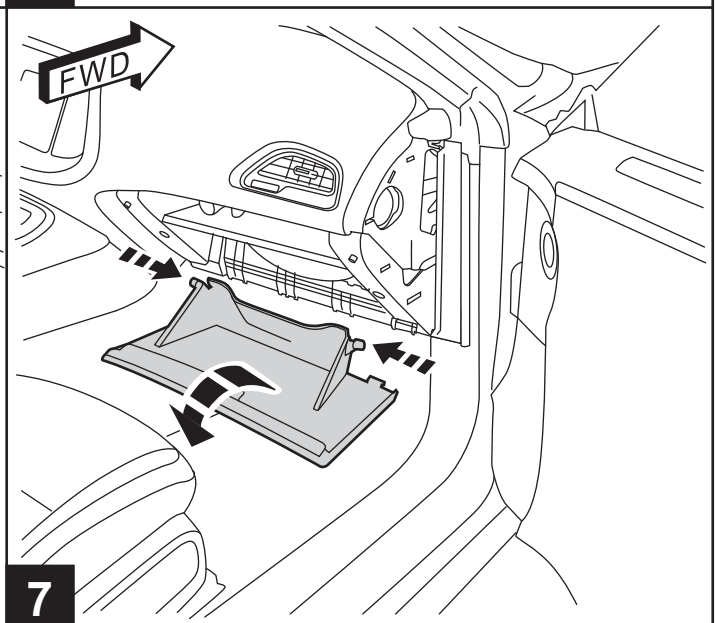

7

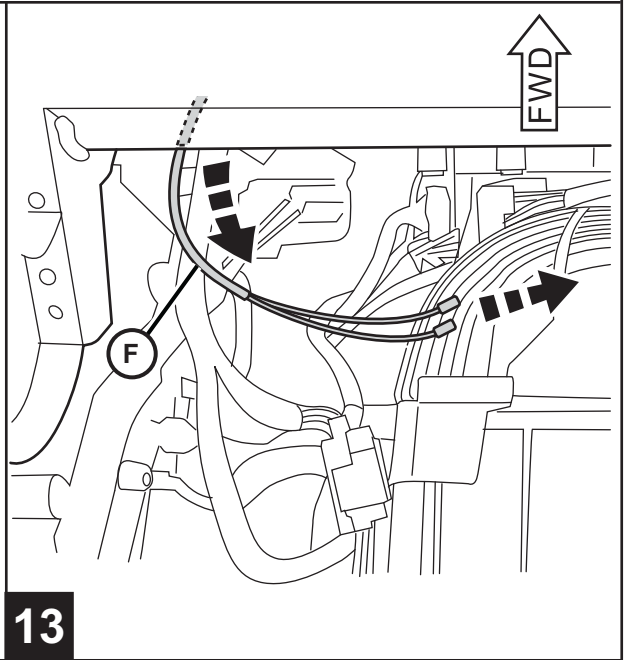
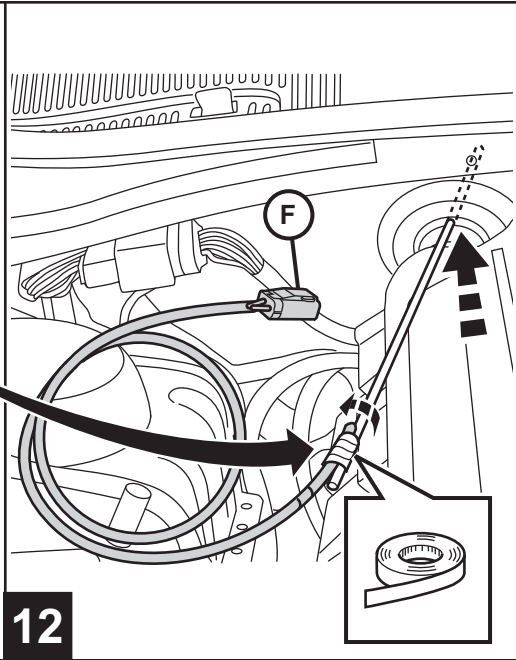
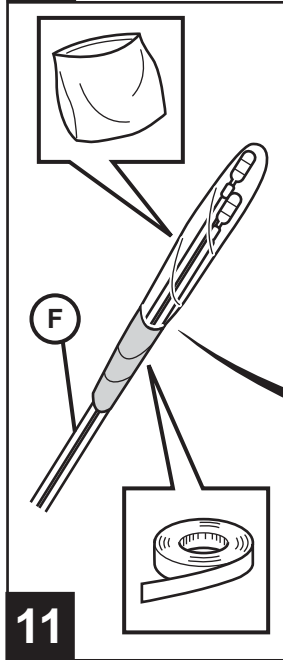
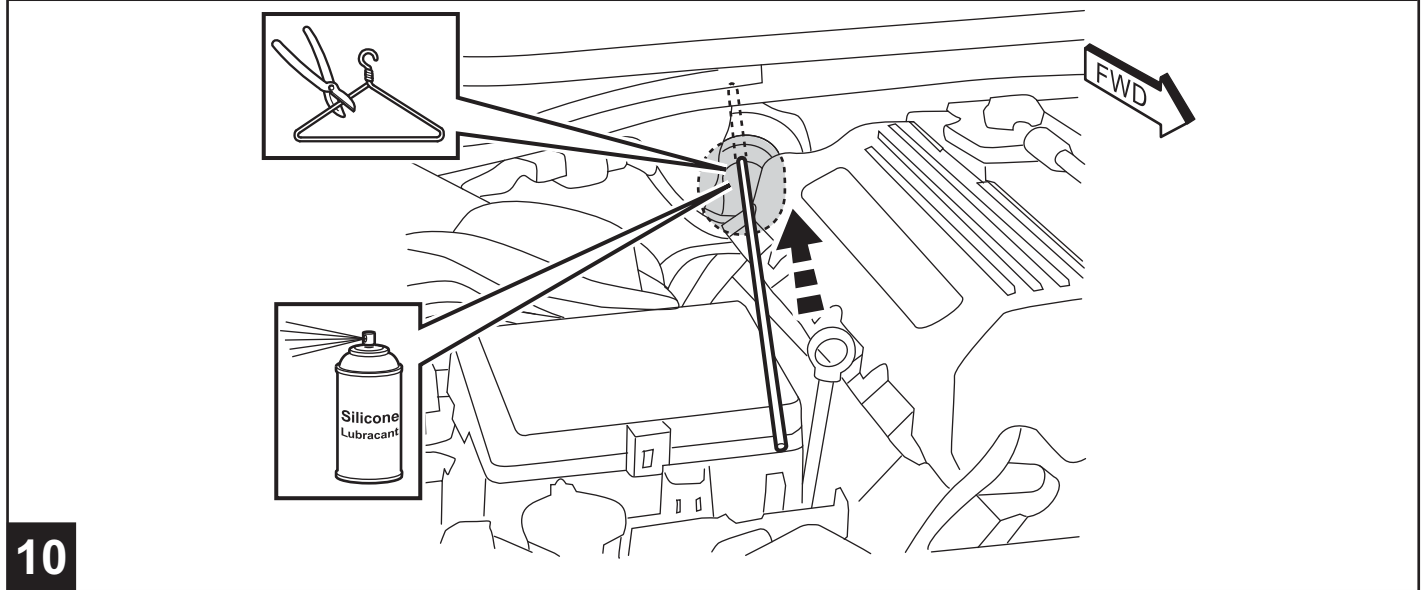
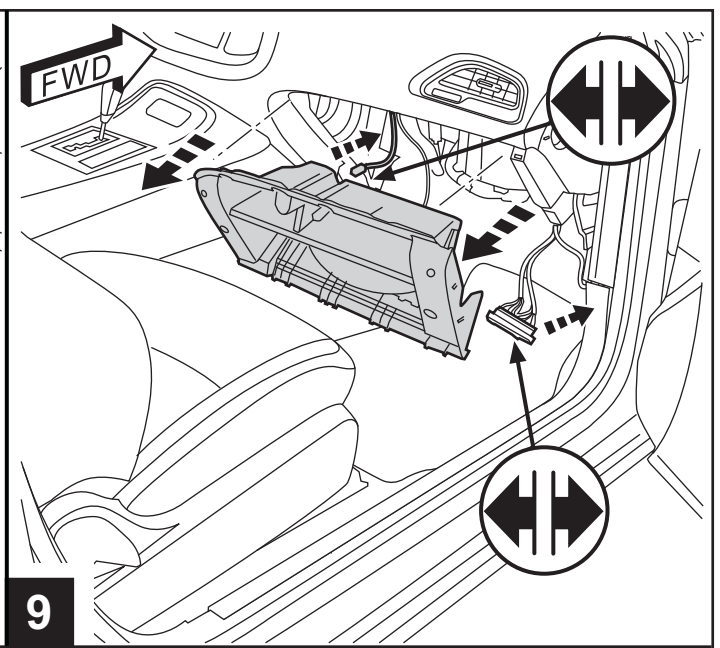
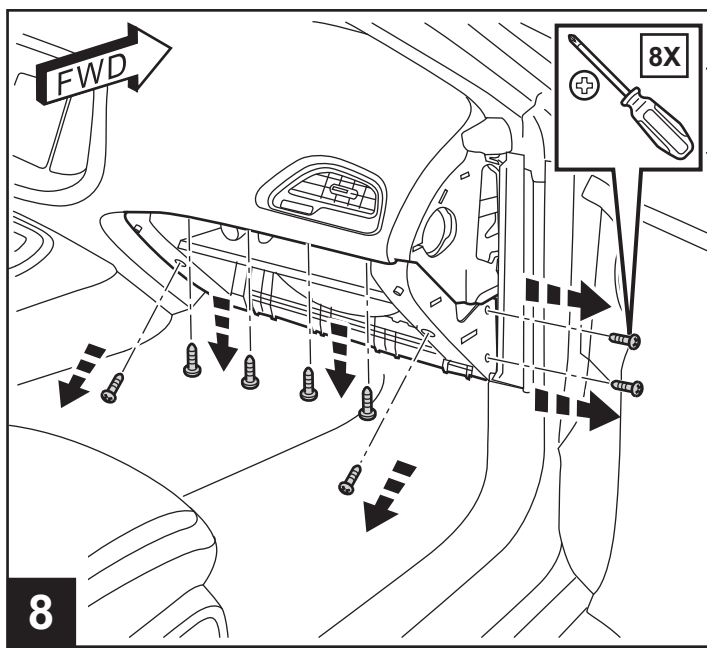

NOTE: PERFORM STEPS 14 THROUGH 16 ON ONE CONNECTOR AT A TIME TO AVOID CONFUSION

REMARQUE: Effectuer les étapes 14 à 16 sur un seul connecteur à la fois.
NOTA: Realice los pasos del 14 al 16 en un solo conector a la vez.

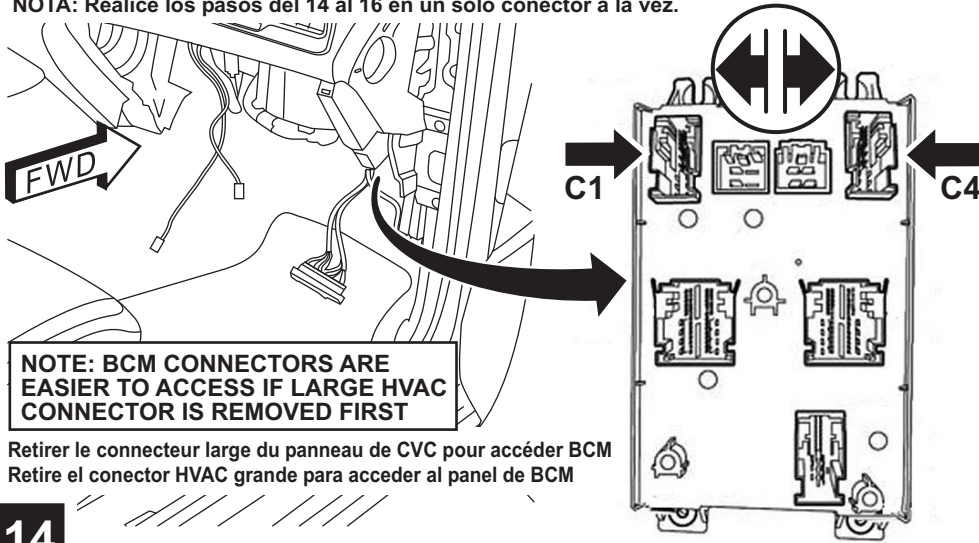

NOTE: BCM CONNECTORS ARE EASIER TO ACCESS IF LARGE HVAC CONNECTOR IS REMOVED FIRST

Retirer le connecteur large du panneau de CVC pour accéder BCM
 Retire el conector HVAC grande para acceder al panel de BCM

14

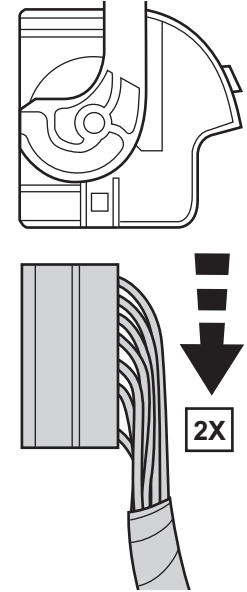

15

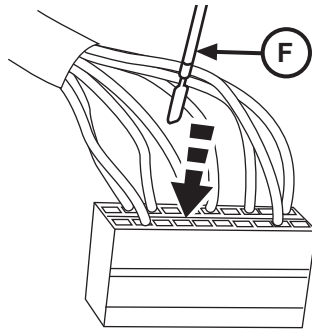

NOTE: Use 10300-9 Depopulate Tool or equivalent to remove wires.
REMARQUE: Utiliser l'outil pour enlever câblage
NOTA: Utilizar la herramienta para quitar el cableado

NOTE: If factory harness wire is present, remove wire and tape it back on the harness.

Si le câblage existant est présent, retirez-la et fixez-le avec du ruban adhésif.

Si el cableado existente está presente, retírelo y fíjarlo con cinta adhesiva.

16

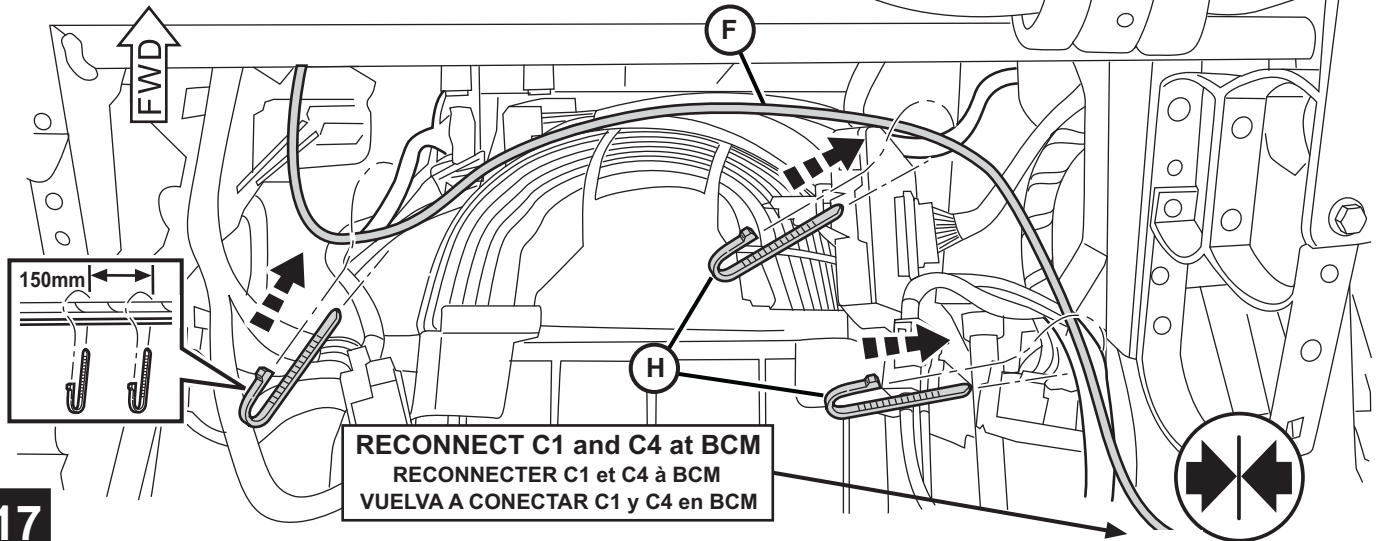
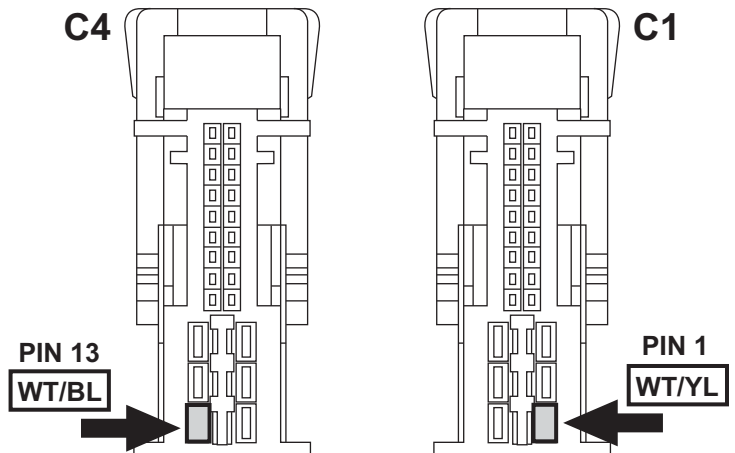

RECONNECT C1 and C4 at BCM
RECONNECTER C1 et C4 à BCM
VUELVA A CONECTAR C1 y C4 en BCM

17

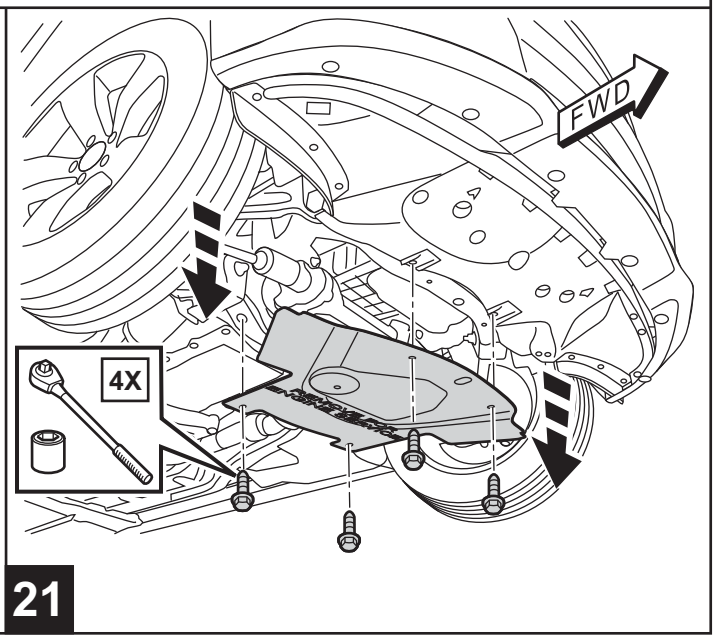
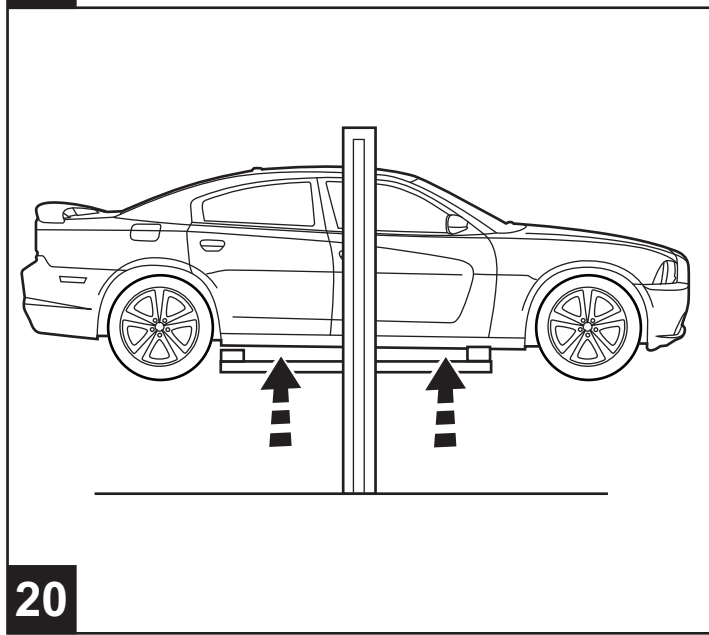
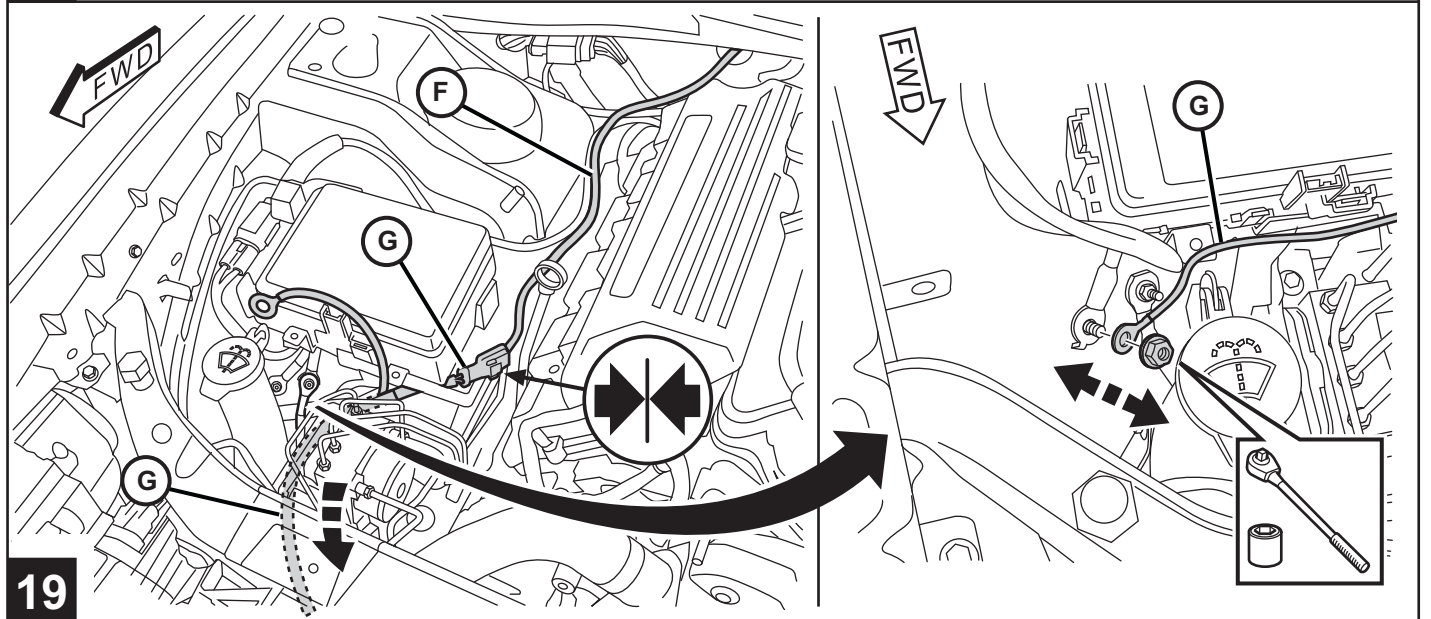
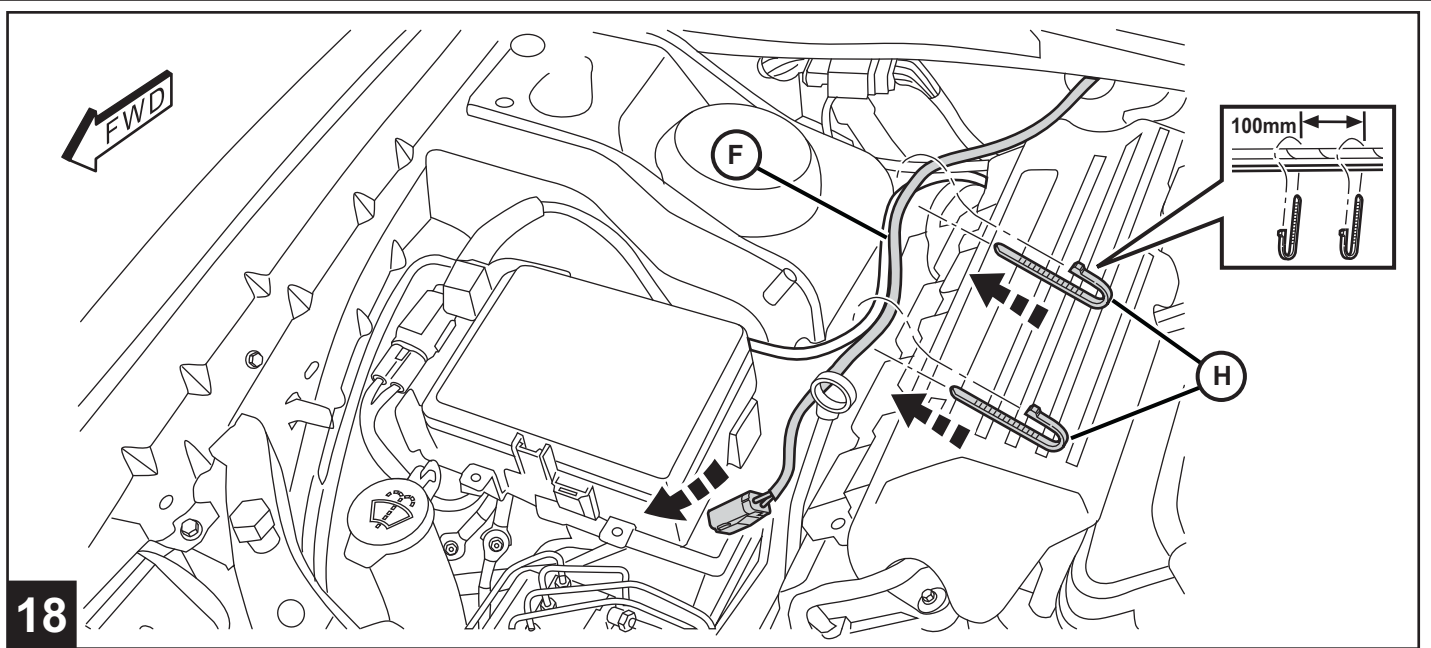

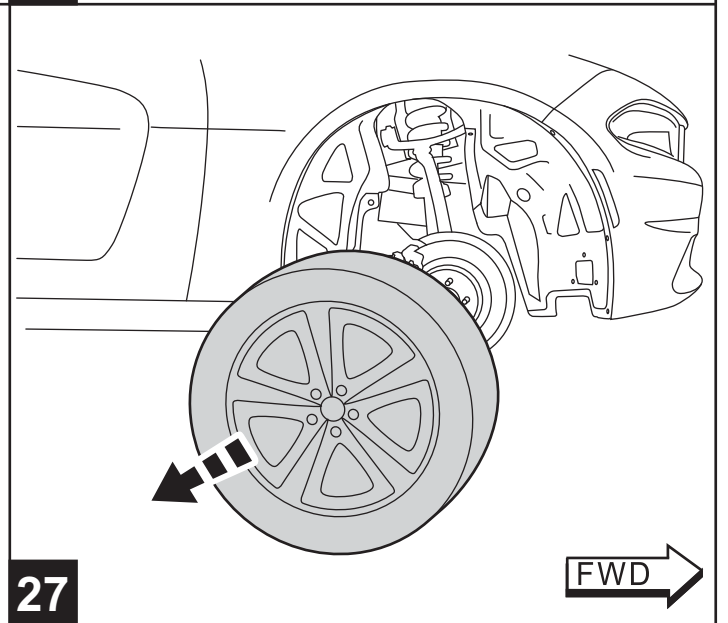
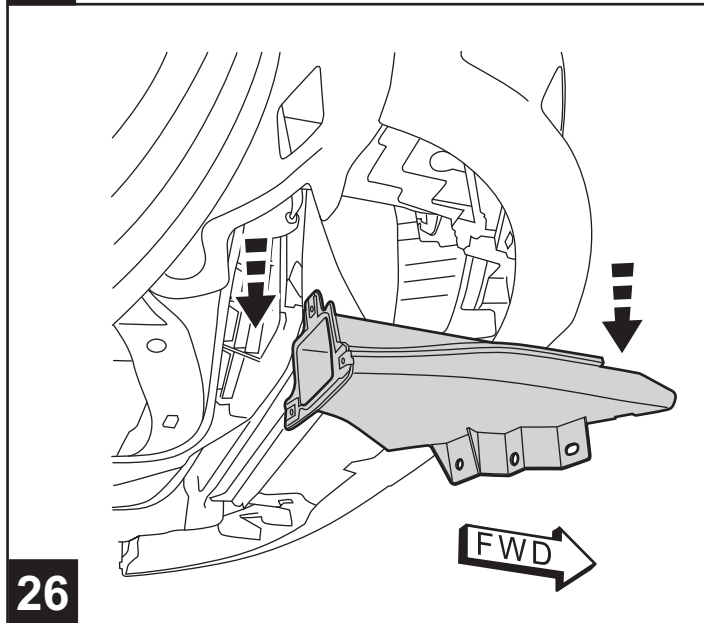
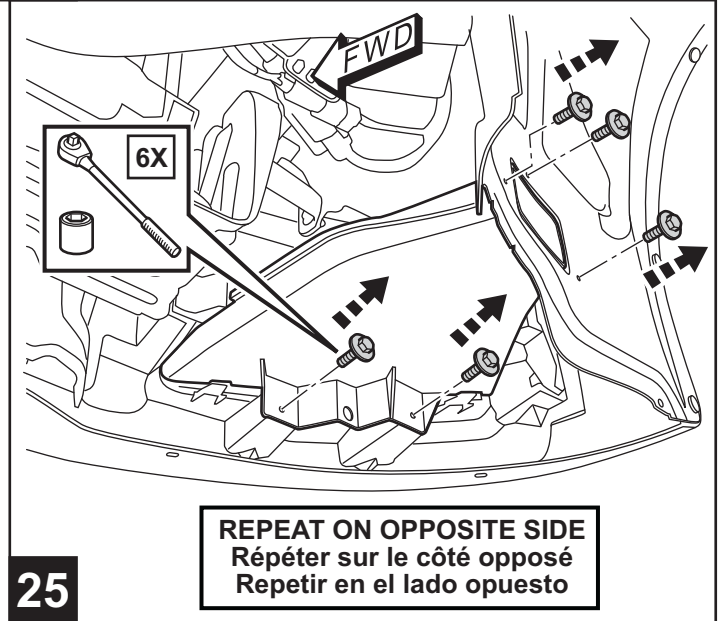
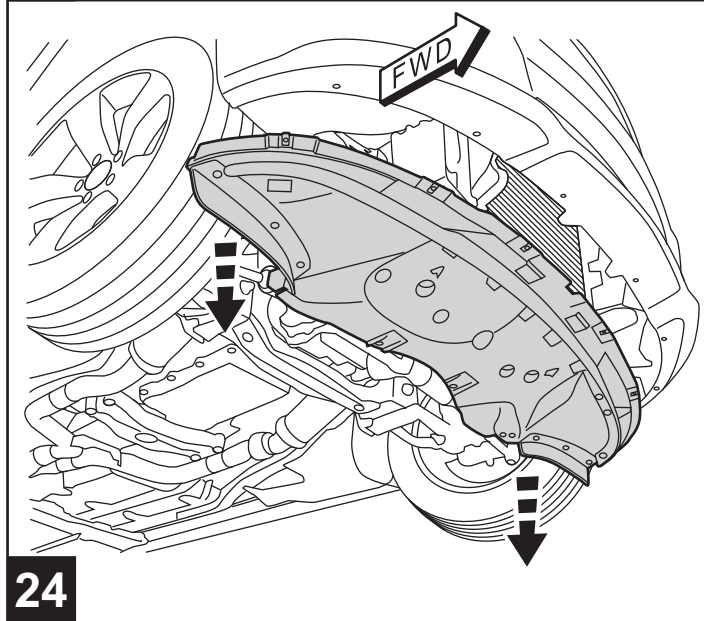
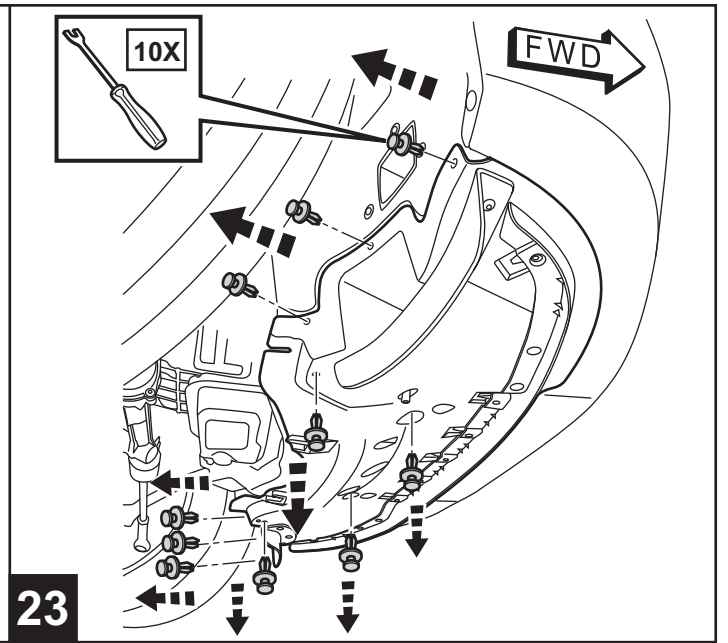
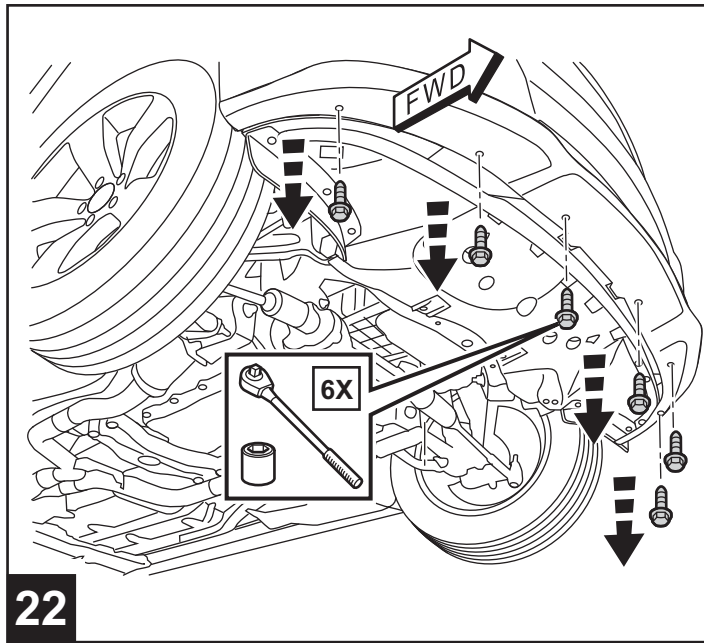

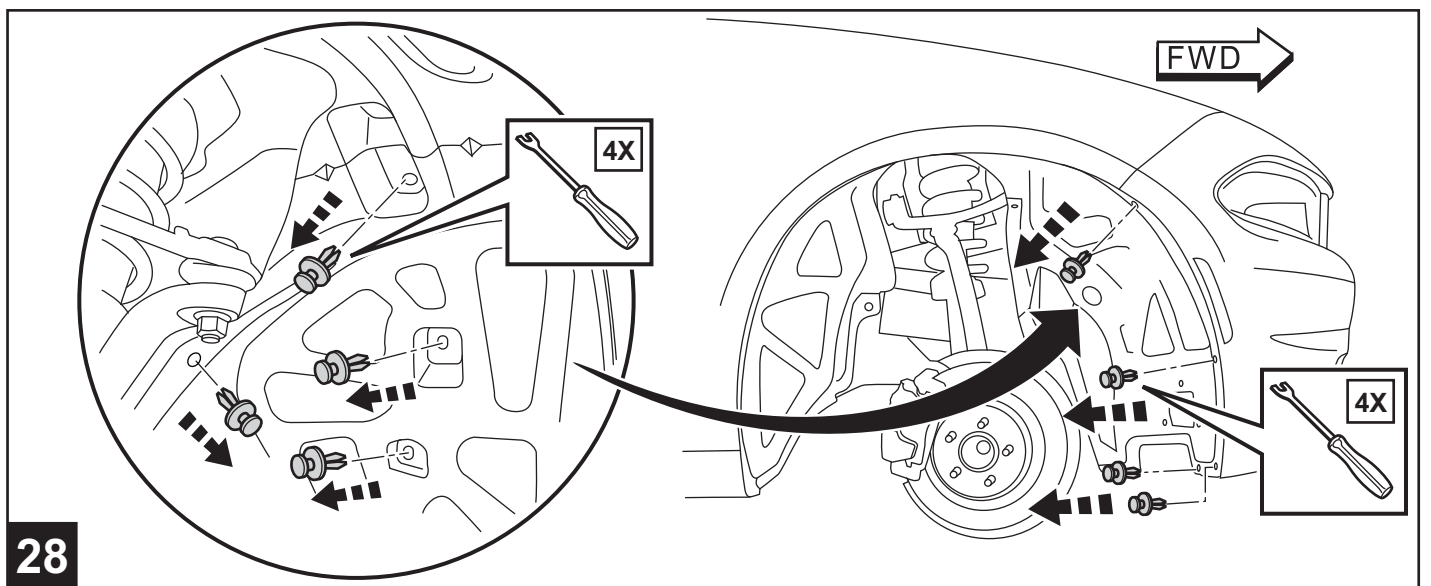

28

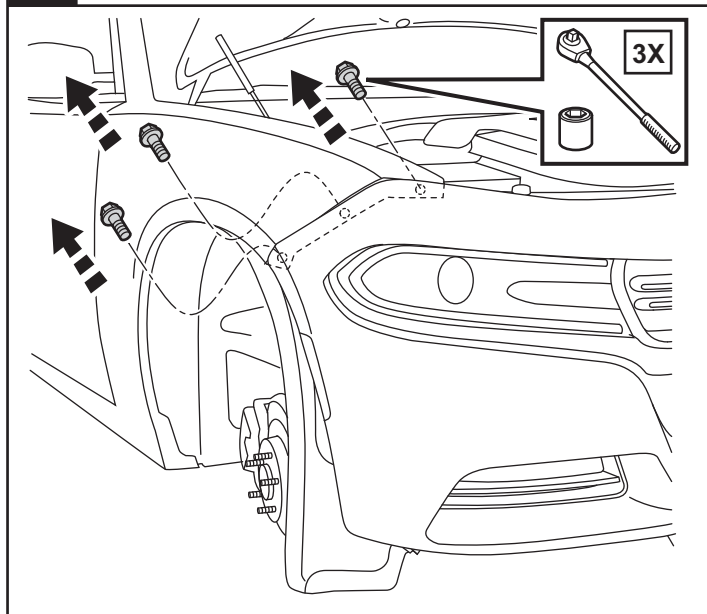

29

**REPEAT STEPS 27 THROUGH 30
ON OPPOSITE SIDE**
 Répétez les étapes 27 à 30 sur le côté opposé
 Repita los pasos del 27 al 30 en el lado opuesto

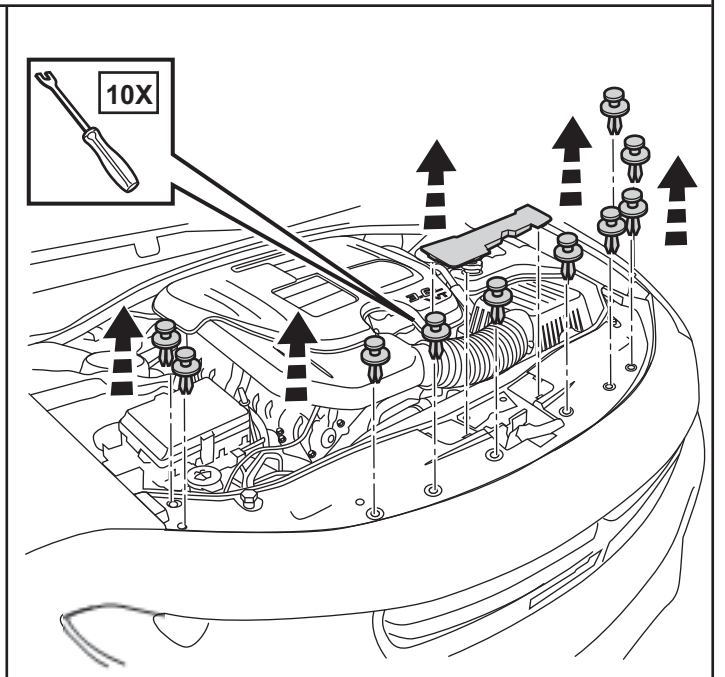

30

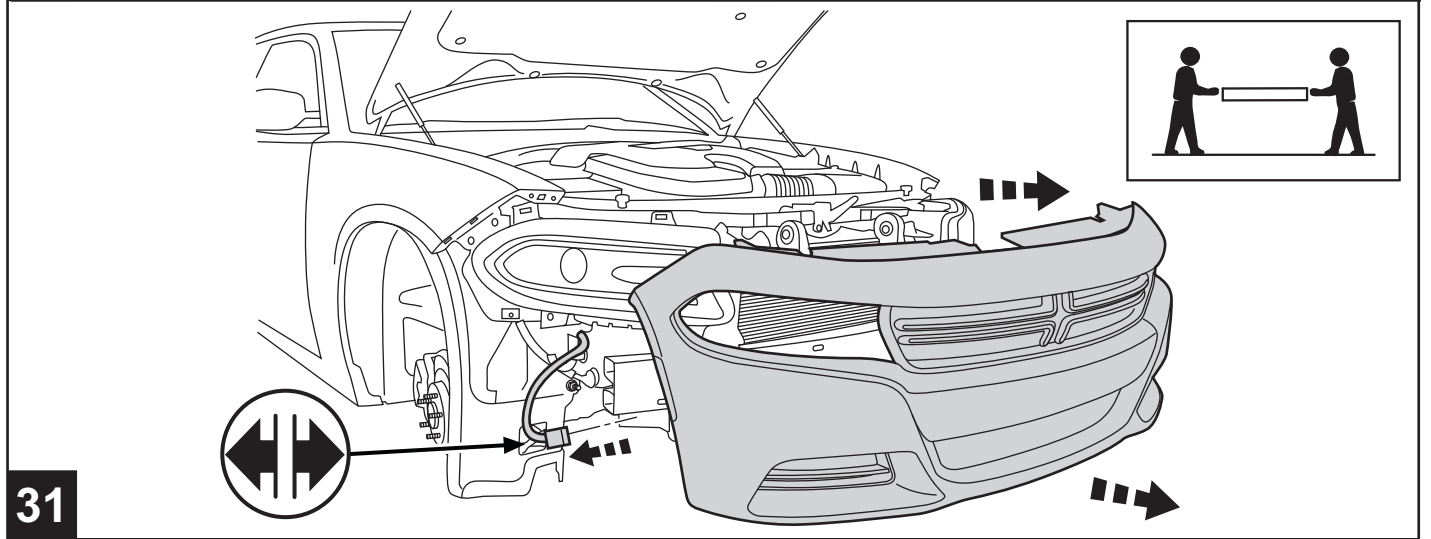

31

RE-USE FACTORY BOLTS AND CLIPS. IF LOST OR DAMAGED, USE PARTS (J) AND (K) PROVIDED IN KIT

Utilisez des boulons et des clips existants pour fixer de nouvelles pièces.
Si nécessaire, utiliser des pièces (J) et (K) fournis dans le kit.

Utilice los pernos y los clips existentes para fijar las piezas nuevas.
Si es necesario, utilice las piezas (J) y (K) en el kit.

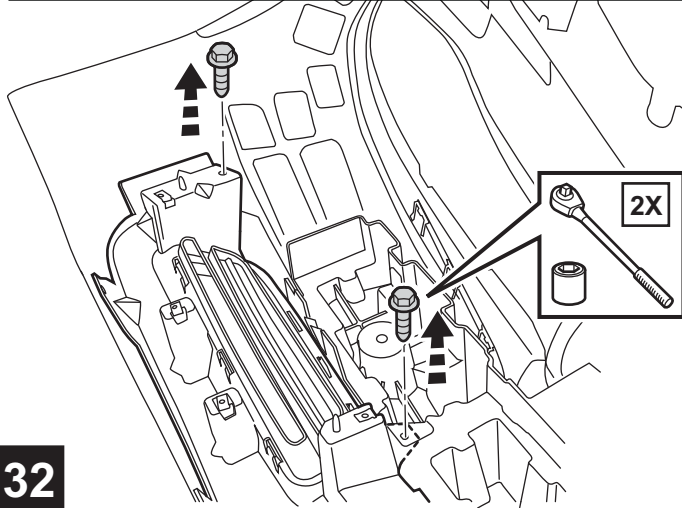

32

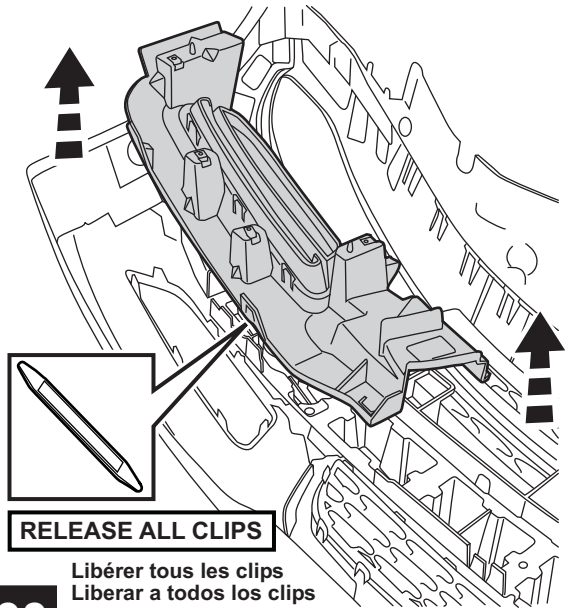

33

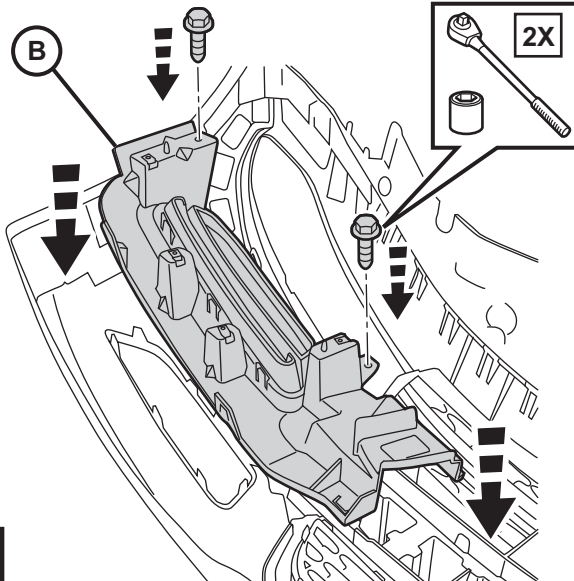

34

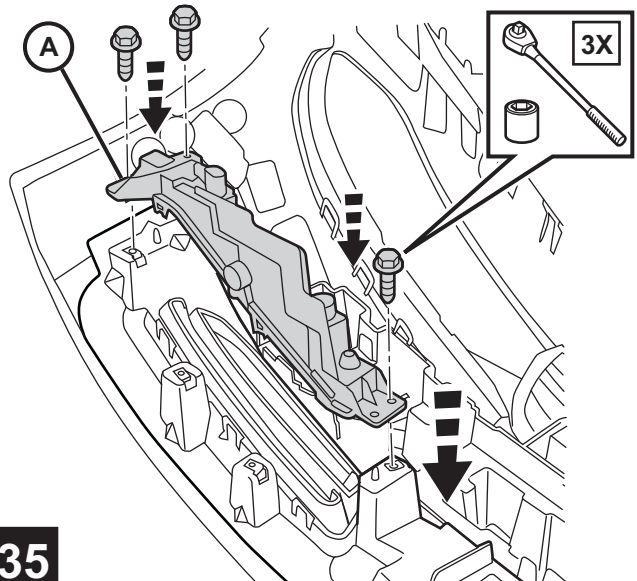

35

**REPEAT STEPS 33 THROUGH 36
ON OPPOSITE SIDE**

Répétez les étapes 33 à 36 sur le côté opposé

Repita los pasos del 33 al 36 en el lado opuesto

36

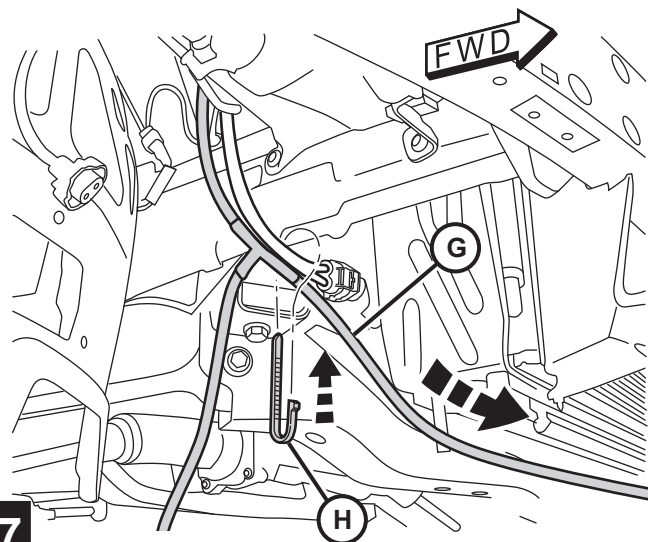

37

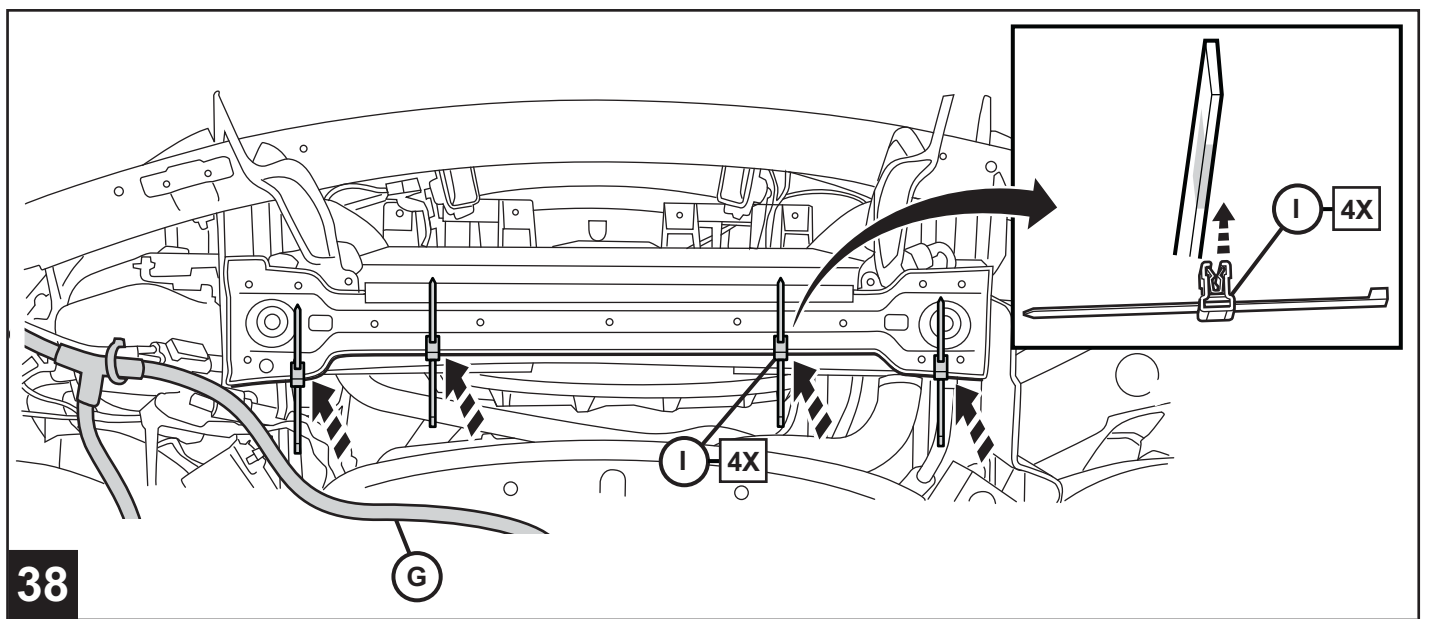

38

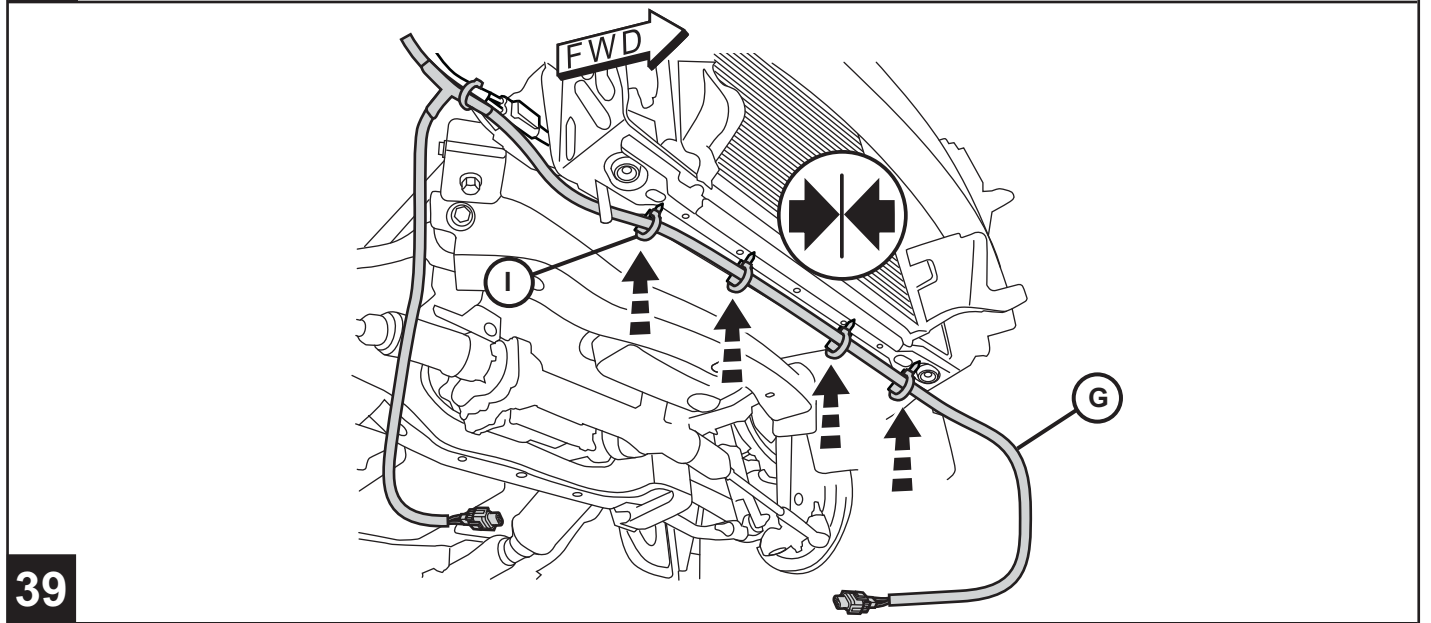

39

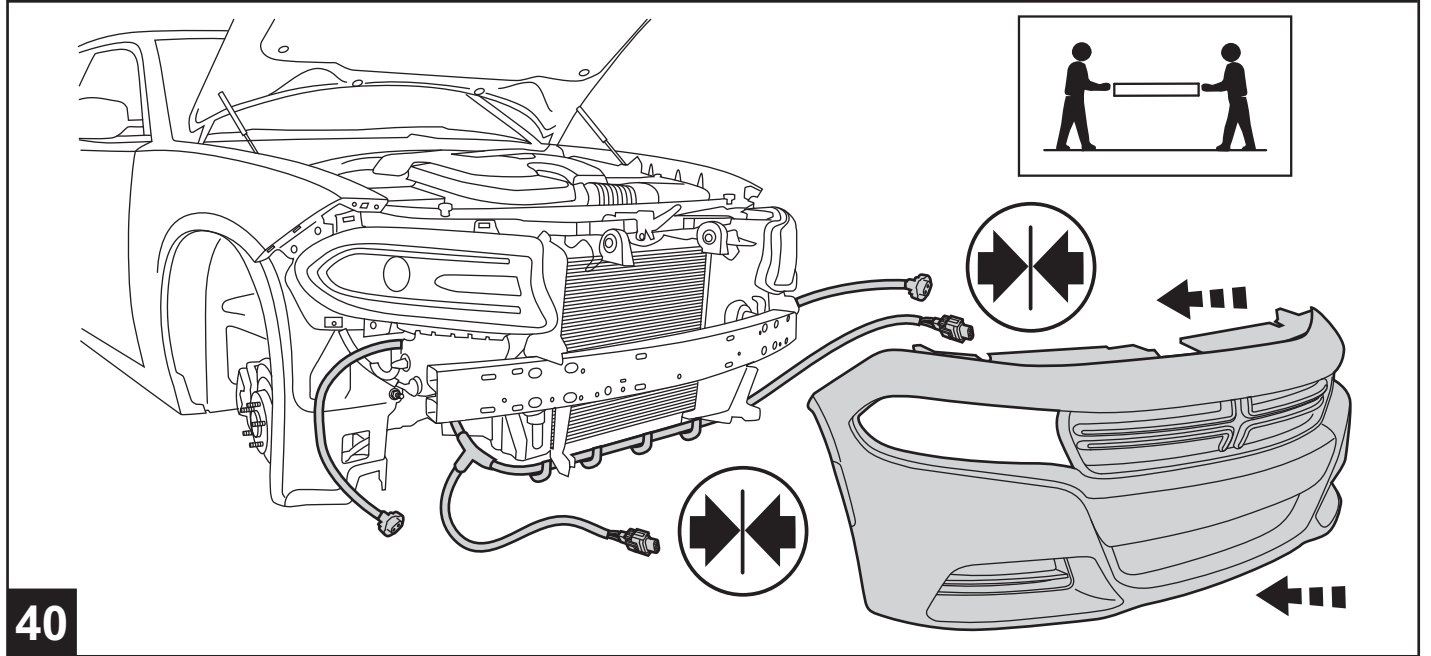

40

**REVERSE STEPS 21 THROUGH 31 AND STEPS 5 THROUGH 10
TO REINSTALL VEHICLE COMPONENTS AND TRIM PANELS.**

**Pour reposer les panneaux de garniture
et composants, inversez les étapes 21 à 31 et 5 à 10.**

**Invierta los pasos del 21 a través de 31 y 5 a través de 10
según sea necesario para instalar los paneles y los componentes.**

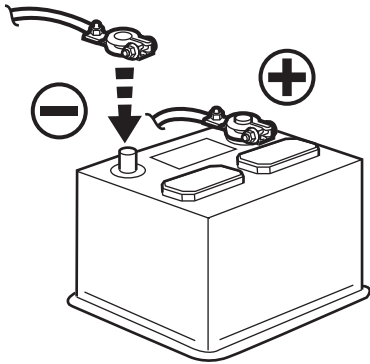
41

**FOLLOW THE BCM CONFIGURATION AND
FOG LAMP ALIGNMENT INSTRUCTIONS ON
THE NEXT PAGE.**

**Suivez les directives de configuration BCM
et d'alignement des phares antibrouillard
à la page suivante.**

**Siga las instrucciones de Configuración
del BCM y Alineamiento de la lámpara
de niebla en la siguiente página.**

42**43**

VEHICLE CONFIGURATION

Vehicle VIN must be updated with the sales code of the added accessory in order to enable system functionality. Using the DealerCONNECT website and the scan tool, complete the procedure below:

1. Log on to <https://dealerconnect.chrysler.com>

CONFIGURATION DU VÉHICULE

VIN d'un véhicule doit être mise à jour avec le des ventes code de l'accessoire ajoutée, afin de permettre la fonctionnalité du système. L'utilisation du site DealerCONNECT et l'outil d'analyse, compléter la procédure ci-dessous:

1. Connexion à <https://dealerconnect.chrysler.com>

CONFIGURACIÓN DEL VEHÍCULO

VIN del vehículo debe ser actualizado con el código de ventas de la del accesorio añadido con el fin de habilitar la funcionalidad de sistema de. Utilizando la página web DealerCONNECT y la herramienta de análisis, complete el procedimiento siguiente:

1. Inicie sesión en <https://dealerconnect.chrysler.com>

CHRYSLER
DEALERCONNECT

Welcome to DealerCONNECT

Access to Chrysler Group LLC's computer systems is controlled. UNAUTHORIZED ACCESS OR USE IS PROHIBITED. Authorized users are hereby informed that Chrysler Group LLC management may monitor this use and ensure compliance. Chrysler Group LLC may terminate access privileges, take DISCIPLINARY ACTION and/or institute civil or criminal proceedings to enforce this policy.

[Help with Password or Access](#)
[Site Status](#)
[Dealer Help Desk / Maintenance](#)
[Terms of Use](#)

User ID *

Password *

Dealer Code
OR
Dealership Name

* Required Field

Submit

Note:
If your User ID allows for multiple dealership access, enter the desired dealer code in the Dealer Code field.

CHRYSLER RAM DODGE JEEP SRT FIAT MOPAR MOPAR VEHICLE PROTECTION

Chrysler, Jeep, Dodge, RAM, SRT and Mopar and the Pentastar logo are registered trademarks of Chrysler Group LLC.
©2012 Chrysler Group LLC. FIAT is a registered trademark of Fiat Group Marketing & Corporate Communication S.p.A., used under license by Chrysler Group LLC.
Privacy Statement

2. In the service tab, inside the Warranty Administration box, locate "Vehicle Option Updates."

Enter the vehicle VIN and add the sales code LNV (LED Fog lights) as a "Dealer Installed Option".

2. Dans l'onglet de service, à l'intérieur de la Garantie Administration boîte, localiser " de Véhicules Option mises à jour."

Entrez dans le véhicule VIN et ajouter le code de vente LNV (LED Phares Anti-brouillard) comme une "option installés chez le concessionnaire".

2. En la pestaña de servicio, el interior de la caja de la Administración Garantía, localizar "Opción Vehículo actualizaciones."

Ingrese el VIN del vehículo y agregue el código de ventas LNV (LED Faros antiniebla) como una "opción instalada por el distribuidor".

The screenshot shows the Mopar DealerCONNECT website interface. The top navigation bar includes links for HOME, SALES, SERVICE CONTRACTS, SERVICE, PARTS, MARKETING, NETWORK, TRAINING, and FIAT. The 'SERVICE' tab is selected. The main content area is divided into several sections:

- ANNOUNCEMENTS:** Features a CNG Opportunity announcement and a Dealer Rewards brochure link.
- VEHICLE INFORMATION PLUS (VIP):** Lists links for Single VIN Inquiry, Multiple VIN Inquiry, LPLW 5-Year Powertrain Inspection Worksheet, and wIADVISOR (Service Write-up).
- SERVICE MARKETING:** Lists links for On Demand Service Prospector, Program Administration, Local Internet Search Reports, Recall Support Information, eScheduling, and Credit Card Central.
- PUBLICATIONS:** Lists links for ePublishing, Tech Authority, Certified / Trained HEV Dealers, and Service Quality Process Manual.
- SERVICE TOOLS & EQUIPMENT:** Lists links for wTECH Information and The Process Manager.
- CLAIM ADMINISTRATION:** Lists links for Claim Entry, Claim Acknowledgement, Chargebacks, Servicenet, and Labor Operations.
- WARRANTY ADMINISTRATION:** This section is highlighted with a white box and a black arrow. It contains:
 - Pre-Authorization Programs
 - Repair Pre-Authorization LOP Checker (with a sub-link: To verify if a LOP is part of the Pre-Authorization Program - Click Here)
 - Digital Imaging
 - Powertrain Service Center
 - Submission Related Issues / Q & A
 - Reports, Tools & Information
 - Dealer Service Profile
 - Dealer TASC
 - DWIN - POPPS Report
 - DWIN - POPPS Dealer Guide
 - Market Coverage Change
 - Vehicle Option Updates (highlighted with a white box and a black arrow)
 - Dealer Policy Manual
 - Warranty Administration Manual
 - Warranty Information Center (WIC)

The bottom of the page shows a status bar with "Local intranet | Protected Mode: Off" and a zoom level of 100%.

Vehicle Option-Add a Sales Code

VIN:

* - Required Field

VIN: 2C3CDYAG1EH100143 Warranty Coverage Code: 62 Current Odometer: 0 Miles
Year/Model: 2014 DODGE CHALLENGER TWO-DOOR HARDTOP In Service Date: May 15, 2013

Dealer Installed Vehicle Options

Body Style: LCDH22 Build Date: May 11, 2013 Hour: 23
Color 1: PSC - Billet Silver Metallic Clear Coat
Color 2: QSCS - Billet Silver Metallic Clear Coat

Available Vehicle Option

- 2M2 U-CONNECT WEB
- 2R2 DOOR SILL GUARDS
- 2R5 EVTS ELECTRONIC VEHICLE TRACKING
- 44R Mopar Chrome Grill Insert
- 4AZ MASTERSHIELD LEATHER PROTECT
- 4L2 MASTERSHIELD UNDERCOATING
- 4LB MOPAR MASTERSHIELD PAINT SEALANT
- 4LE MASTERSHIELD PAINT PROTECTOR
- 4LL MASTERSHIELD FABRIC PROTECTOR

Selected Vehicle Option

Choose a sales code from the list

3. Confirm that the new sales code has been successfully added to the VIN.
3. Assurez-vous que le nouveau code de vente a été ajouté avec succès à la VIN.
3. Confirme que el nuevo código de las ventas ha sido agregado con éxito a la VIN.

4. Using the scan tool select the VEHICLE PREPARATION and then select RESTORE VEHICLE CONFIGURATION.
4. Utilisation de l'outil d'analyse de sélectionner la PRÉPARATION DU VÉHICULE et puis sélectionnez Restaurer CONFIGURATION DU VÉHICULE
4. El uso de la herramienta de análisis, seleccione la VEHÍCULO PREPARACIÓN y a continuación, seleccione Restaurar CONFIGURACIÓN DEL VEHÍCULO.

2009 JK 3.8L
VIN: 1J8GA69199L733209
Battery: 12.17 volts

Legend

- Active ECU
- Non-responsive ECU
- DTCs Present
- ECU Not Built
- Scanning ECU
- New Flash Available
- Diag CAN-C
- CAN-C
- CAN-IHS

ECU	Name
WCM	Program Ignition Keys or Key FOBs
TIPMCGW	Program Network Configuration
TIPMCGW	Restore Vehicle Configuration

5. Follow the step by step instructions on the scan tool to complete the restore vehicle configuration.
5. Suivez les instructions étape par étape sur l'outil d'analyse pour compléter la configuration du véhicule restauration
5. Siga la instrucciones paso a paso en la herramienta de análisis para completar la restauración de la configuración del vehículo.