

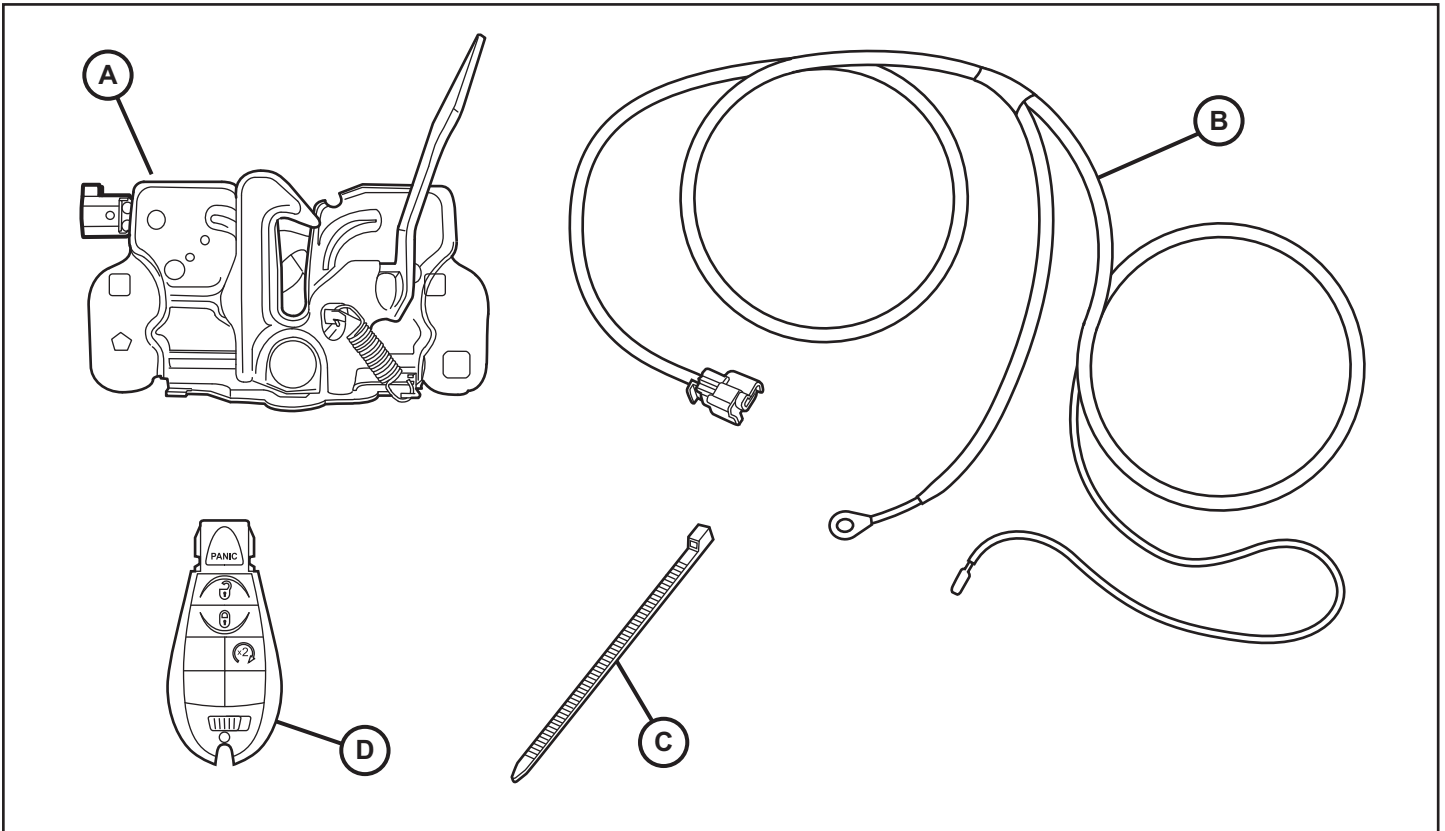

RAM REMOTE START

www.mopar.com



CALL OUT	DESCRIPTION	QUANTITY
A	Hood Latch Assembly	1
B	Hood Switch Harness	1
C	Cable Tie	10
D	Ignition Keyfob	2

TOOLS REQUIRED				
Socket Wrench	Metric Socket Set	Phillips Screwdriver	Trim Stick	
Torx Driver Bits	Tape	Wire Cutters	RTV Sealant	Pry Tool

NOTE: IT IS RECOMMENDED TO READ THE INSTRUCTIONS THOROUGHLY BEFORE INSTALLING THIS ACCESSORY.

CAUTION: XBM remote start can ONLY be installed on vehicles that have the following factory options: Automatic Transmission, Remote Keyless Entry and Immobilizer.

ADD SALES CODE TO VEHICLE IN DealerCONNECT. Obtain 4-digit PIN number from authorized dealership personnel.

NOTE: Vehicle VIN must be updated with the sales code of the added accessory in order to enable system functionality. Using the DealerCONNECT web site and the scan tool, complete the procedure below:

1. Log on to <https://dealerconnect.chrysler.com>.
2. In the "Service tab"- "Warranty Administration" box -"Vehicle Option Updates" screen, enter the vehicle VIN and add the sales code XBM (Remote start) as a "Dealer Installed Option".
3. Confirm that the new sales code has been successfully added to the VIN.

NOTE: The wiTECH software level must be at the latest release to perform this procedure. Check vehicle for fault codes before installation and clear or repair as needed.

1. With the WiTech tool connected to both the internet and the vehicle, follow the steps below:
2. Place the ignition into the run position.
3. Select the "Restore Vehicle Configuration" under the vehicle Preparations menu and follow the WiTech directions.

PROCEDURE STEPS:

WARNING: To avoid serious or fatal injury on vehicles equipped with airbags, disable the Supplemental Restraint System (SRS) before attempting any steering wheel, steering column, airbag, seat belt tensioner, impact sensor or instrument panel component diagnosis or service. Disconnect and isolate the battery negative (ground) cable, then wait two minutes for the system capacitor to discharge before performing further diagnosis or service. This is the only sure way to disable the SRS. Failure to take the proper precautions could result in accidental airbag deployment.

1. Loosen one (1) 10mm bolt and disconnect negative battery cable

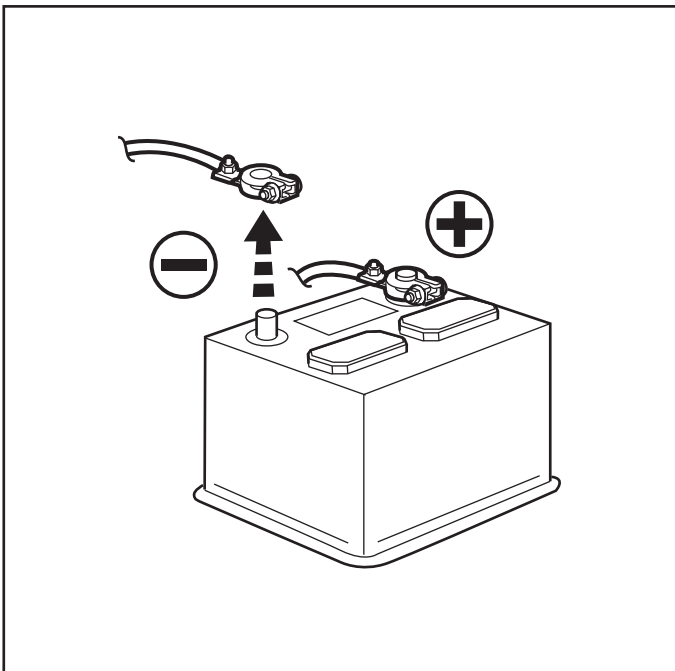

2. Open hood. Carefully pry off six (6) panel clips from the radiator cover panel. Remove the panel.

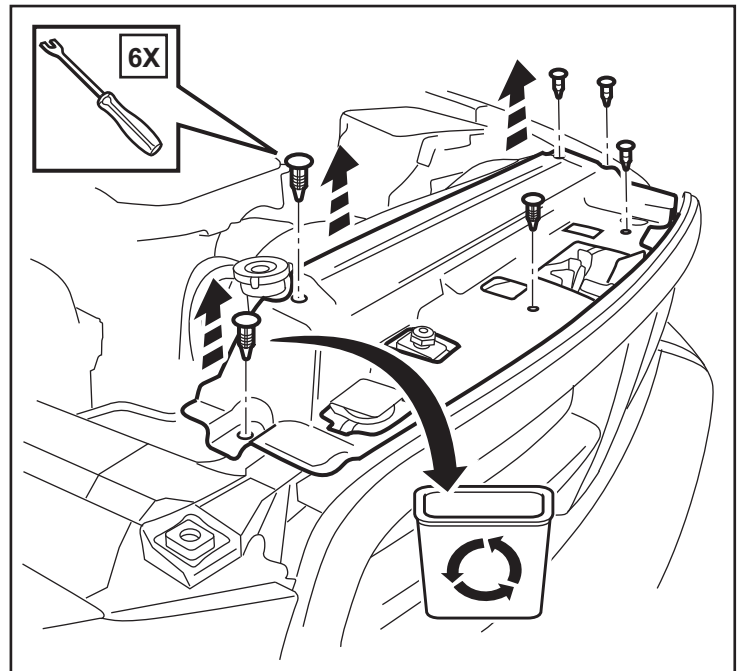

3. Use a grease pencil to mark the position of the hood latch on the radiator cross member. Remove two (2) 10mm hex bolts from the hood latch assembly.

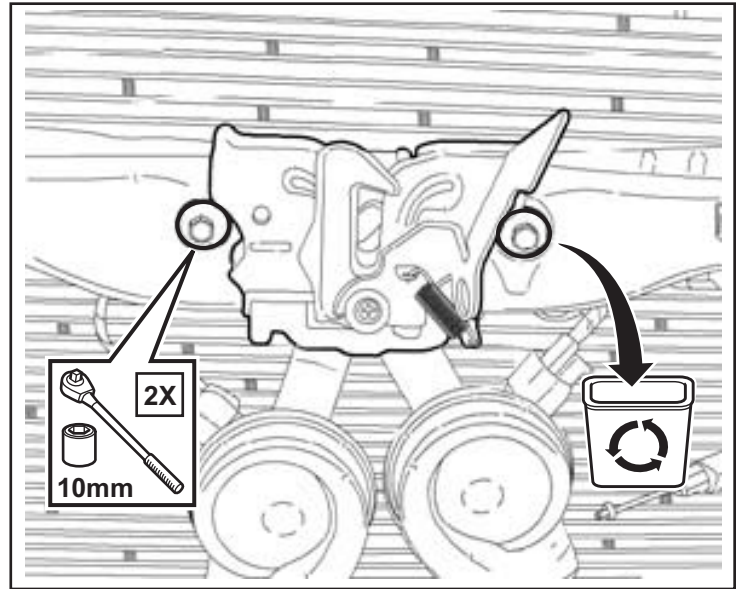

4. Disconnect and remove the hood latch release cable. Remove the hood latch assembly.

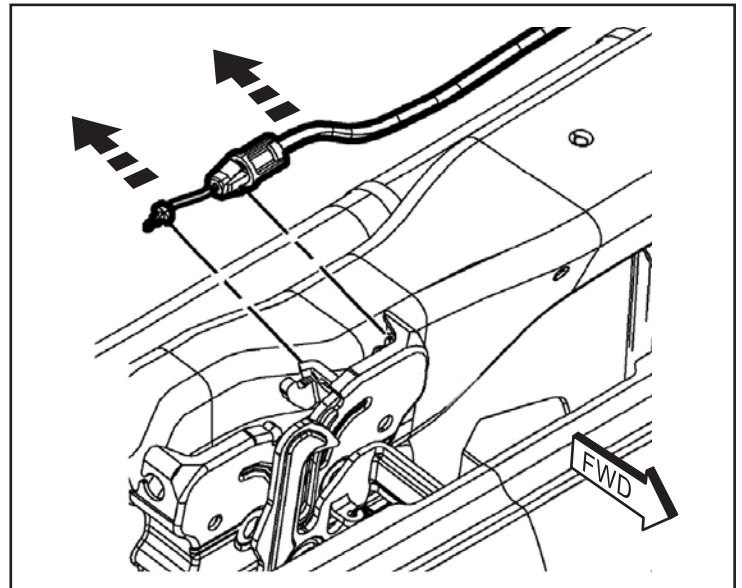

5. Reconnect the hood latch release cable to the back of new hood latch assembly. Position the new hood latch (A) with the alignment marks and secure with two (2) hex bolts. Tighten bolts to 11 Nm (8 ft. lbs.)

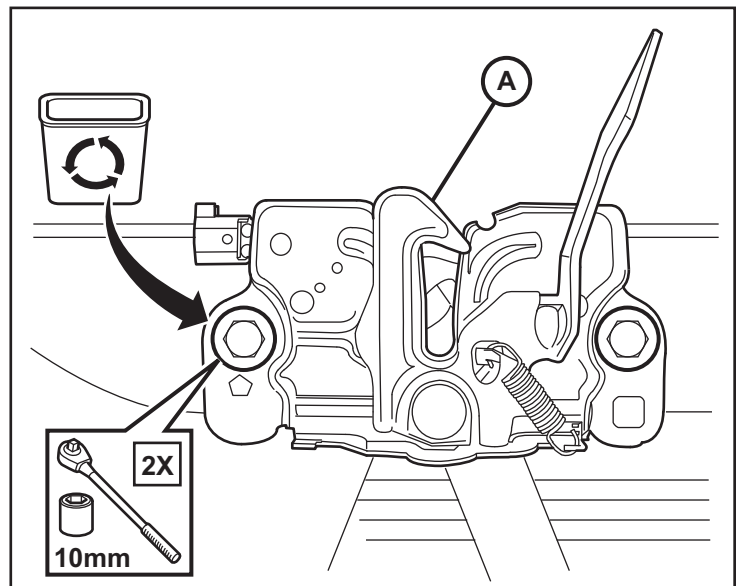

6. Connect hood switch harness (B) to the hood latch assembly.

NOTE: If a factory installed switch harness is present, DO NOT USE. Remote Start System may fail to operate correctly.

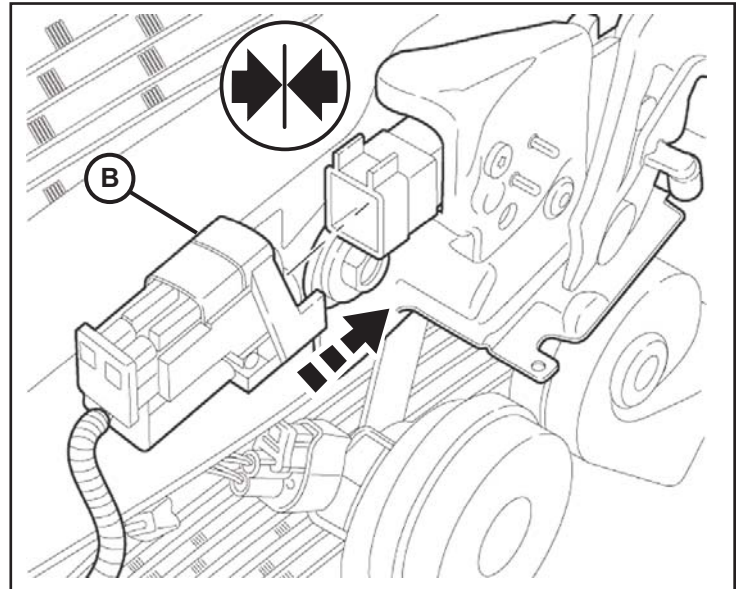

7. Route the switch harness (B) under the upper radiator crossmember and over towards the driver side along the existing vehicle harness. Secure with cable ties (E).

NOTE: Cable ties should be installed no farther than 100mm apart.

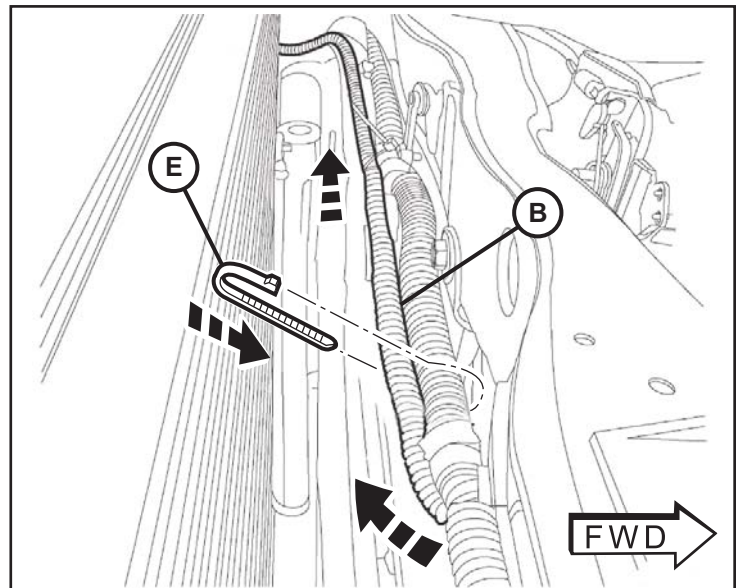

8. Route the switch harness (B) under the driver side radiator mounting bracket. Carefully feed the harness back towards the rear of the engine compartment by routing it behind and under the fuse box and the battery. **Secure with cable ties every 100mm as necessary (E).**

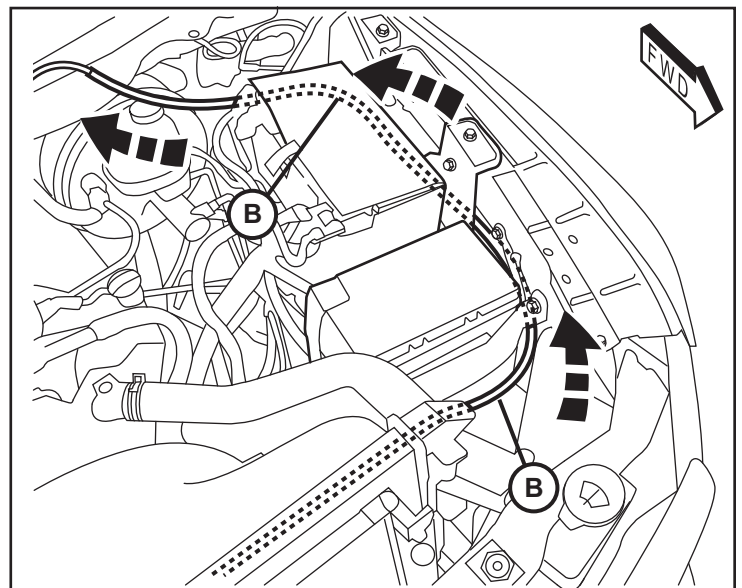

9. At the fender edge next to the battery, remove the existing ground wire hex nut. Position the ground ring terminal from the main harness (B) and reattach the nut to secure.

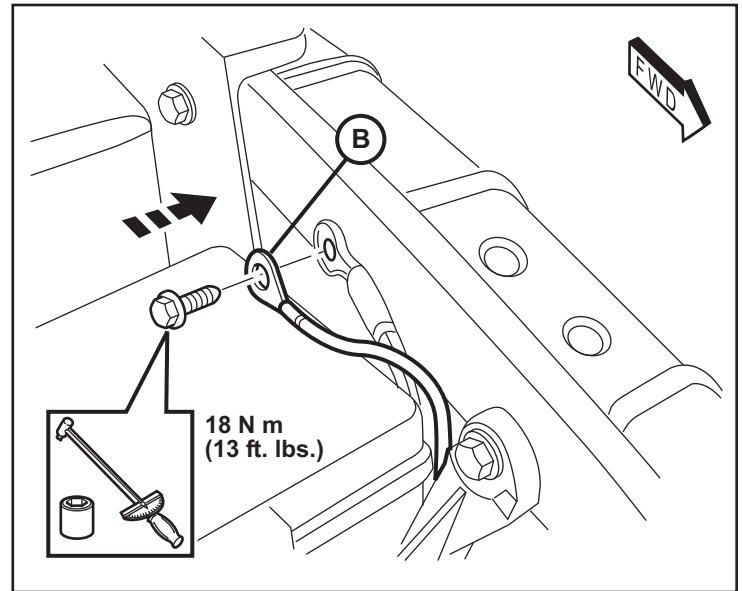

10. Locate the rubber grommet at the back of the engine compartment. Cut away the end of the access nipple and feed the end of harness (B) through to the inside driver footwell. Apply RTV sealant to the hood switch wiring convolute and pull the wiring into the nipple to seal the wiring at the nipple.

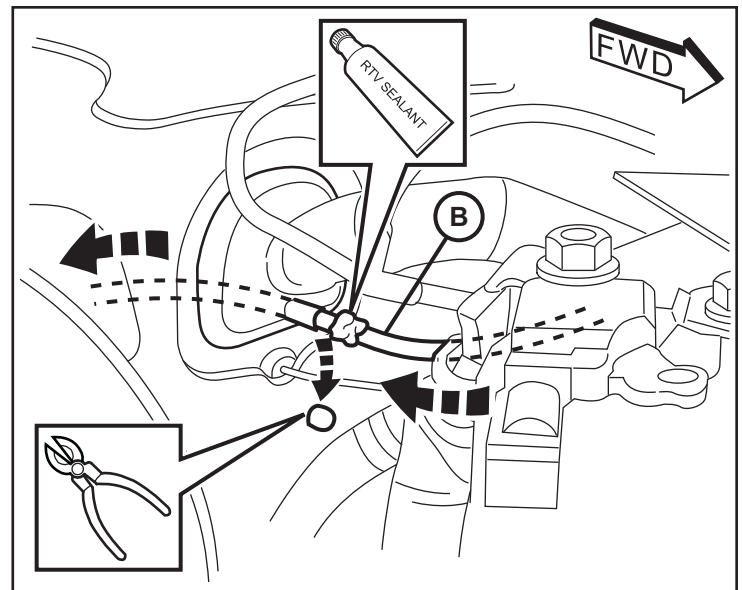

11. Remove two fasteners at the bottom of the trim panel under the steering wheel and carefully pry off the hood release latch. Disconnect the data link connector and pry off the trim panel. Pull the Switch Harness (B) through to the inside footwell.

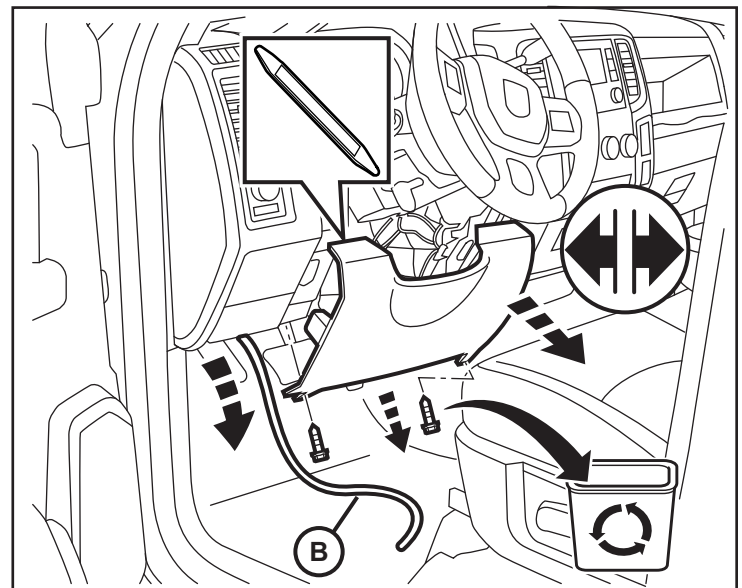

NOTE: VEHICLE MAY BE EQUIPPED WITH AN AUDIO AMPLIFIER MOUNTED IN FRONT OF THE BCM. THIS MUST BE REMOVED TO ALLOW ACCESS TO THE BCM.

12. Disconnect two (2) wire harness plugs from the bottom of the amplifier.

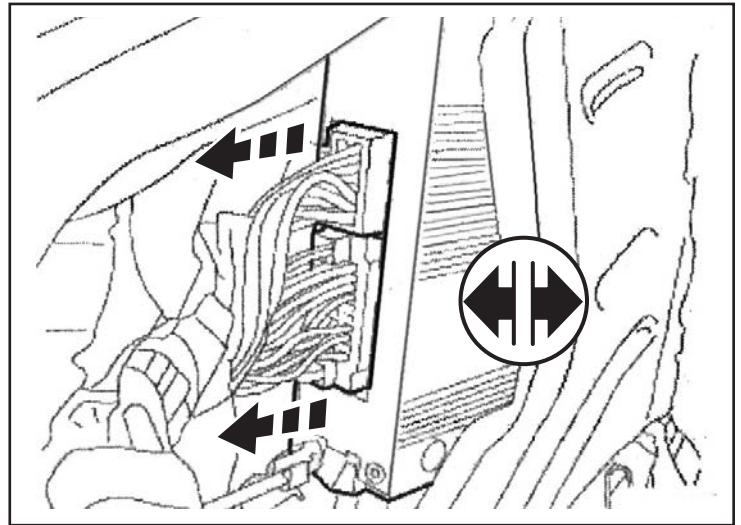

13. Loosen the two (2) 7mm amplifier bracket mounting screws.

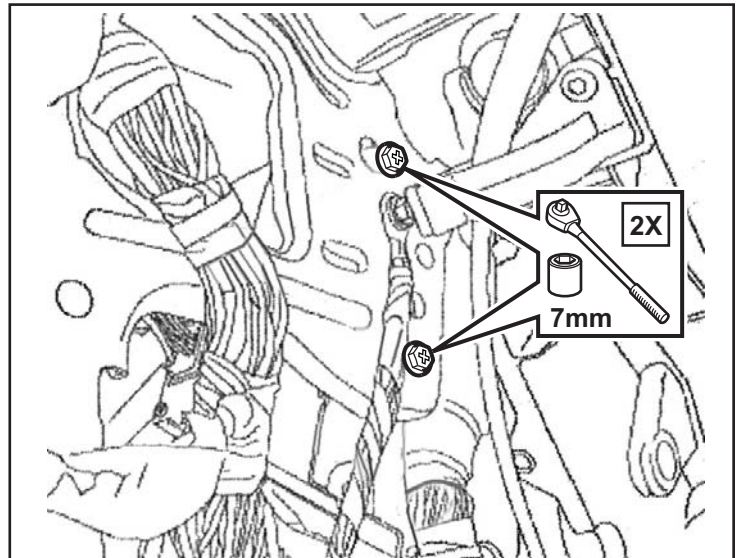

14. Loosen the one (1) 7mm amplifier bracket mounting screw located at the top of the bracket. Remove the amplifier and bracket assembly from the vehicle.

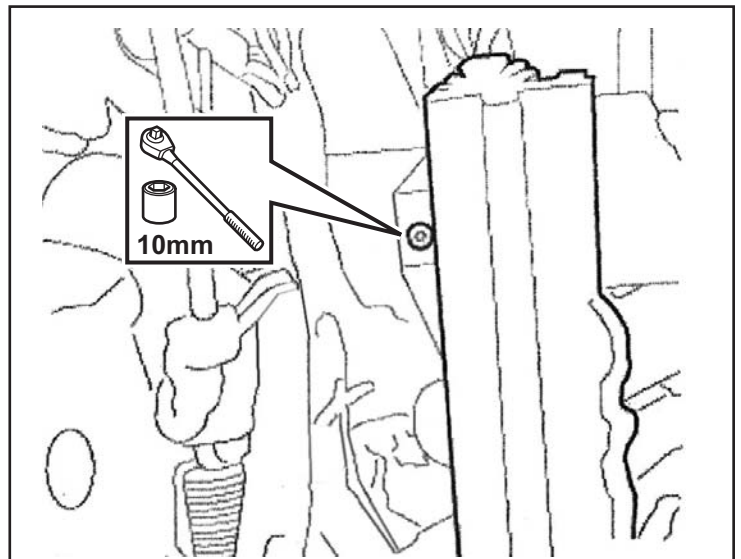

15. Locate the BCM up behind the left side of the dash. Locate and remove the top left connector (C1) from the BCM as indicated.

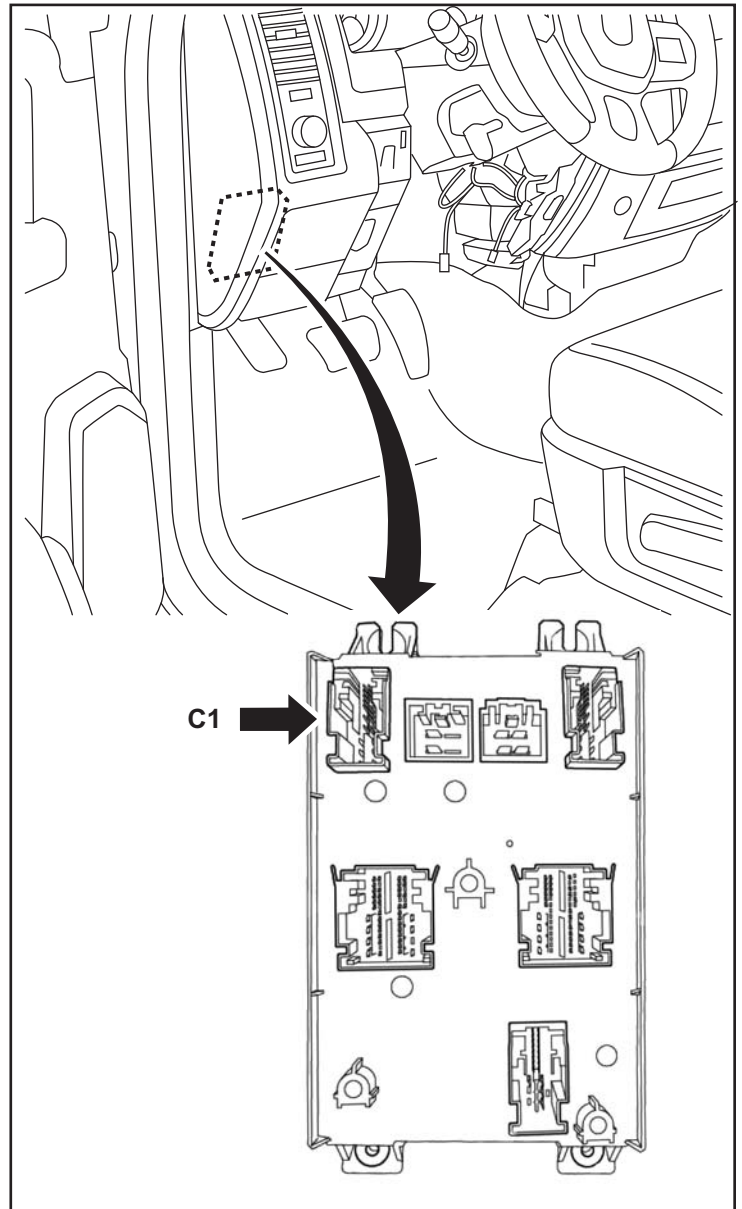

16. Press in on the release tabs at the back of the connector and slide the plug out from the outer casing.

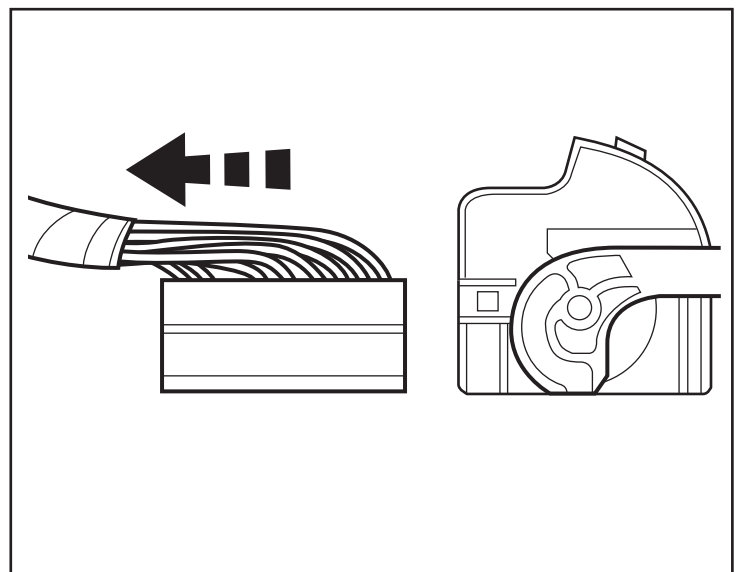

17. Locate Pin 11 on the connector.

NOTE: If Pin 11 has a factory harness wire present, remove the factory wire and tape it back on the harness.

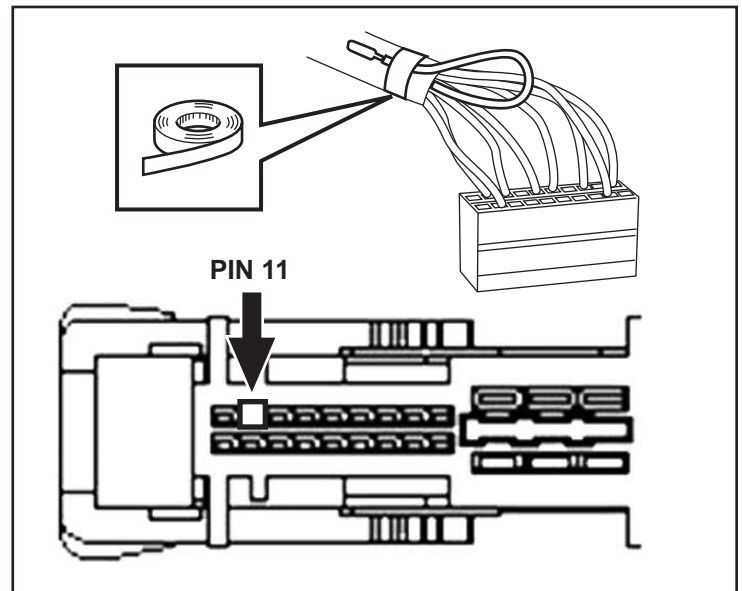

18. Insert the tab wire connector from switch harness (B) into Pin 11 on the connector.

19. Reinstall the outer casing and plug the connector back into the BCM.

20. **If necessary**, reverse steps 12 - 14 to reinstall the audio amplifier.

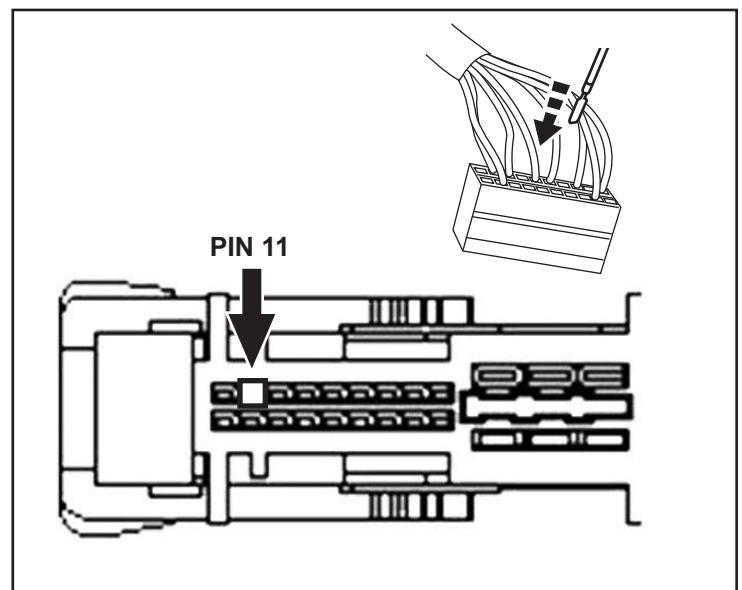

21. Bundle and stow any excess harness under the dash with cable ties. Reconnect the data link connector and hood release latch and reinstall the trim panel under the steering wheel. Reinstall two (2) fasteners under the bottom edge of the panel.

22. Check all wiring and trim all cable ties.

24. **Reverse steps 1 and 2 to reinstall radiator cover panel and reconnect battery.**

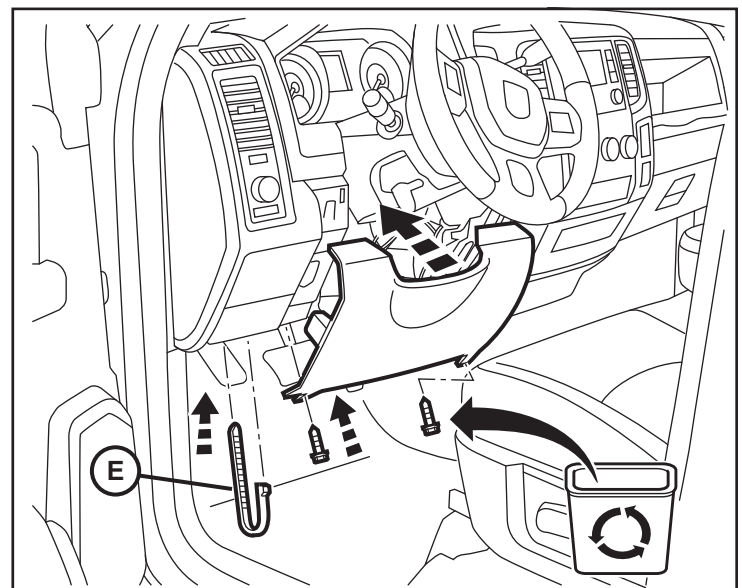

PROGRAM NEW IGNITION KEYS

NOTE: The wiTECH software level must be at the latest release to perform this procedure.

NOTE: A maximum of eight keys can be learned to the Radio Frequency Hub Module (RFHM).

NEW KEY PROGRAMMING PROCEDURE

Refer to the latest service programming procedure.

TEMPORARY REMOTE START DISABLE

1. Select "BODY CONTROL MODULE (BCM)".
2. Select "TEMPORARY REMOTE START DISABLE".
3. Following the prompts, verify the remote start is enabled.
4. The cluster will chime several times, then both cluster and BCM will be reset.

CLEAR ALL DTC'S

NOTE: The wiTECH diagnostic application is the preferred method for clearing all DTC's.

TEST THE REMOTE START

With the vehicle off, and the doors closed and locked, verify the remote start is functioning properly.