



Engineered to Deliver

1-800-501-1587

WWW.TRACRAC.COM

IN-30000_F

T-RAC G2

Installation Instructions

TracRac Inc.
994 Jefferson St.
Fall River MA 02721
www.tracrac.com
800-501-1587



Engineered to Deliver

1-800-501-1587

WWW.TRACRAC.COM

Thank you for your purchase of a T-Rac G2 cargo rack from TracRac®. TracRac® takes great pride in the quality and workmanship we put into every product. We designed the T-Rac G2 specifically to meet your cargo management needs and it will do just that. With 800 lbs of load capacity and its heavy-duty aluminum construction you can be sure this rack can handle all of your gear.

To get started, please take a minute to reference the packing list and ensure that all of the components of your T-Rac G2 are in the package. The installation should take you approximately 65 to 90 minutes.

TABLE OF CONTENTS:

T-Rac G2 Accessories	Page. 2
Installation Overview	Page. 3
Hardware Contents	Page. 4
Upright Assembly	Page. 5
Cross Bar Assembly	Page. 6
Clamp and Truck Installation	Page. 7
Toolbox Installation	Page. 8

For further assistance, please don't hesitate to call
 TracRac's Technical Assistance Team @ 1-800-501-1587
 or
 You can view a step by step installation guide on
 YouTube.com
 Search Keyword: T-Rac G2
 (www.youtube.com/watch?v=y_57jxcCckw)

Please follow these instructions carefully. Ensure that bolts are torqued to the specified rating and ensure that all diagramed and instructed relative distances for components are met. Failure to do so will waive the warranty.

Parts Overview

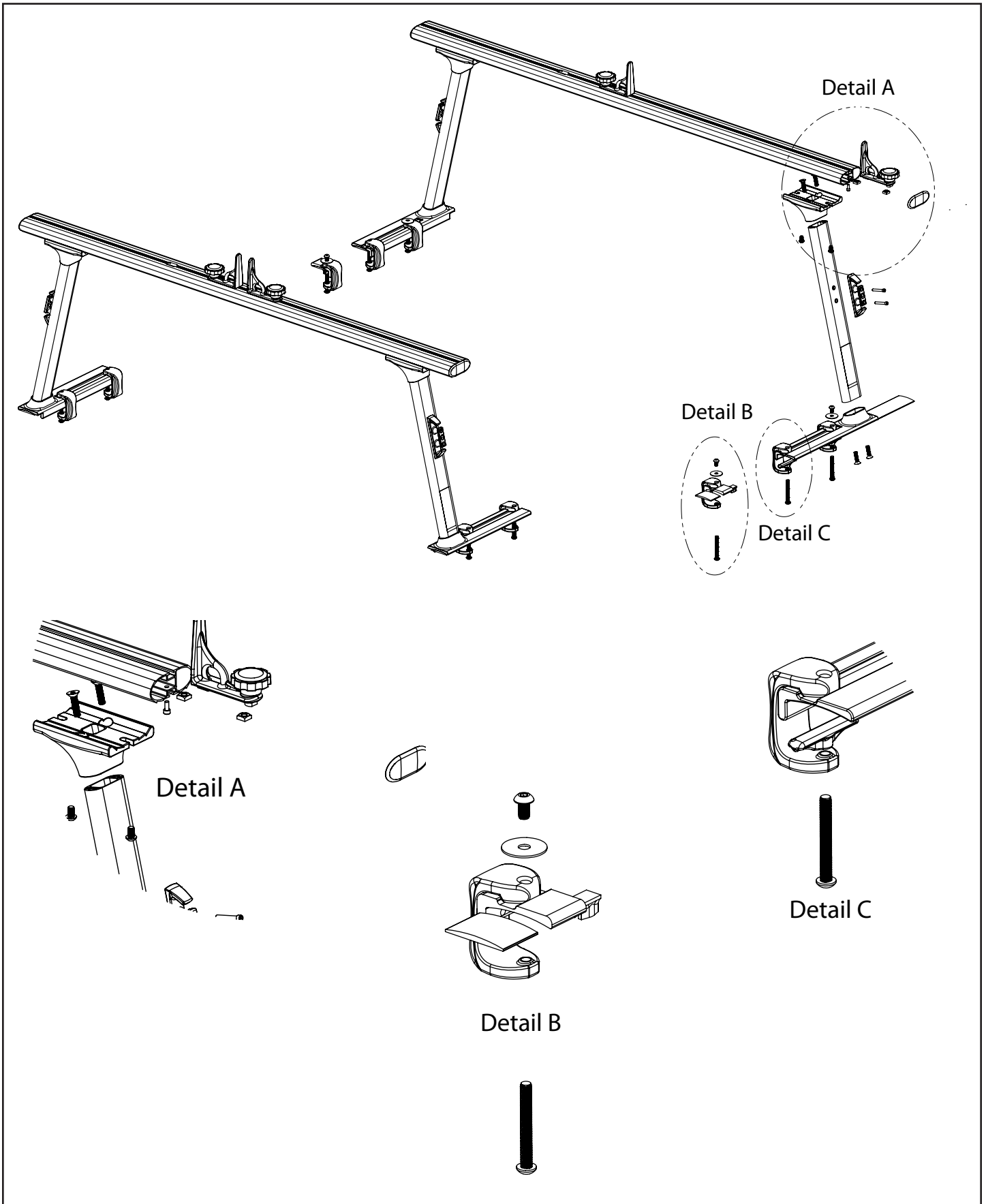

PARTS

ITEM NO.	PART NUMBER	DESCRIPTION	Qty
1	01-30008	P/C, DOUBLE T-SLOT CROSSBAR, ROUTERED	2
2	01-27013	P/C, UPRIGH BASE LF/RR	2
3	01-30001	ASM, MODULAR UPRIGHT, T-RAC	4
4	01-27012	P/C, MODULAR SADDLE	4
5	01-27014	P/C UPRIGHT BASE RF/LR	2
6	RX-11034-3	SHIM, ROUNDED	4
7	01-27023	P/C, DOUBLE/TRIPLE CROSSBAR ENDCAP	4
8	01-27046	P/C, UPRIGHT CLEAT	4
9	01-27015	HARDWARE BAG - CLAMPS	1
10	01-27016	HARDWARE BAG - UPRIGHT/SADDLE	1
11	01-30005	HARDWARE BAG - CLEATS	1
12	KB-90004	KNOB, FEMALE 3/8-16 UNC	4
13	01-23321	P/C, CROSSBAR TIEDOWN	4
14	01-41503	P/C, TOOL BOX SHIM	2
15	01-30006	HARDWARE BAG - TB MOUNT	1
16	01-27029	P/C, TB FRONT MOUNT	10

TOOLS

Tools you will need:

- 7/32" Allen Key*
- 3/16" Allen Key*
- Tape Measure
- Recommended: Torque Wrench.

Use a T-Handeled Allen Key for better leverage

7/32" Allen Key*

3/16" Allen Key*



Tools that will make it easy

- 7/32" & 3/16" Hex Bit Socket
- 1/4" Socket Adaptor
- Electric Drill / Socket Wrench

7/32" & 3/16" Hex Bit Socket

1/4" Socket Adaptor

Electric Drill

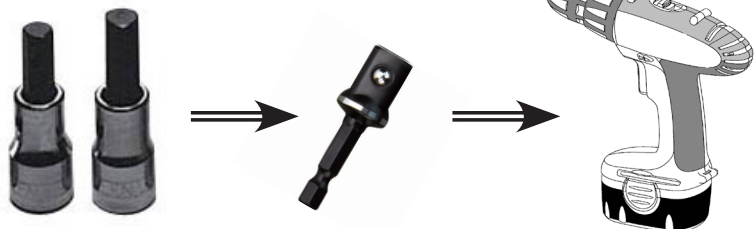

These tools although not necessary, will make the install time faster.

Hardware



Engineered to Deliver

1-800-501-1587
WWW.TRACRAC.COM

Upright/Saddle Hardware

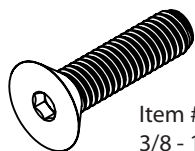

Item # 17
3/8 - 16 x 1.5"
Flat Head Cap Screw
(FHCS)
Qty - 16



Item # 18
3/8 - 16 x .625"
Button Head Cap
Screw (BHCS)
Qty - 8

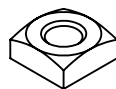

Item # 19
3/8 - 16
Square Nut
Qty - 8



Item # 20
M6-1
Socket Head Cap
Screw (SHCS)
Qty - 4

Clamp Hardware

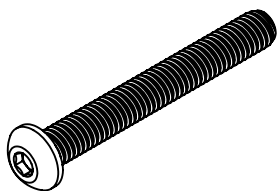

Item # 21
3/8 - 16 x 2.5"
Button Head Cap Screw
(BHCS)
Qty - 8

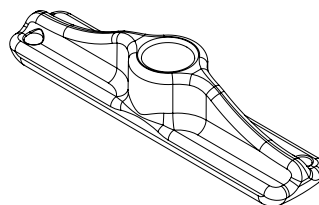

Item # 22
3.0"
U - Channel
Qty - 8

Aluminum Tiedown Hardware

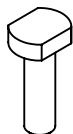

Item # 23
3/8 - 16 x 1.125"
Qty: 4

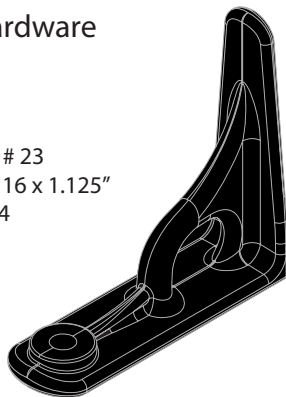

Item # 24
Die-Cast Aluminum
Crossbar Tiedown
Qty:4

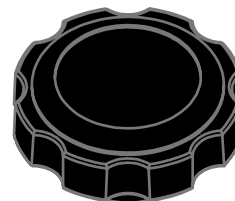

Item # 25
Tiedown Knob
Qty:4

Aluminum Cleat Hardware

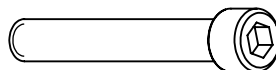

Item # 26
1/4-20x 1.75"
Socket Head Cap Screw (SHCS)
Qty - 8

Toolbox Mount Kit



Item # 27
3/8 - 16 x .625"
Button Head Cap Screw (BHCS)
Qty - 4

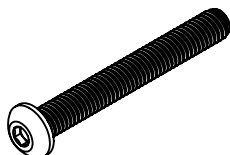

Item # 28
3/8 - 16 x 2.5"
Button Head Cap Screw
(BHCS)
Qty - 2

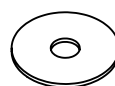

Item # 30
3/8 - .045
Stainless Steel Washer
Qty - 4

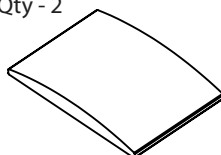

Item # 29
Plastic Shim
Qty - 2



Item # 31
7/8"
Clamp Foot
Qty - 2

UPRIGHT ASSEMBLY

1. Secure the cleat (Item 8) to the rivet nuts on the outside of the upright using two 1/4"-20 SHCS (Item 26). **Torque the 1/4"-20 SHCS to 6 ft-lbs.** This will help orientate the upright when assembling the saddle and base.
1. Insert the top (opposite the decal) of the upright (Item 3) into the Saddle (Item 4). Make sure that the smaller loft is facing the side with the cleat. See Image A.
2. Bolt the saddle through the top by using two 3/8"-16 FHCS (Item 17) and tighten using a 7/32" Allen Key (or 7/32" Allen Drive Bit). **Torque the 3/8" -16 FHCS to 32 ft-lbs.**
3. NOTE: We recommend threading both flat head cap screw initially by hand to ensure that you don't cross thread the bolt. **The bolt may seem difficult to thread - this is normal and will ensure proper rack performance. When tightening the 3/8" FHCS ensure that the Allen Key is fully seated in the bolt so that it will not strip.**
4. Now take the upright and saddle and bolt it to the modular base (Item 5 or 2). When bolting the base to the upright make sure that the cleat is facing the larger loft of the base. See Image B.
5. Repeat Steps 1-4 for the remaining three uprights.

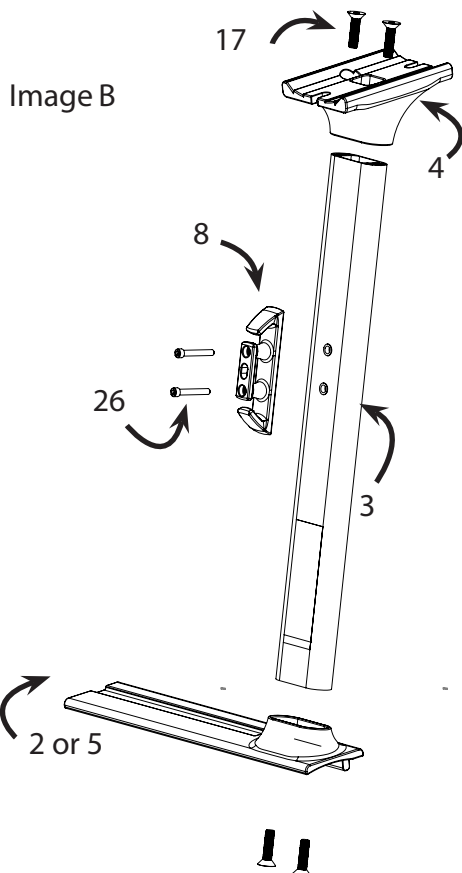
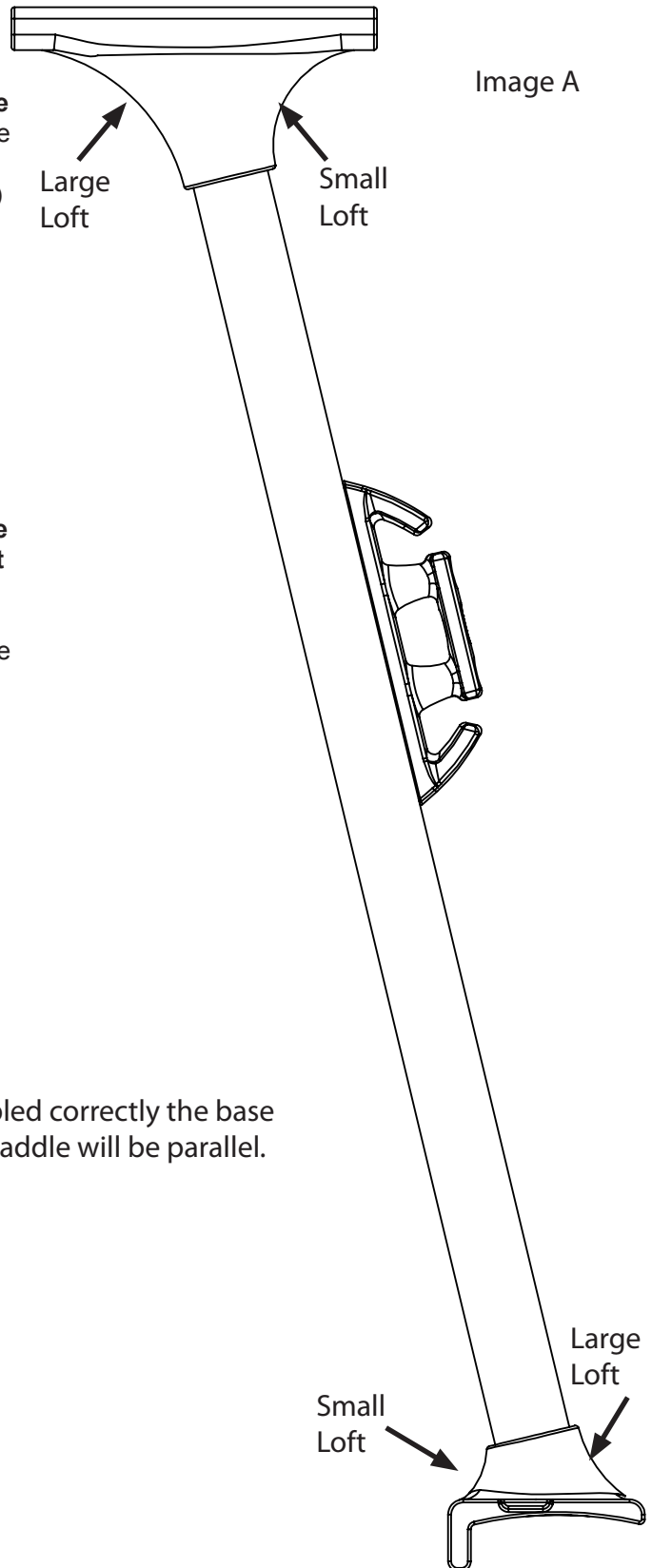

If assembled correctly the base and the saddle will be parallel.

Part 2 - Cross Bars



Engineered to Deliver

1-800-501-1587

WWW.TRACRAC.COM

CROSSBAR ASSEMBLY

1. Pre-thread the all of the Button Head Cap Screw BHCS (Item 18) into the flat side of the Square Nuts (Item 19) and set to the side. See Image A
2. Line up the assembled up rights in pairs as they would be placed onto the truck - left and right with the bases facing the same direction. See Image B
3. Take 2 of the BHCS/Square Nuts (with the square nuts facing up) place one into each of the slots of the upright saddle. See Image D
4. Take one of the Crossbars (Item 1) and orientate the bar so that the bottom is facing the floor. See Image C. Holding the bolts in the slots of the saddle See Image D, slide the square nuts into the bottom T-Slot of the crossbar. See Image E.
5. Repeat Steps 1-4 with the opposite upright.
6. Repeat Steps 1-5 with the other pair

Image A

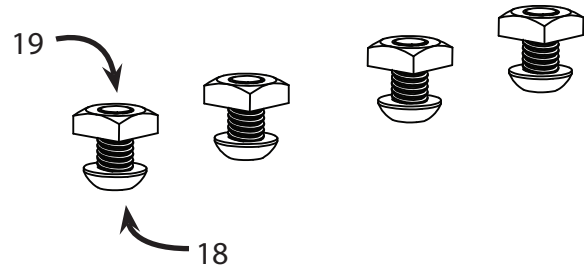

Image B

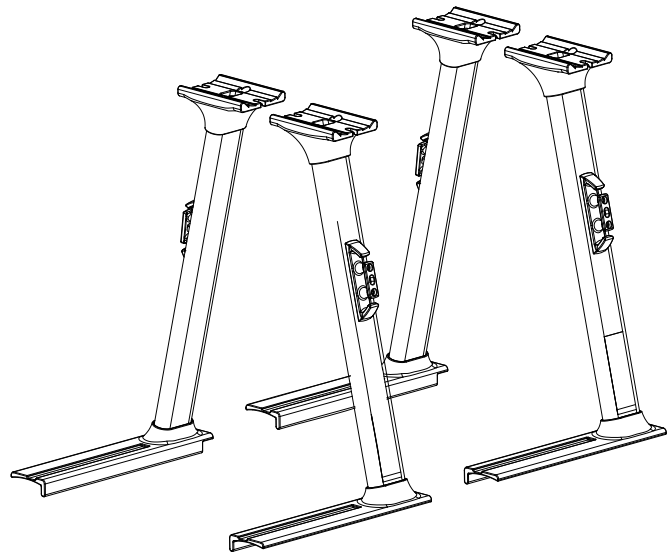

Image C

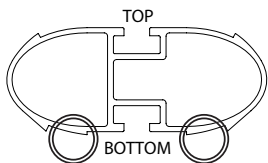

Image D

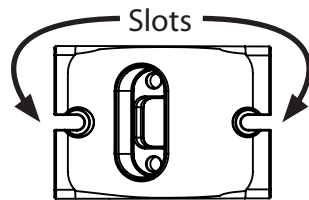
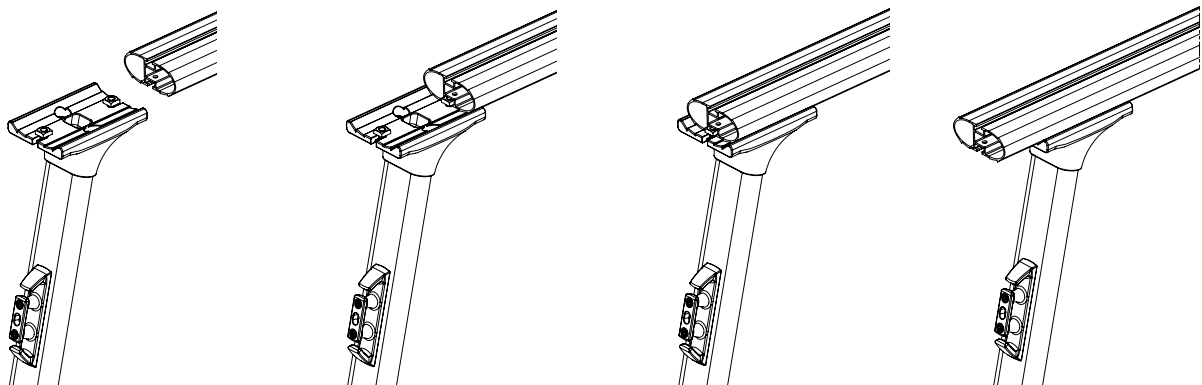

Image E



Part 3 - Accessories & Hardware

TIEDOWNS AND END CAPS

1. Remove the aluminum crossbar tiedowns (Item 24), T-bolts (Item 23) and knobs (Item 25). Insert the T-bolt through the hole of the tiedown and loosely secure with the knob. See Image A. Slide the unit into the top track of the crossbar and twist the knob until securely in place.
2. Next locate the aluminum crossbar end caps (Item 7). Making sure the flat side of the end cap is facing towards the ground, See Image B insert the end cap into the end of the crossbar and secure using the socket head cap screw (Item 20). See Image C.

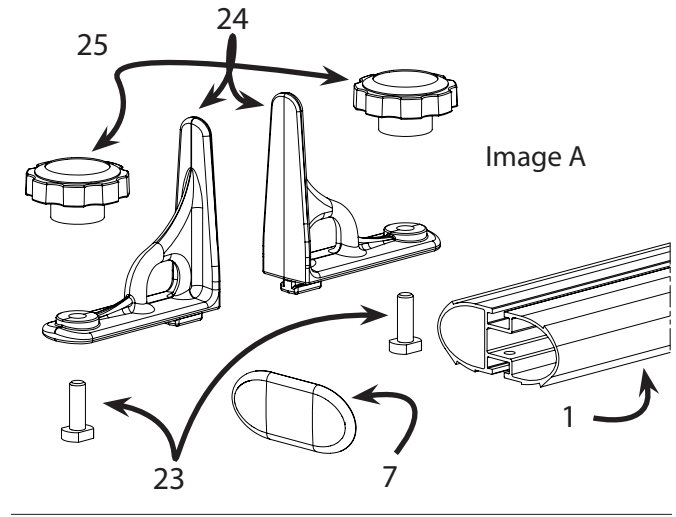

INSTALL NOTE:

Now your ready to put the rack into the truck. If your alone, we recommend that you place the racks into the trucks bed before placing into position.

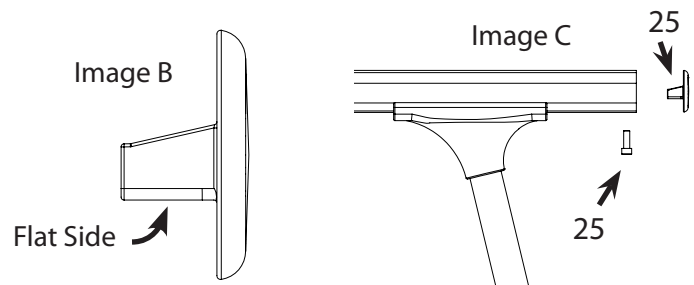

INSTALLING THE RACKS

1. Take the rounded shims (Item 6) and place them on the sidewalls of you truck approximately where the uprights will sit.
2. Place the front uprights on top of the rounded shims making sure that the rubber shims are completely under the bases.
3. Place the rear uprights on top of the rounded shims making sure that the rubber shims are completely under the bases.
4. When the racks are in place, adjust the uprights outwards towards the inner lip of the truck bed so that the I-rail of the base is as close to the truck bed as possible.

Note: Due to the taper in many trucks beds, the I-rail on the base may not but completely against the side of the truck bed. This gap is normal and will not affect the performance of the rack.

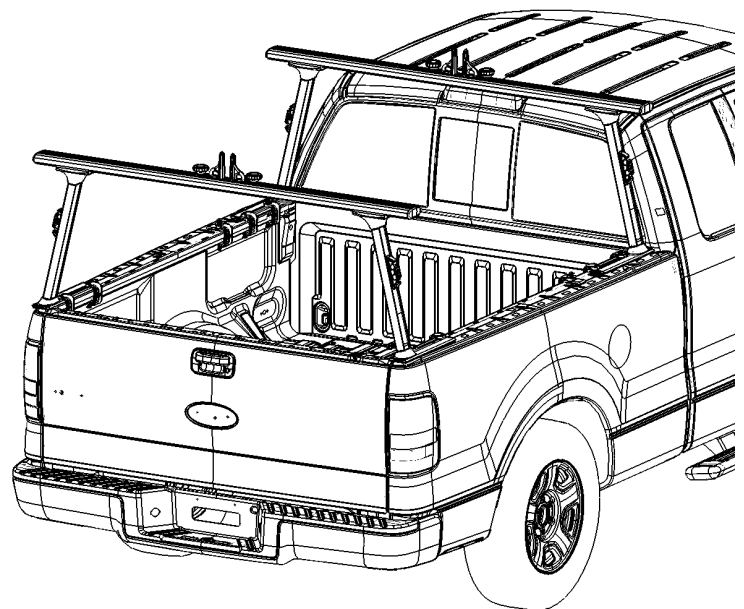

Part 4 - Clamps & Truck Installation

CLAMP ASSEMBLY

1. Take a TB Front Clamp (Item 16) and thread a 3/8"-16 BHCS (Item 21) through the bottom as shown. See Image A
2. Now take a C channel clamp foot (Item 22) and place it on top of the 3/8" BHCS as shown.
3. Repeat steps one and two for the remaining seven clamps.

We recommend that you apply Loc-Tite (red) to any thread that is engaged with the clamp. BHCS (Item 21) should be re-torqued every 5000 miles. ⚠

Image A

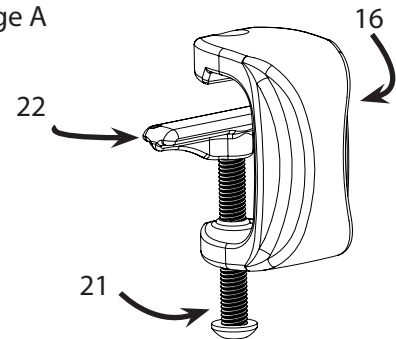

⚠ Note: clamp feet must be used to ensure proper tension between the rack and the truck bed and prevent damage

BASE/CLAMP INSTALLATION

1. First you want to ensure that your racks are in proper position and the shims are in place underneath. The Front Base has a notch in the front - THIS NOTCH MUST BE ALL THE WAY TO THE FRONT OF THE CAB SO THAT THE BASE IS ON THE BULKHEAD.
2. Front Rack - Hook 2 clamp assemblies onto either side of the truck bed rail and slide into the groove on the base. Place the front clamp as far forward toward up right as possible and the rear clamp as far back on the base as possible. See Image B. When positioning the clamps make sure they are spaced at least 7 5/16 inches apart. Any less of a distance will reduce the load capacity of the rack. See Image B
3. Torque the clamps on either side of the rack towards the cab, then follow with the other two clamps towards the rear of the truck. Torque down the BHCS to 14 lb-ft
4. Repeat steps 1-4 on the rear rack. The rear up-rights should sit as far towards the tailgate as possible without the base hanging off the back of the bed rail, while maximizing the distance between the clamps. NOTE: When positioning the clamps make sure they are spaced at least 7 5/16 inches apart. Any less of a distance will reduce the load capacity of the rack. You may adjust the position of the rear rack on the bed to ensure that this distance can be achieved
5. Finally, with the uprights secured you now want to take a measuring tape and center your crossbars. Once centered use your 7/32" Allen Driver to fully secure your crossbars. Torque the BHCS to 27 ft-lbs.

Image B

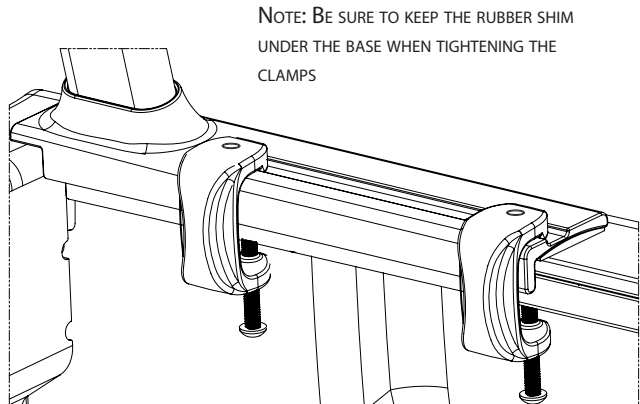

NOTE: BE SURE TO KEEP THE RUBBER SHIM UNDER THE BASE WHEN TIGHTENING THE CLAMPS

Image C

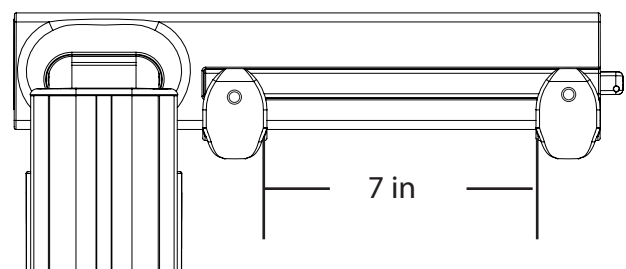
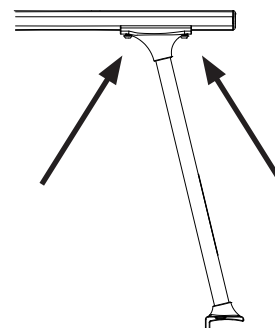

Image D



Part 5 - Toolbox Mount

If you have a toolbox, we have included a damage-free toolbox mount as a complimentary accessory for your T-Rac G2. The following instruction will guide you through mounting your toolbox. If you do not have a toolbox, please keep the mounts in case you decide to add one later on.

1. First, take one of the TB Rear Mounts and thread a 3/8"-16 BHCS in through the bottom of the clamp.
2. Take the C-Channel Clamp Foot (Item 31) and place it on top of the 3/8" BHCS
3. Repeat Steps 1 & 2 for the opposite TB Rear Mount.
4. Place the Rounded Rubber Shims on the sidewall of your truck, approximately 4" to 5" behind the upright bases. You want this to line up with the front of the toolbox.
5. Place the aluminum shim underneath the TB Rear Mounts.
6. Mount the assembled clamps onto the rounded shims and torque down the BHCS to 14 lb-ft using a 9/16" socket and torque wrench.
7. Place your toolbox on top of the clamps and secure it by using the 3/8" washer and the 3/8"-16 BHCS. Torque the BHCS to 27 ft-lbs.

Note: When positioning the toolbox, please note that there is sufficient clearance for the lid to open so that it does not scratch the uprights.

IMPORTANT: If your toolbox does not come with pre-drilled holes/slots that line up with the threaded clamps, you will need to position you toolbox in the desired location, mark the necessary hole locations, remove the toolbox and then drill either a 13/32" or 7/16" clearance hole. After the holes are drilled you will be able to mount your toolbox.

