

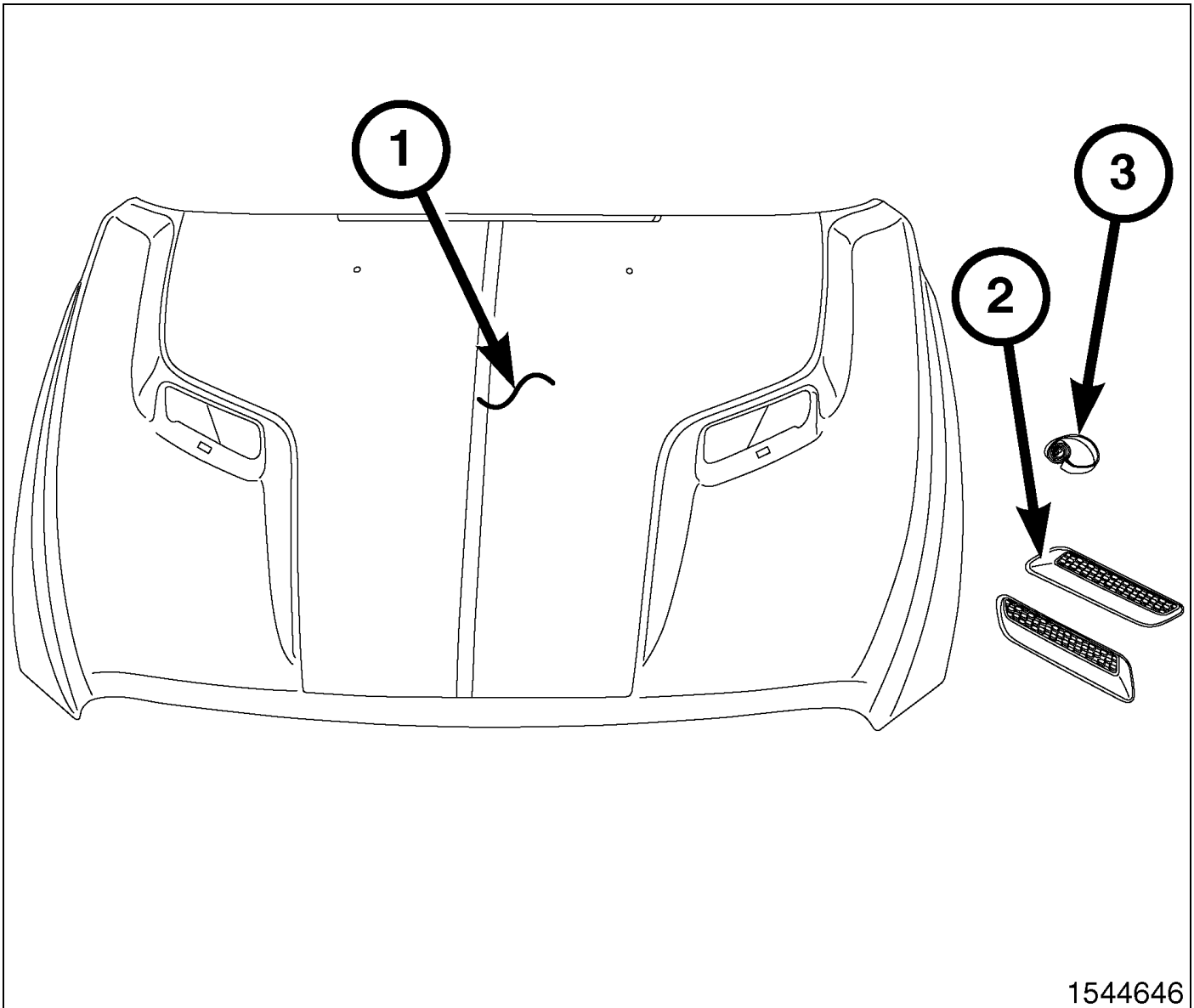

ACCESSORY HOOD

DODGE RAM



1544646

Call Out	Description	Parts	Quantity
1	Hood	Supplied in kit	1
2	Bezel	Supplied in kit	2
3	Foam tape	supplied in kit	1

PROCEDURE STEPS:

1. Disconnect the washer fluid hose (1) and release the hose from the retaining clips (2).

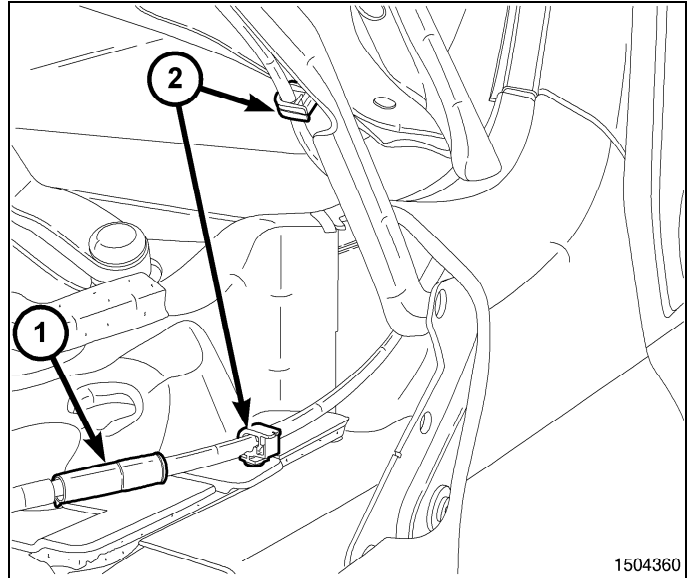

2. If equipped, disconnect the underhood lamp connector (1) and release the wire harness from the retaining clips (2).

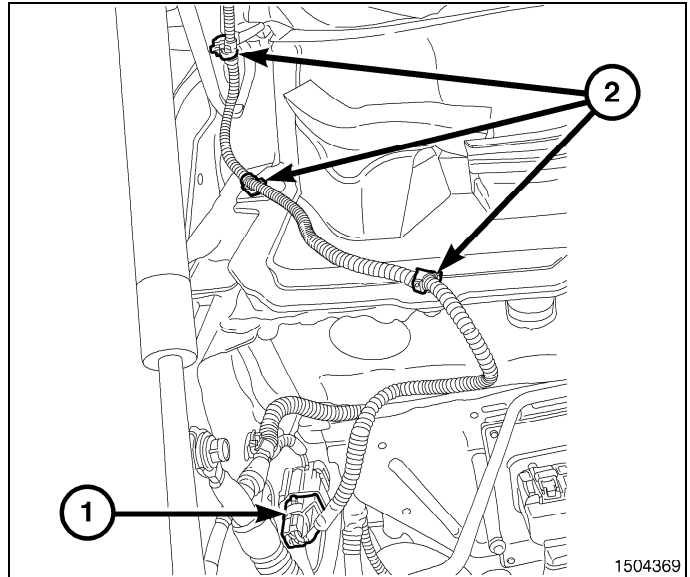

CAUTION: Be sure to not to damage the paint finish of the hood by placing the hood on non-abrasive surface.

3. With the help of an assistant, remove the two nuts (1) from the hinge (2). Repeat steps on opposite side and remove the hood.

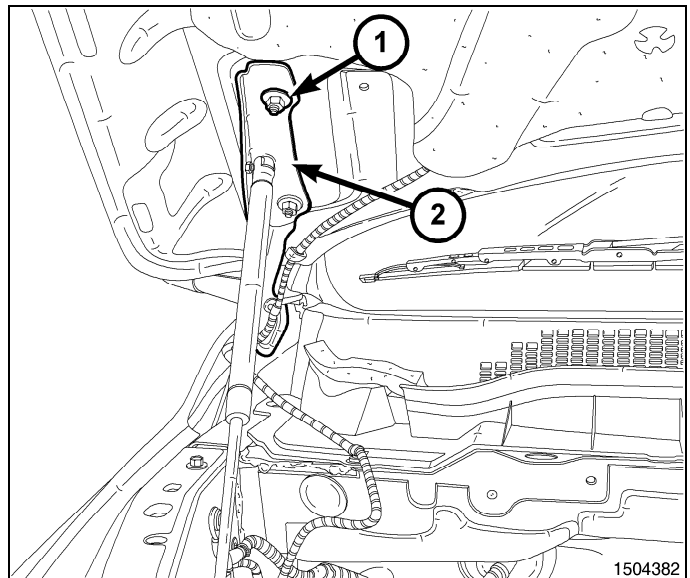

4. Remove the hood silencer pad by removing the seven retaining clips (4).

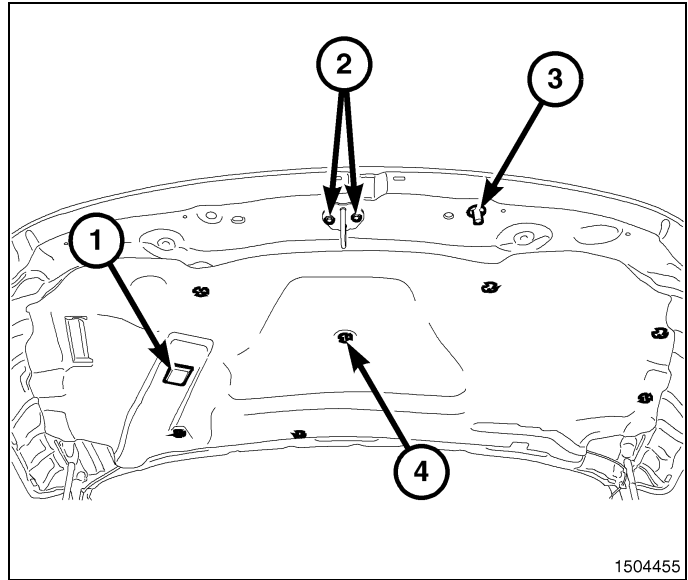

5. Disconnect the washer hose and washer nozzles by releasing the integral latch features of the washer nozzle by pushing the nozzle out through the mounting hole toward the top side of the hood. Install the nozzles on the new accessory hood.

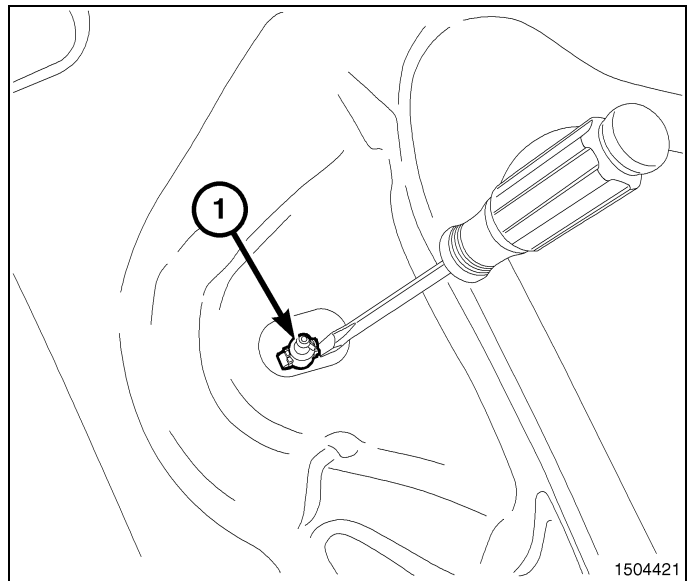

6. If equipped, transfer the underhood lamp (1) and remote starter plunger (3) to the new accessory hood.
7. Transfer the hood striker to the new accessory hood and tighten the bolts (2) to 17 N·m (12.5 ft. lbs.).
8. Install the hood silencer pad on the new accessory hood by pressing the seven retaining clips (4) into the new accessory hood.

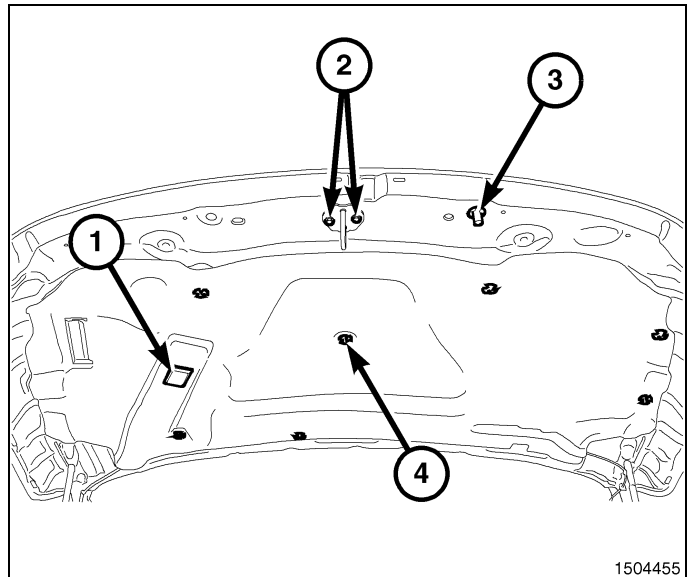

9. With the help of an assistant, position the hood onto the hood hinge (2) and loosely install the two nuts (1) that secure the hood to the hinge (2). Repeat steps for the opposite side.

NOTE: Quad Cab shown in Fig. 1, Regular Cab and Crew Cab similar.

10. Adjust the hood to the correct position, refer to Fig. 1 and the flushness chart. Once the hood is positioned properly, tighten the hood hinge nuts (1) to 18 N·m (13 ft. lbs.).

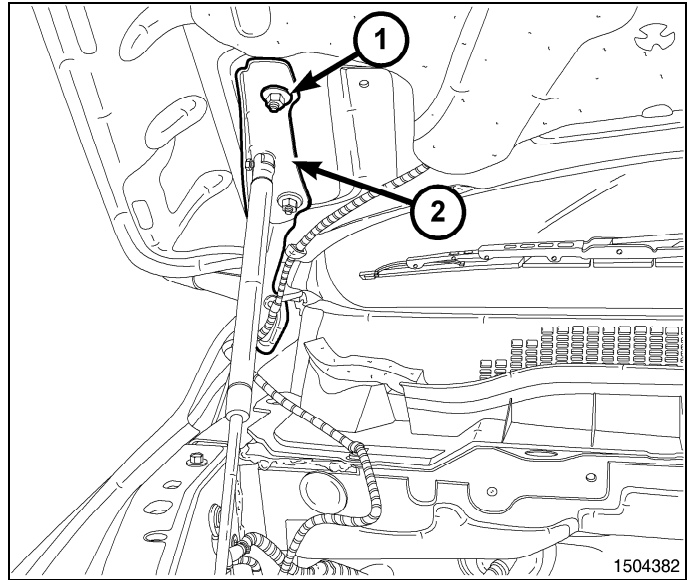

11. Connect the underhood lamp connector (1) and the wire harness retaining clips (2).

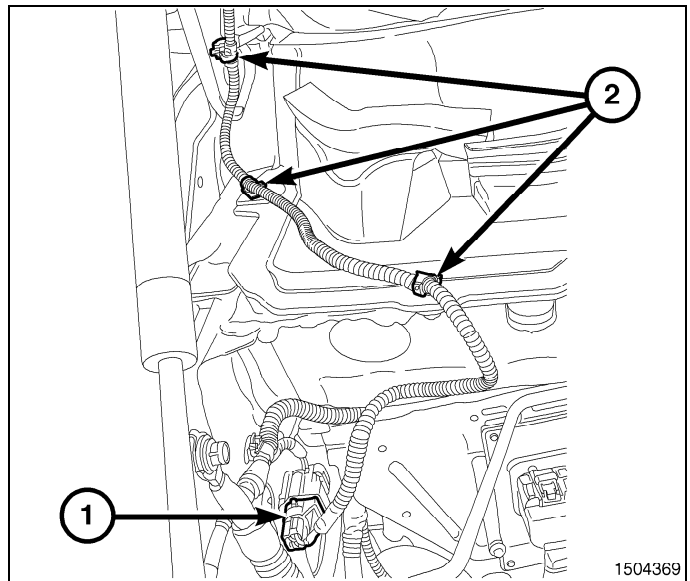

12. Connect the washer fluid hose (1) and the hose in the retaining clips (2).

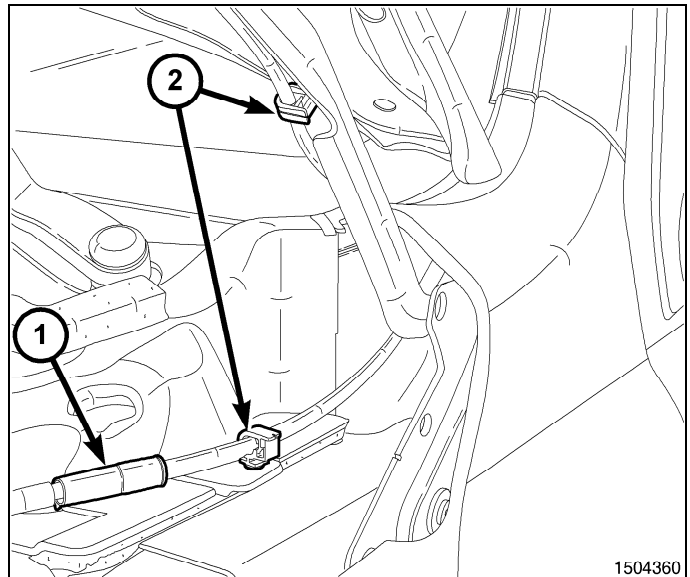

NOTE: Previous model year kits may include hood assemblies without center clip retainer openings. To determine which hood is in your kit, look for a small rectangular hole near the front of each bezel opening on the hood. If the center clip retainer openings are not present on the hood, foam tape will be required to install the bezels. If the center clip retainer openings are present on the hood, foam tape is not necessary to install the bezels.

13. If the center clip retainer openings are not present on the hood, remove the center clip (2) from the bezel (1). Repeat steps for the opposite side.

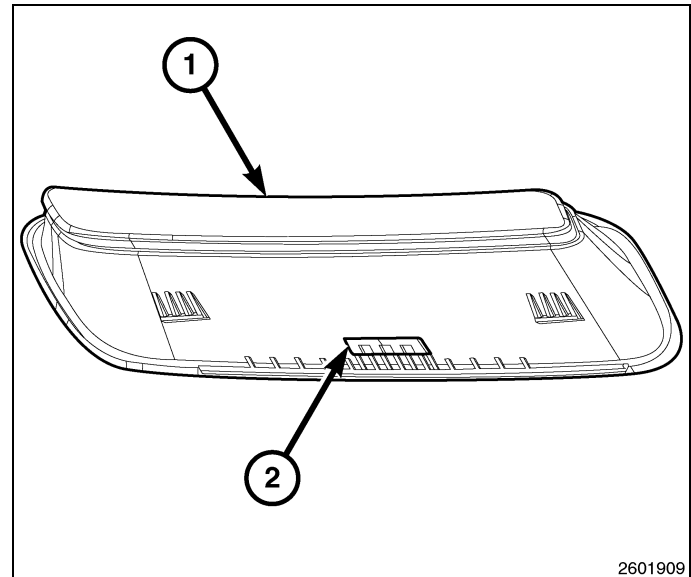

14. If the center clip retainer openings are not present on the hood, apply 152.4 mm (6 in.) (2) of the supplied foam tape to the hood bezels (1) as shown. Press down firmly for 30 seconds minimum to ensure good adhesion. Peel the tape protector back on a 45° angle on both ends of the tape. Repeat steps for the opposite side.

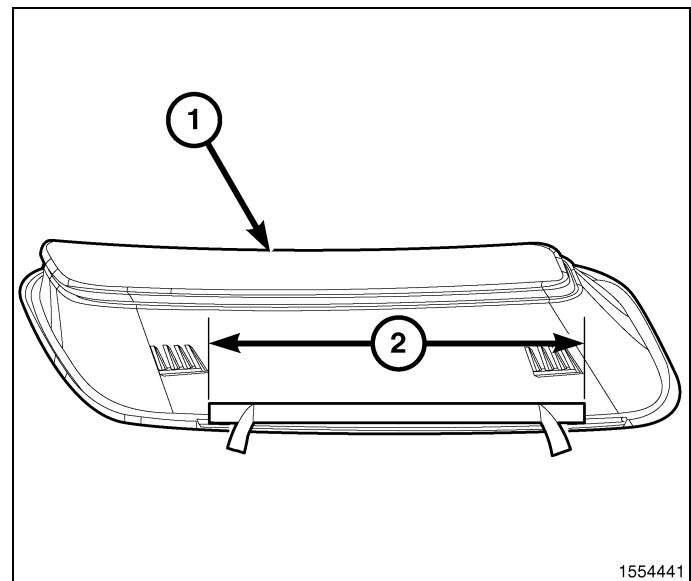

15. Install the bezel into the accessory hood.

- If the clip retainer openings are present on the hood, position the bezel into the accessory hood by loading the top edge first (1), then push downward in the center of the bezel (3) to engage the center clip. Continue pushing downward in the center and rearward (4) until all the clips are engaged. Repeat steps for the opposite side.

- If the clip retainer openings are not present on the hood, position the bezel properly into the accessory hood by loading the top edge first (1). Pushing downward in the center and rearward (4) until all the clips are engaged. Peel the tape protector (2) off to expose the tape adhesive. Press down firmly for 30 seconds minimum to ensure good adhesion. Repeat steps for the opposite side.

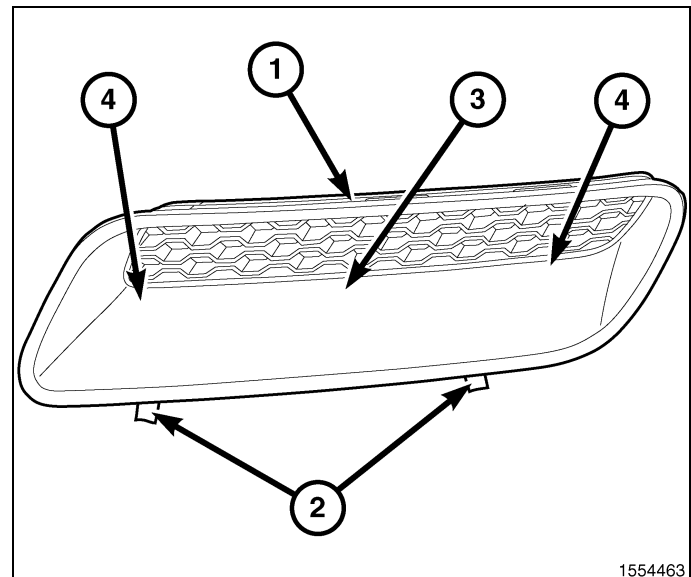

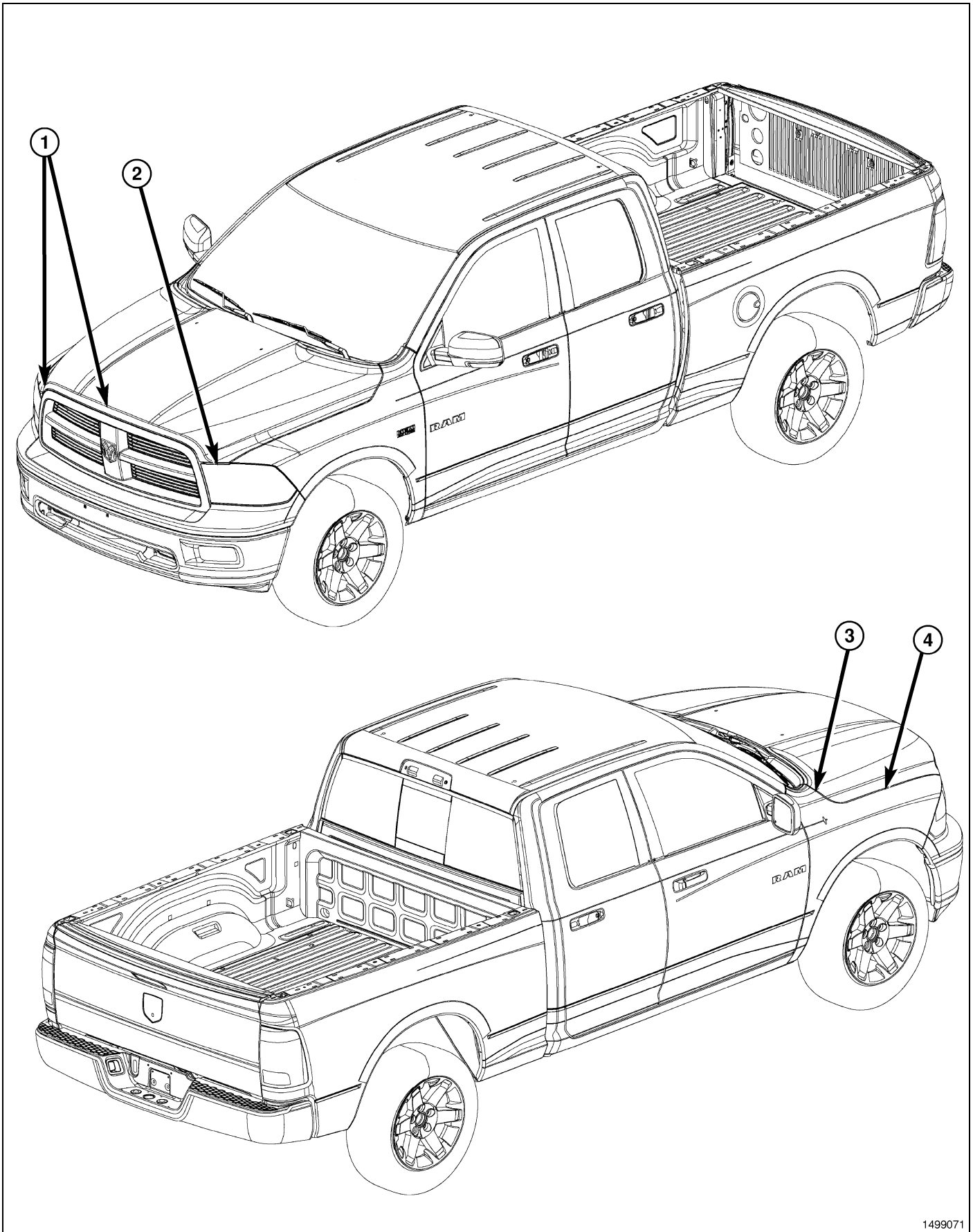

1499071

Fig. 1 QUAD CAB

HOOD FLUSHNESS CHART

NOTE: All measurements are in millimeters. O/F = Over Flush, U/D = Up/Down U/F = Under Flush, F/A = Fore/Aft			
DIMENSION	DESCRIPTION	GAP	FLUSH
1	Hood to grille (along top)	7.0 +/- 2.0 transition to 4.5 after corner	Hood o/f 7.0 @ center to 5.5 @ corner to 1.0 around corner +/- 2.0
2	Headlamp to hood	7.0 +/- 2.0 Parallel within 2.0 Side to side within 3.0	Headlamp o/f 4.0 +/- 2.0 Parallel within 2.0 Side to side within 2.0
3	Fender to hood @ cowl	4.5 +/- 1.5 Parallel within 1.5 Side to side within 2.0	Fender u/d-u/f 0.75 +/- 1.5 Cross/car 0.0 +/- 1.5
4	Fender to hood	4.5 +/- 1.5 Parallel within 1.5 Side to side within 2.0	Fender o/f 0.5 +/- 1.5