

GB	INSTALLATION INSTRUCTIONS Parts must not be fitted until registration of the vehicle has been obtained.	RUNNING BOARDS
D	EINBAUANLEITUNG Die Teile dürfen erst nach Zulassung des Fahrzeuges montiert werden.	LAUFENDE BRETTER
E	INSTRUCCIONES DE MONTAJE Nota: Si esta instalando ambos estribo y cubiertas, instale el estribo primero	ESTRIBO
F	NOTICE DE MONTAGE Les pièces ne doivent être installées qu'après l'immatriculation du véhicule	MARCHE-PIED
I	ISTRUZIONI DI MONTAGGIO Queste parti si possono applicare solo dopo che sia avvenuta la registrazione del veicolo	CORRENTE SCHEDA

Subject to alteration without notice
Veränderungen vorbehalten
Reservadas modificaciones técnicas
Assujetti à des modifications sans préavis

Expert Fitment Required
Fachmännische Einrichtung notwendig
Montaje sólo por el concesionario
Montage par spécialiste nécessaire

K6859187
Jan-2006

© DAIMLERCHRYSLER

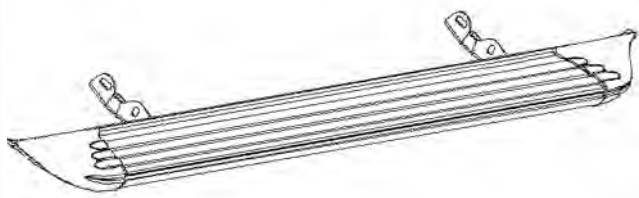

A **x1**

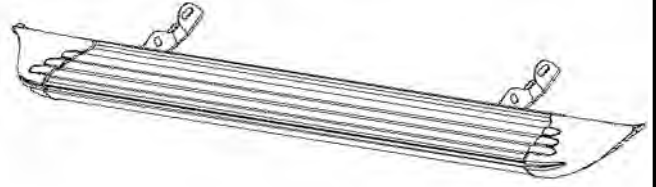

B **x1**

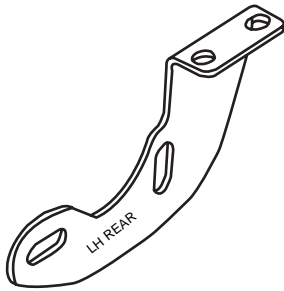

C **x1** Left Rear Bracket

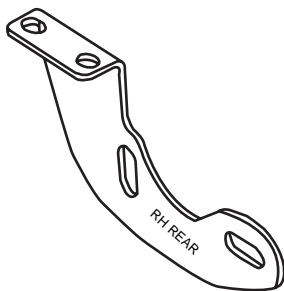

D **x1** Right Rear Bracket

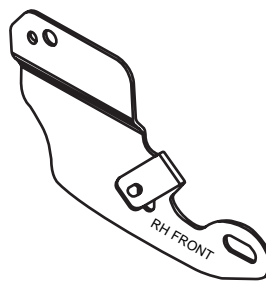

E **x1** Right Front Bracket

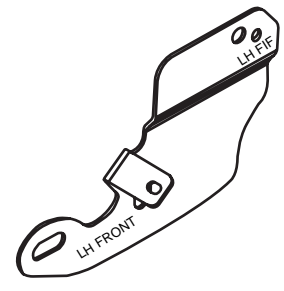

F **x1** Left Front Bracket

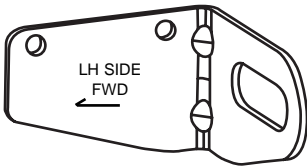

G **x2** Left Outside Bracket

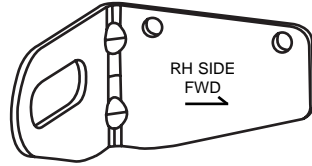

H **x2** Right Outside Bracket

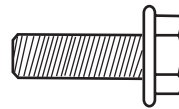

I **x10**

x9
FIF

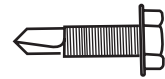

J **x4**



K **x10**

x9
FIF



L **x8**

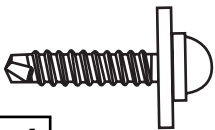

N **x4**



O **x8**

Note: FIF (Fold in Floor) also known as "Stow 'N Go" seating. Steps 1C and 1D are only used for LH FIF.

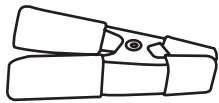

Note: Clean and debur all drilled holes and apply corrosion inhibitor, not supplied.

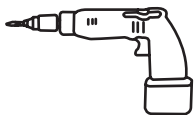

9/32" & 1/8"

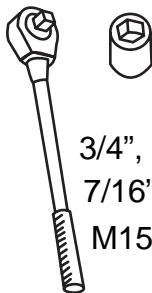

3/4", 3/8",
7/16", &
M15, M13

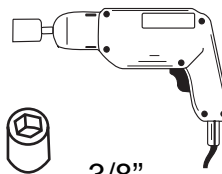

3/8"



MOPAR
P/N82300508

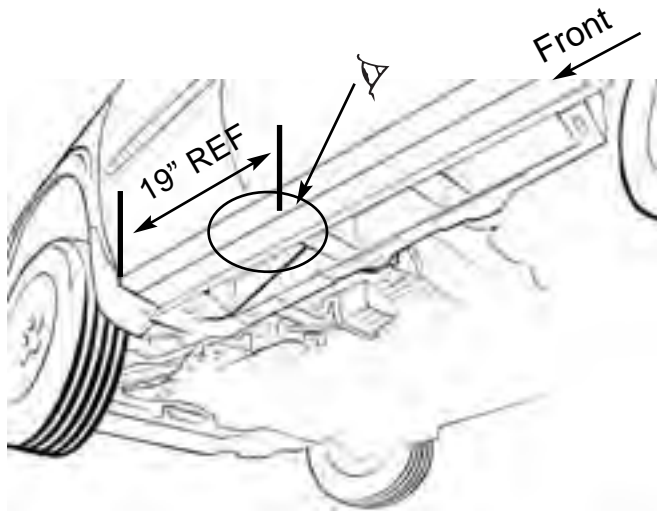

1A "Front Bracket Attachment Area"

 Match front bracket holes with vehicle type. Only on the left hand side.

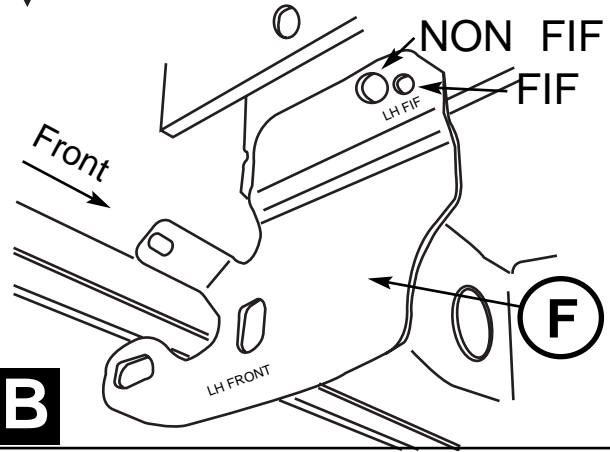

1B

FIF front left bracket installation follow instruction 1C, 1D, 2B and then continue.

Non FIF front left bracket installation skip to instruction 2A and then continue.

Remove bolt from parking
brake cable hanger

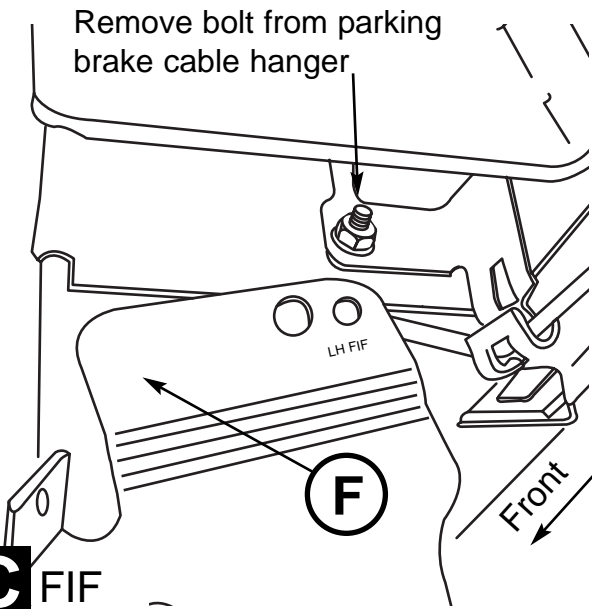

1C FIF

Reattach bolt from parking
brake cable hanger

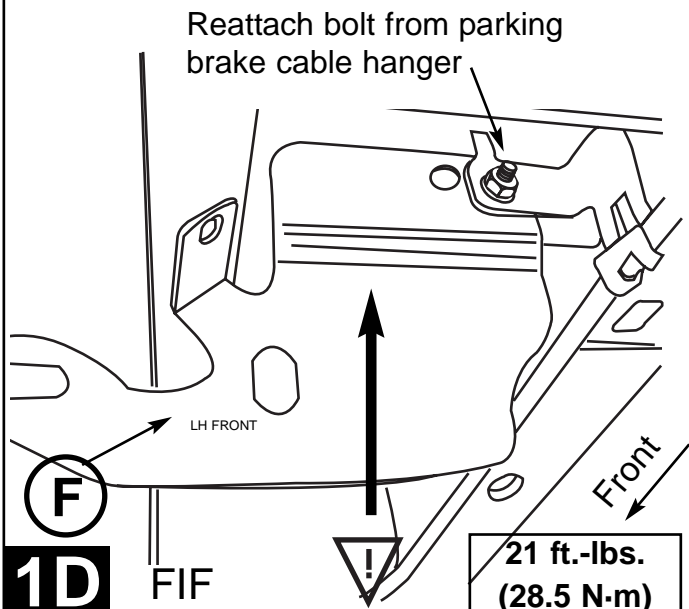

1D FIF

21 ft.-lbs.
(28.5 N-m)



Front

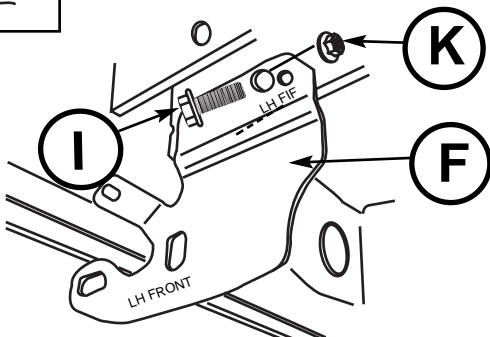

2A

J

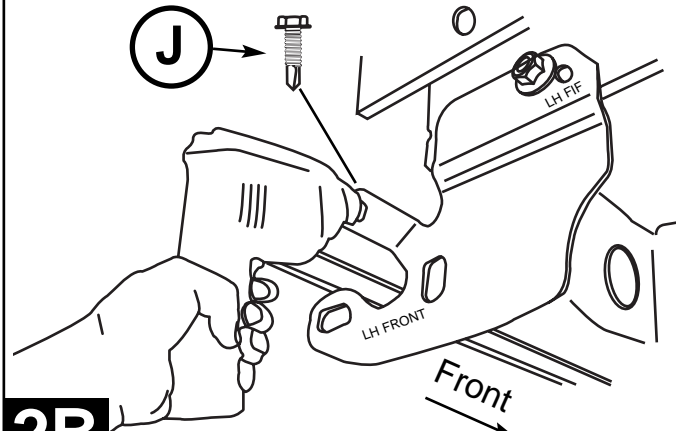

2B

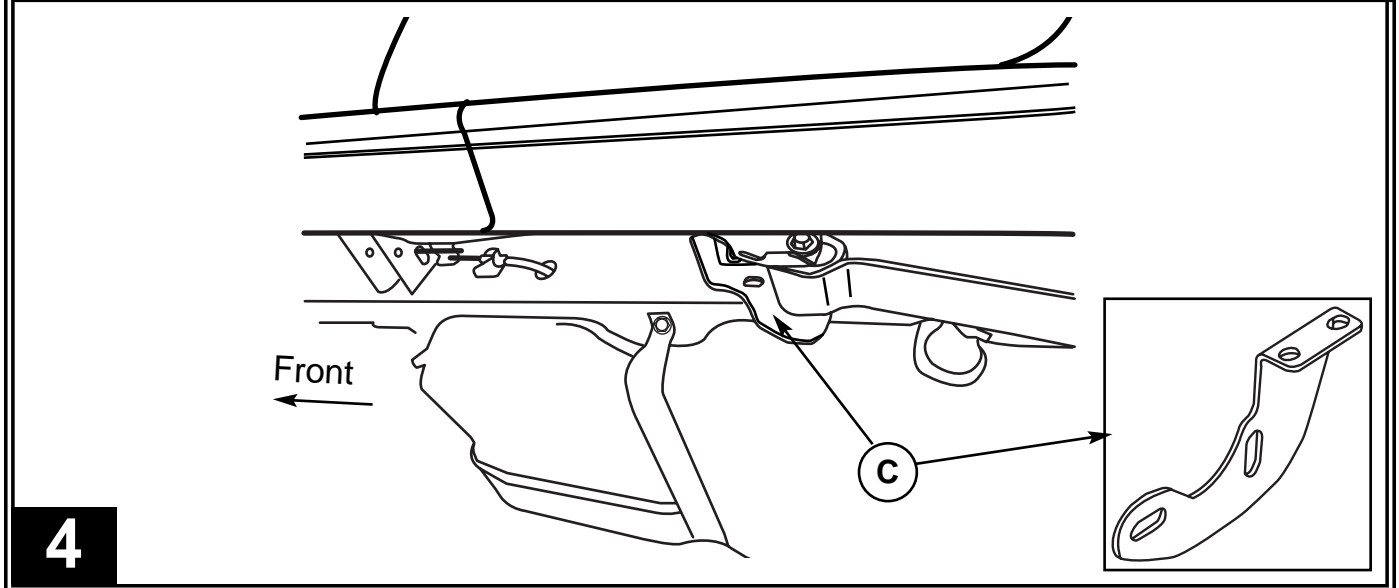
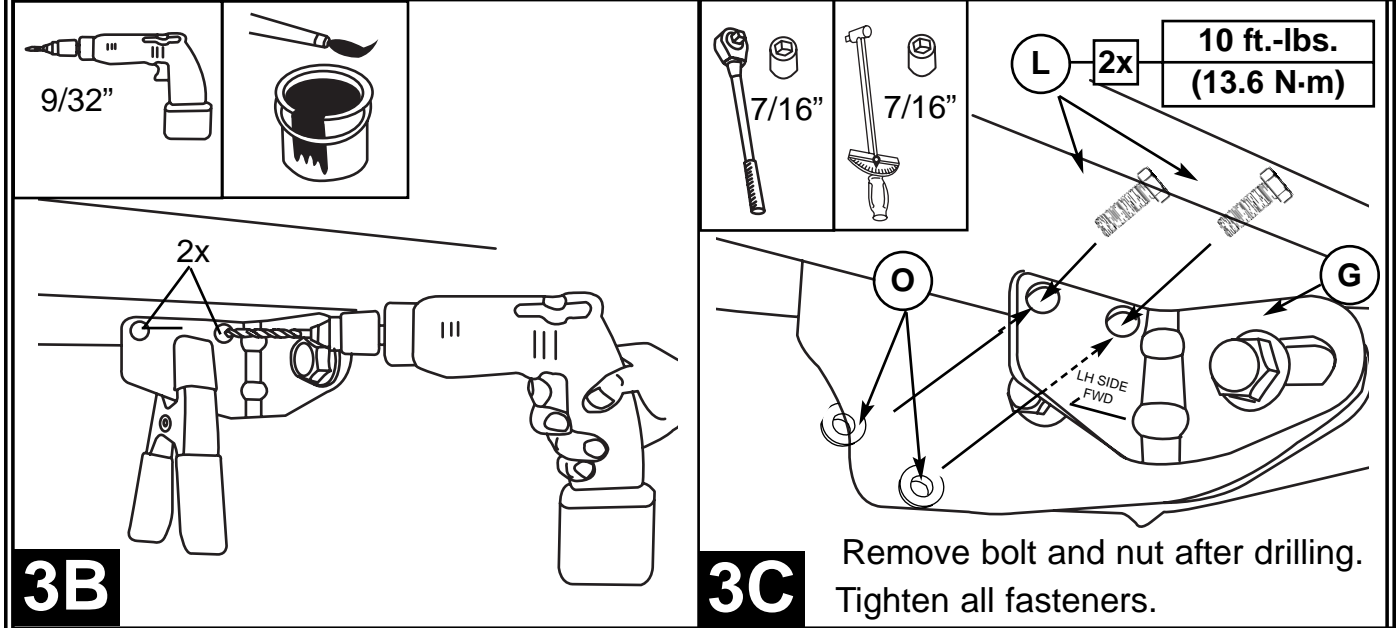
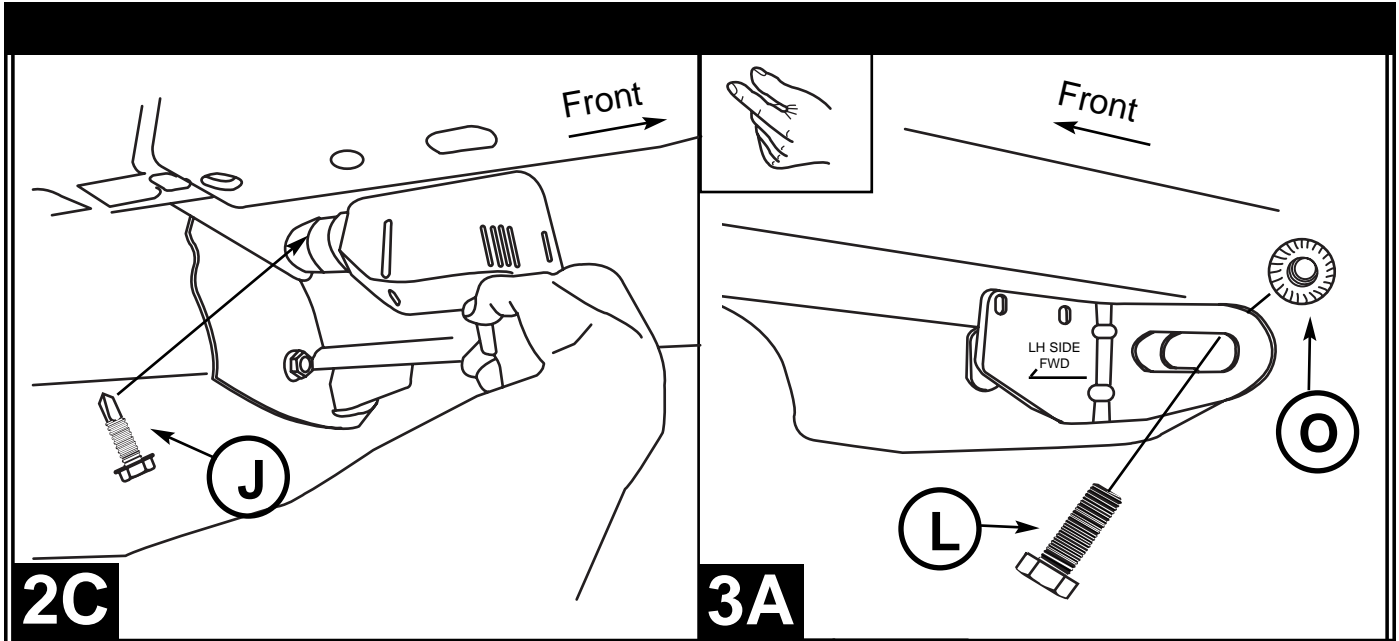

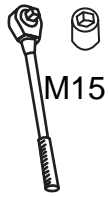

Remove 2 x M10 forward shackle bolts

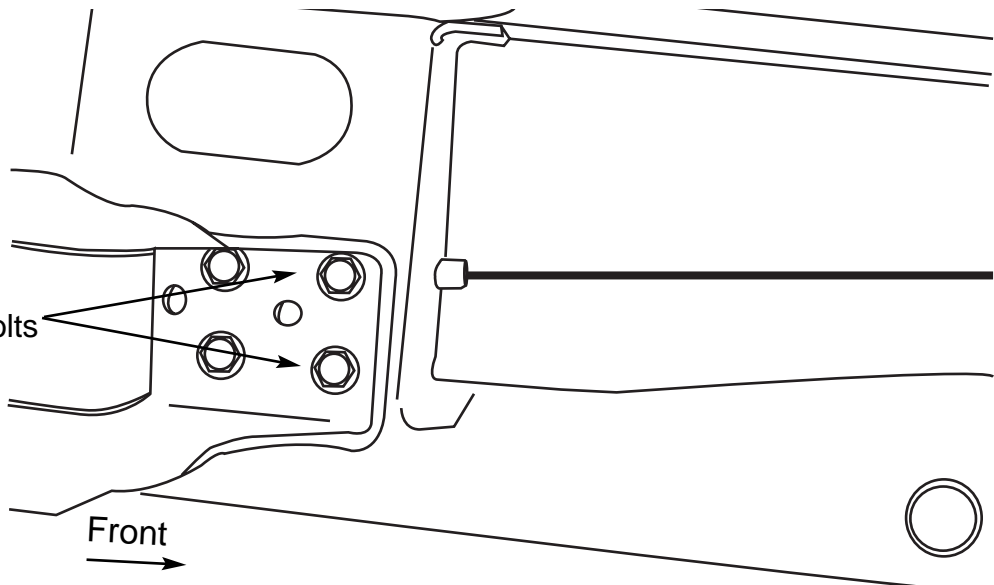

5A

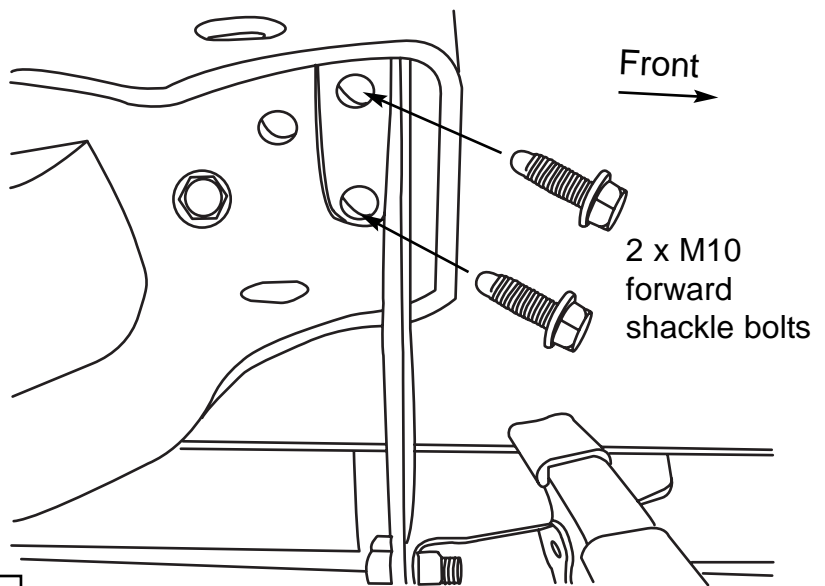
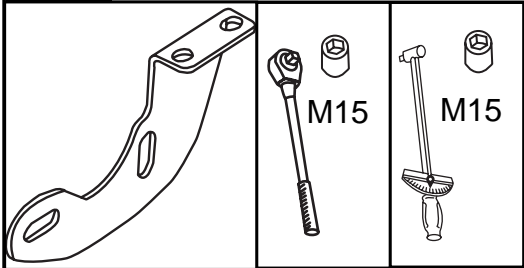

5B



2x

45 ft.-lbs.
(61.0 N·m)

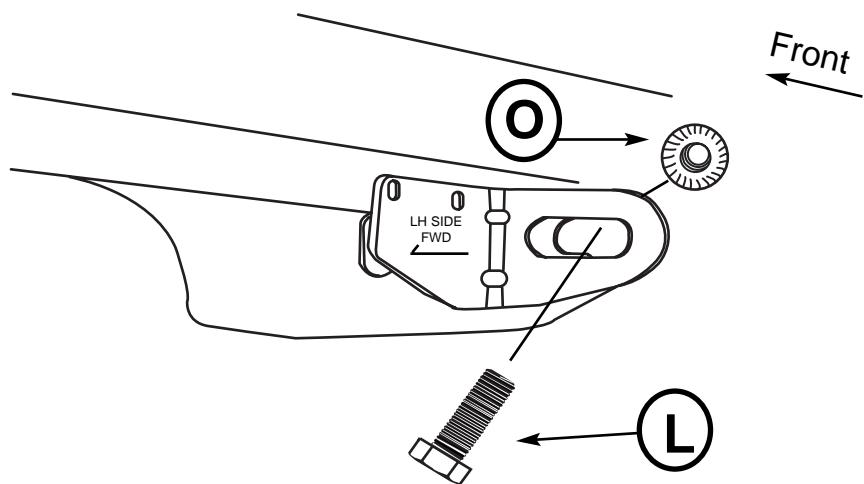

6A

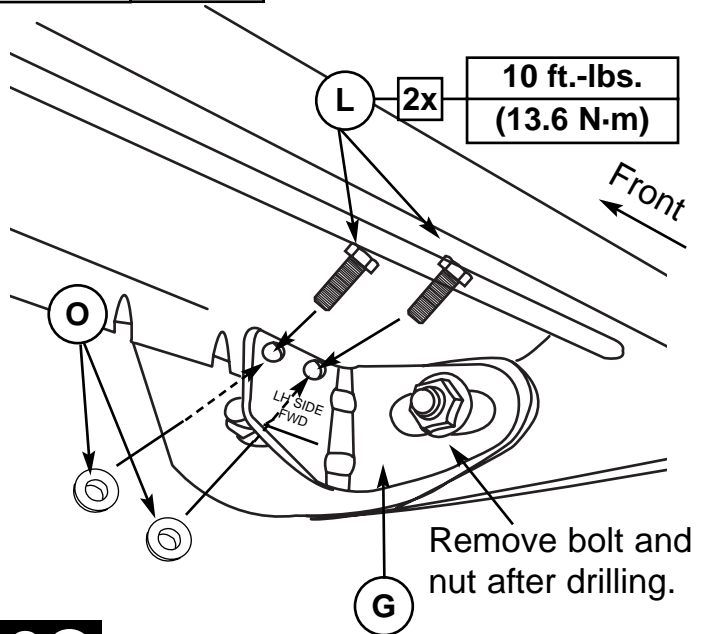
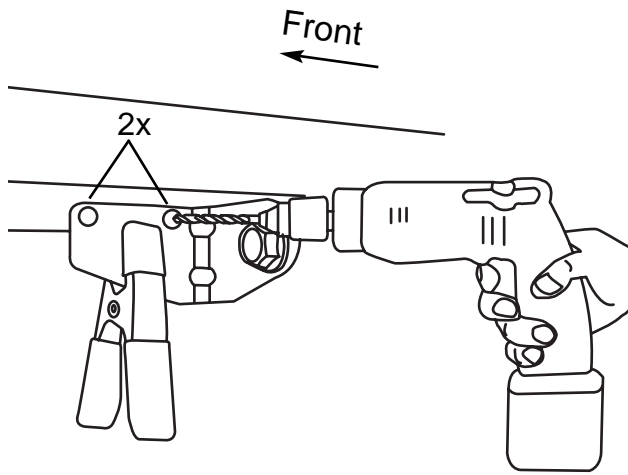
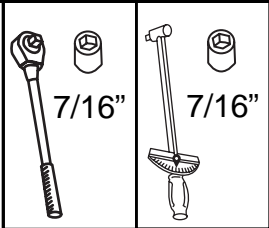
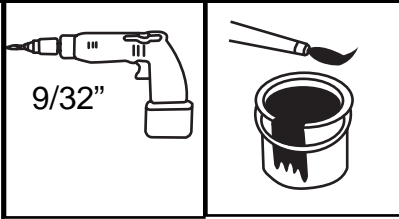

6B

6C Tighten all fasteners.



Note: Raise board till step pad touches the body.

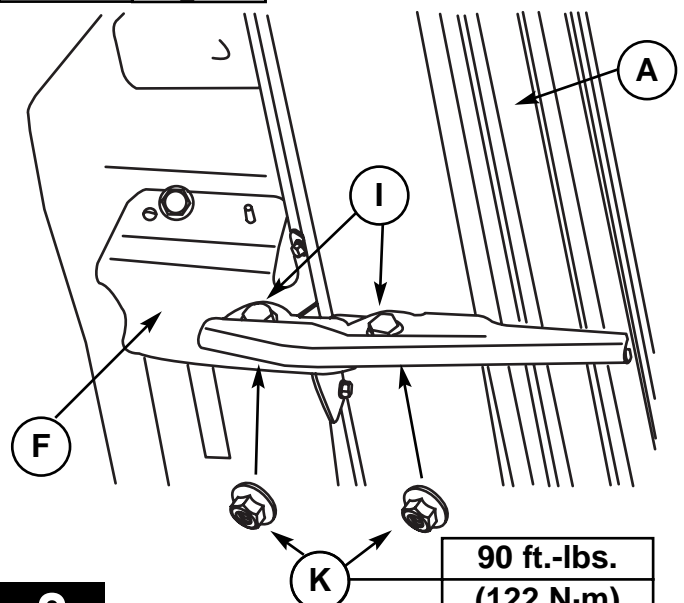
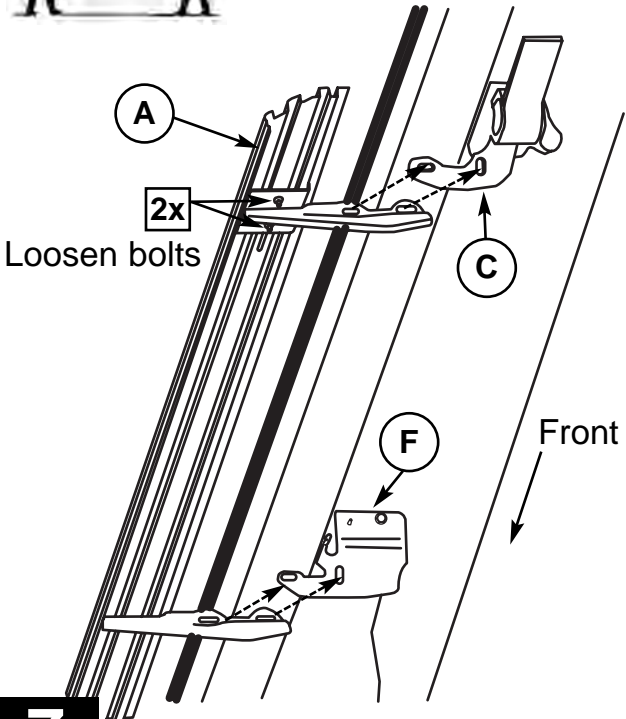
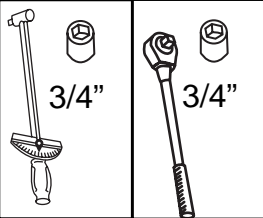

7

8

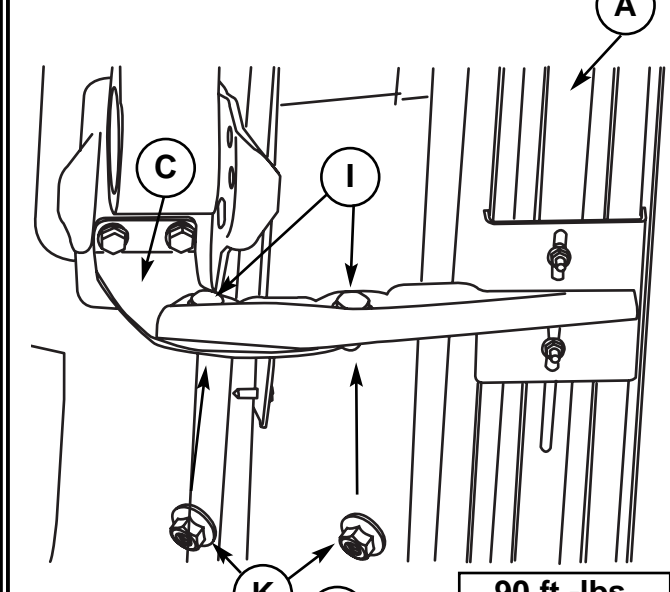
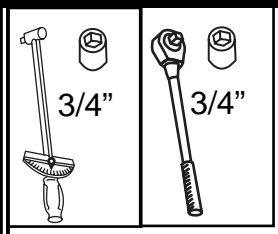

90 ft.-lbs.
(122 N·m)

9

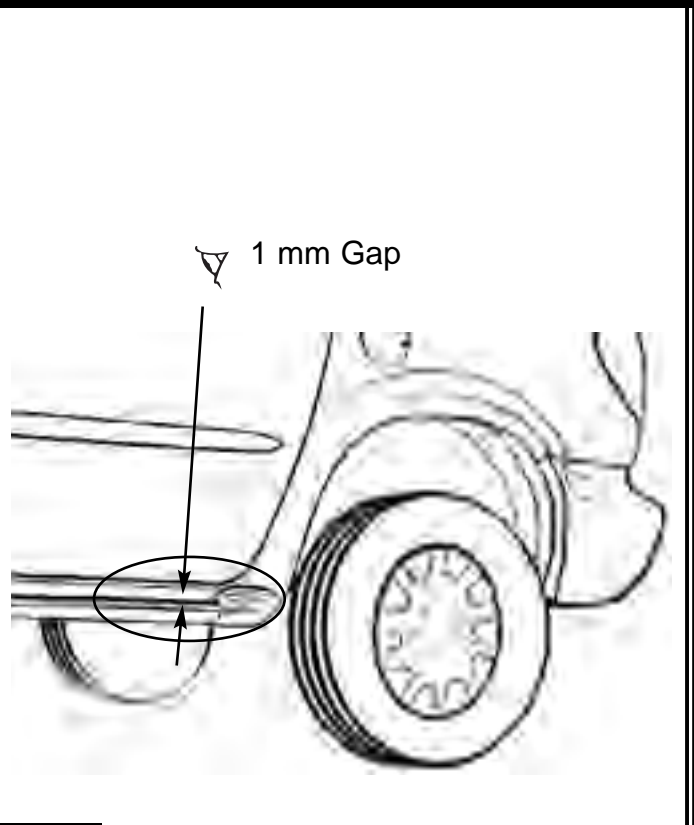

10

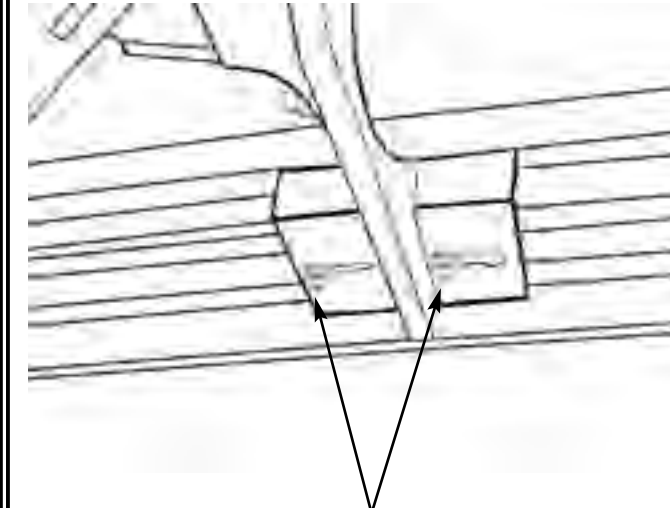
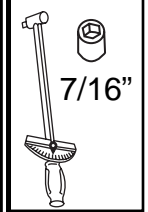

11

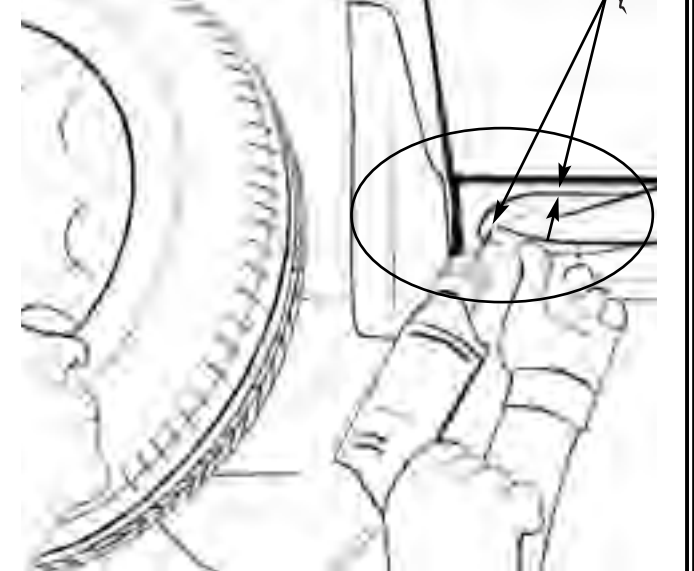
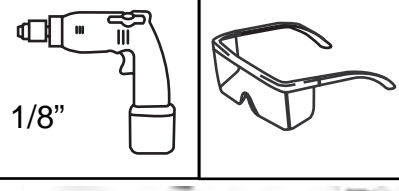

12

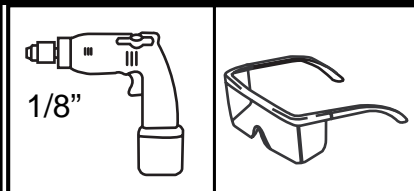

1/8"

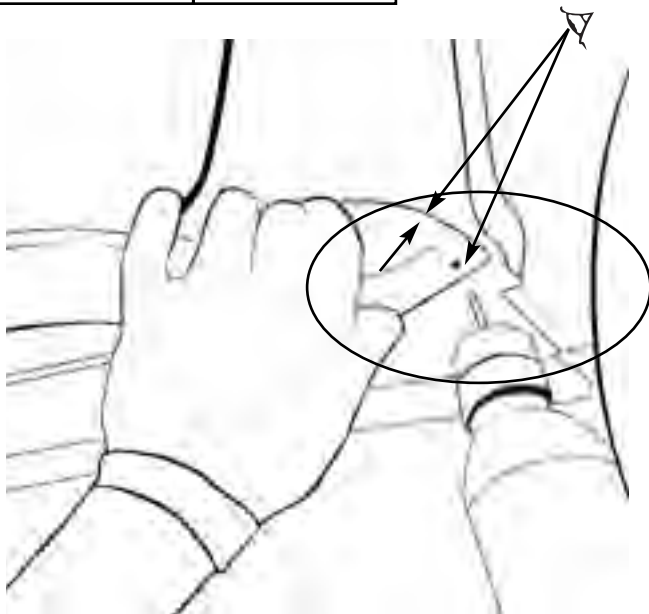

13

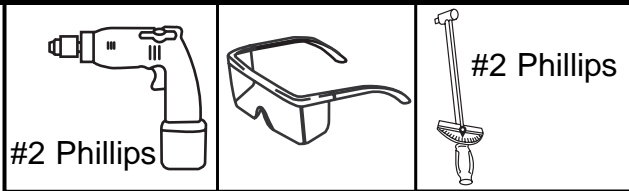

#2 Phillips

#2 Phillips

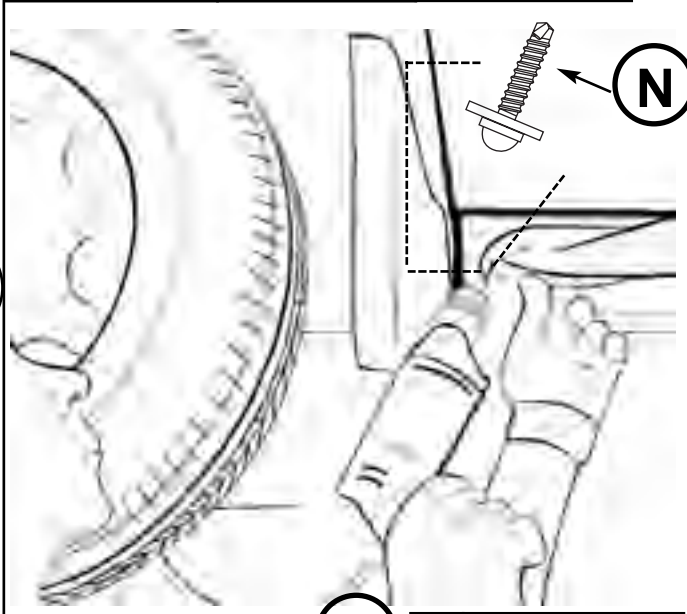

14

N 2x 42 in.-lbs.
(4.7 N-m)

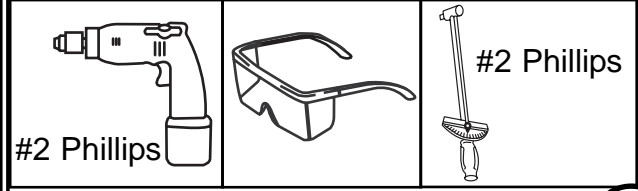

#2 Phillips

#2 Phillips

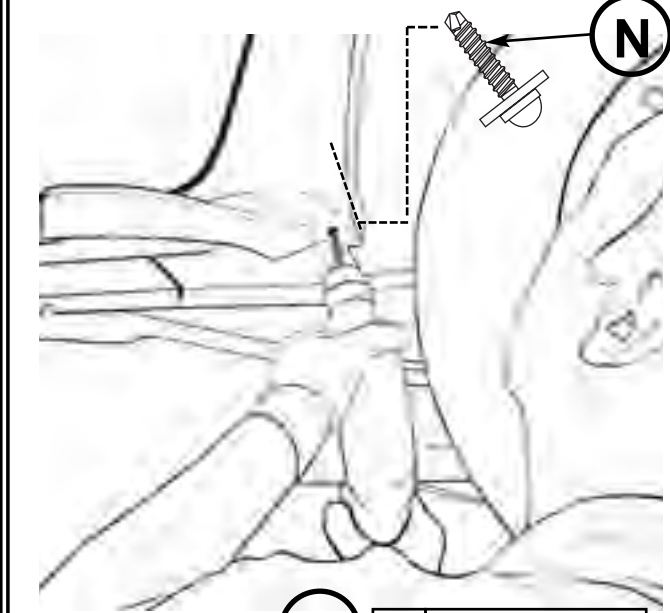

15

N 2x 42 in.-lbs.
(4.7 N-m)

- GB** Repeat Steps 1A, 2A-15 on other side
- D** Wiederholung Schritte 1A, 2A-15 wie auf der anderer Seite
- E** Repita los pasos 1A, 2A-15 en otro lado
- F** Répétez des étapes 1A, 2A-15 sur pour l'autre côté
- I** Ripetere i passi 1A, 2A-15 sull'altro lato

If there are no holes in gusset for RH bracket (13mm hole), use bracket as template, mark point then drill to 1/2", apply corrosion inhibitor part # 82300508.

2A

16

