

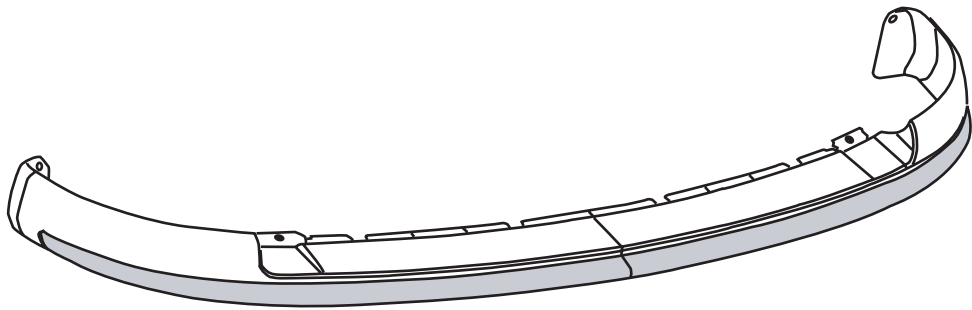

Dodge Ram

Air Dam Accent



A X1

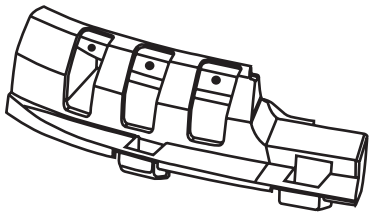

B X1

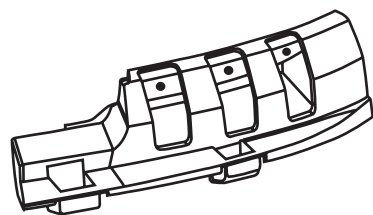

C X1

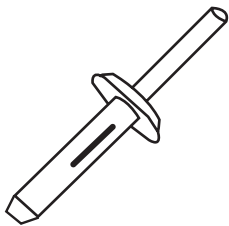

D X7

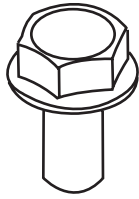

E X1

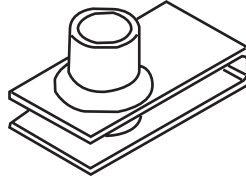

F X1

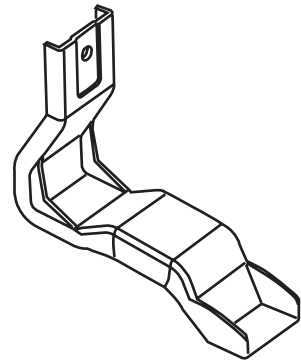

G X1



H

1/4"

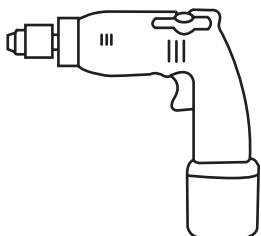

I



T30



J



K

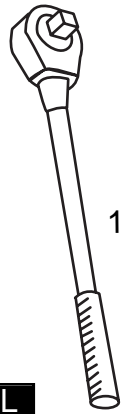

10 mm

L

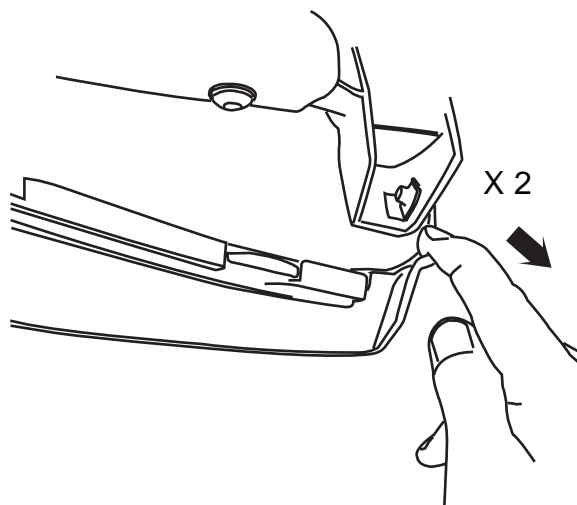

1

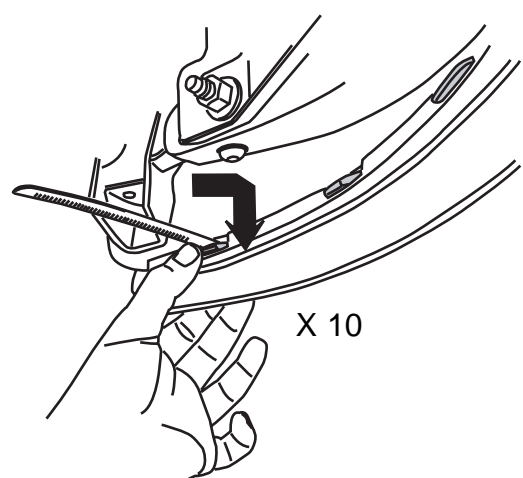

2

J

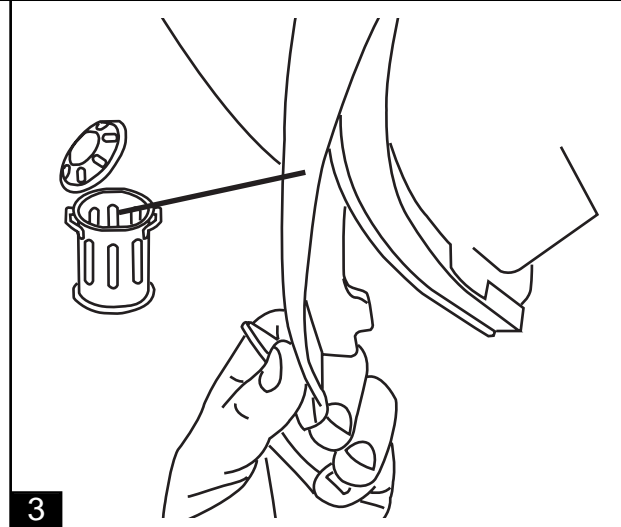

3

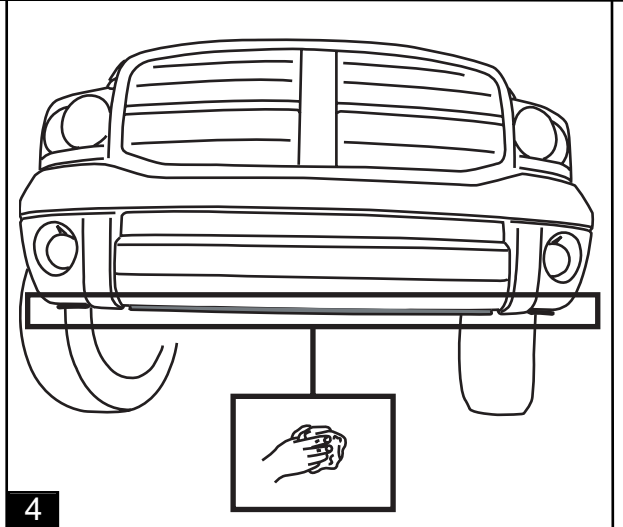

4

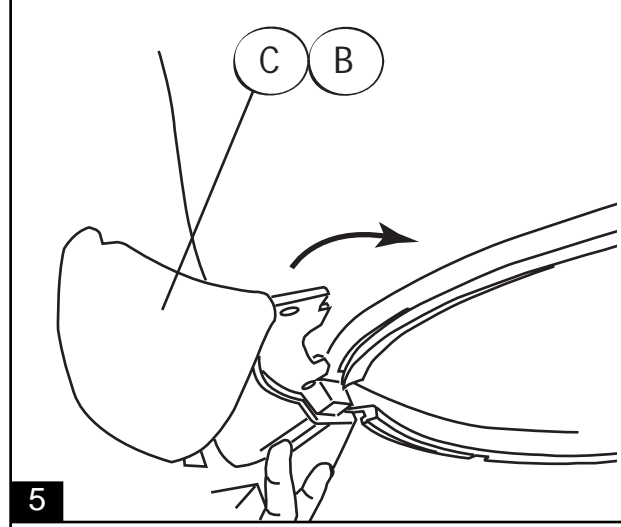

5

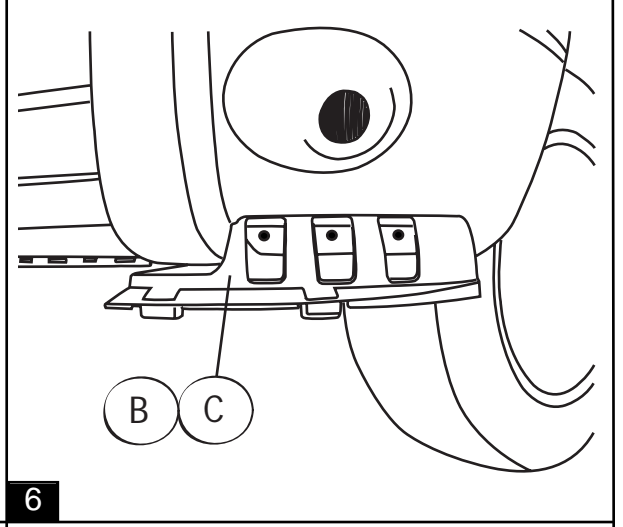

6

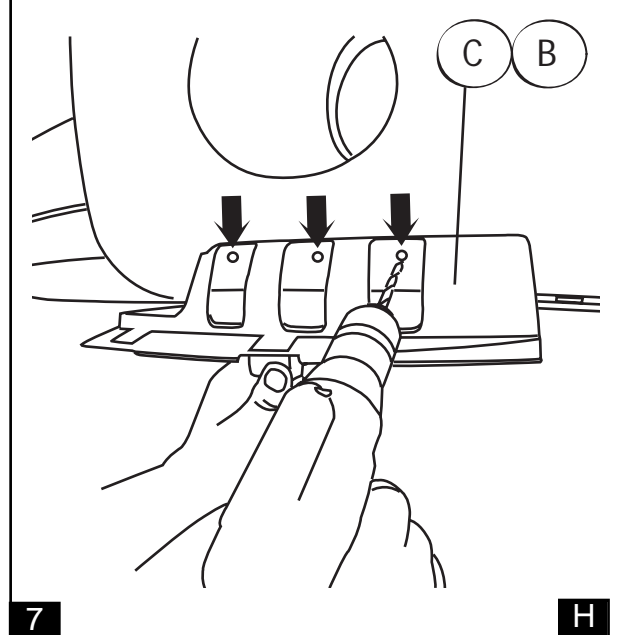

7

H

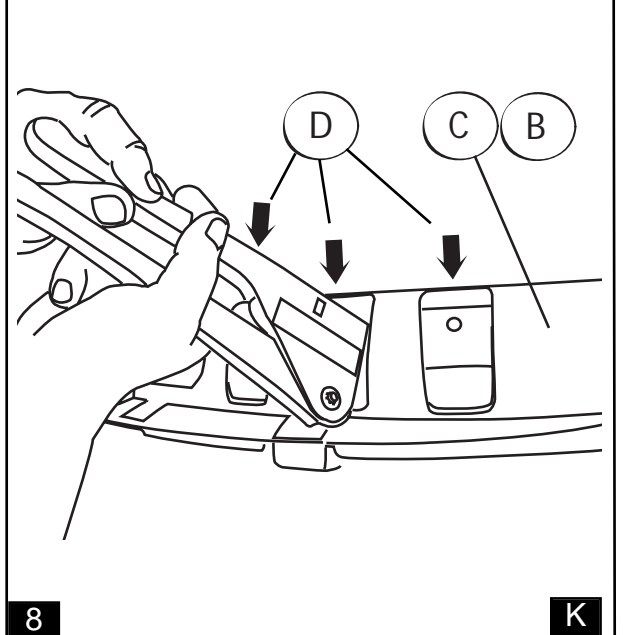

8

K

GB NOTE: Repeat steps 6-9 on the other side

E NOTA: Repita estos pasos 6-9 en otro lado

F NOTE: Répétez les étapes 6-9 pour l'autre côté

9

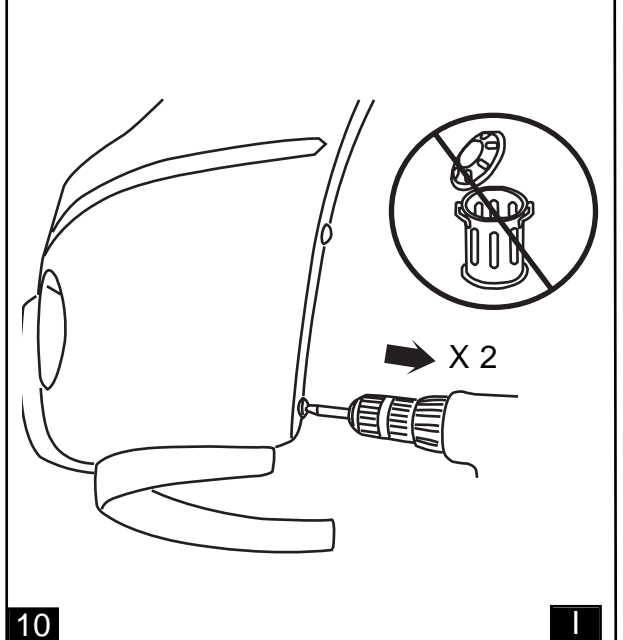

10

I

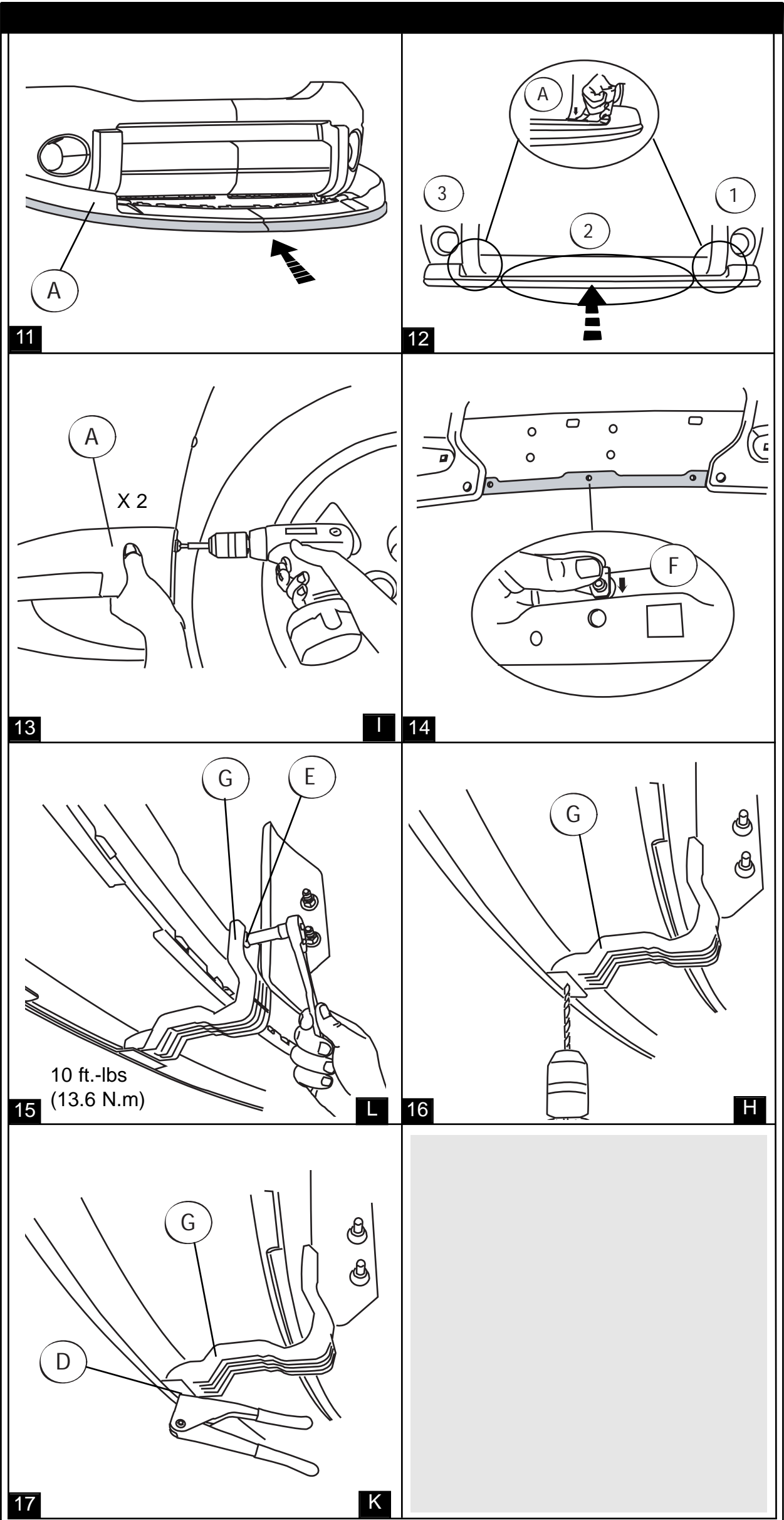

11

12

13

I

14

15

L

16

H

17

K

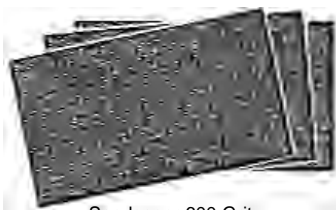

Sandpaper 600 Grit
Papel de lija, 600 granos
Papier sablé # 600



Isopropyl Alcohol C₃H₈O



M



Base Coat / Primera Capa / Peinture

N



Clearcoat

Pintura Transparente / Peindre Clair



GB

1. Read paint manufacturers specifications.
2. Sand all primed areas with 600 grit sandpaper.
3. Clean all parts with rubbing alcohol.
4. Mask all textured areas not requiring paint.

Note: Do not exceed 270°F (132.22°C) if baking parts. Step #9.

E

1. lea las especificaciones de la fabricante de pintura.
2. Frote con el papel de lija 600 granos la superficie pintada de primera capa.
3. Lave todas las piezas con alcohol de frotar.
4. Encubra toda la superficie texturada que no va a pintar.

Nota: Si esta cocinando piezas no excede 270°F (132.22°C). Esto paso #9.

F

1. Lisez les stipulations du manufactureurs de la peinture.
2. Sablez toutes les pièces avec du papier sablé # 600
3. Nettoyez toutes les pièces avec de l'alcool à friction.
4. Masquez les endroits qui n'ont besoin d'être peinturé.

Note: Ne pas excéder 270°F (132.22°C) pour la cuisson des pièces. Etapes #9.

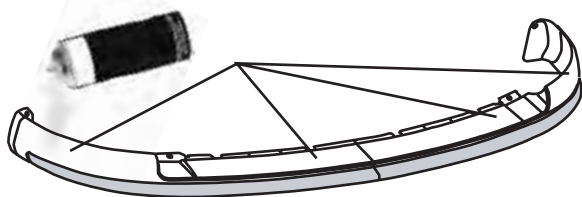

5

M



6

Wait until dry.
Espere hasta seco.
Attendre jusqu' à sec.

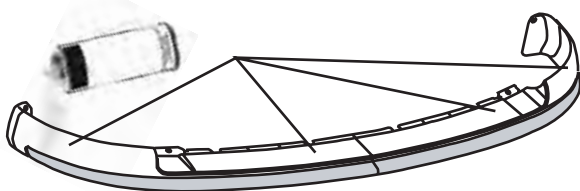

7

N



8

Wait until dry.
Espere hasta seco.
Attendre jusqu' à sec.



Note: Do not exceed 270°F (132.22°C) if baking parts.

Nota: Si esta cocinando piezas no excede 270°F (132.22°C)

Note: Ne pas excéder 270°F (132.22°C) pour la cuisson des pièces.

9

10

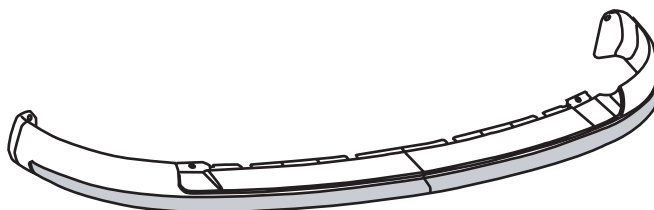

Allow paint to cure before un-masking.

Permita curar la pintura antes de-encumbra.

Laissez une période de traitement avant de démasquer.