

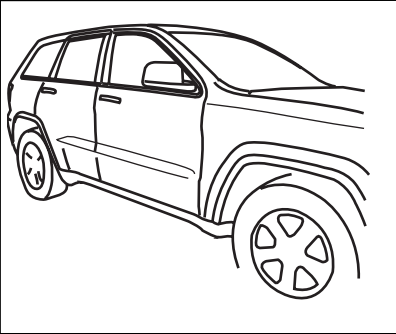

JEEP GRAND CHEROKEE

TUBULAR SIDE STEPS
EL LADO TUBULAR DA UN PASO
LES ETAPES LATERALES TUBULAIRES



M6



A 12x



B 6x

M8



C 6x

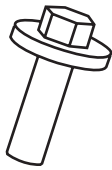

D 6x



E 12x

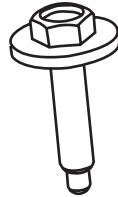

F 12x

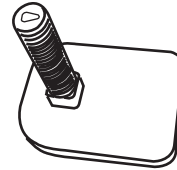

G 6x

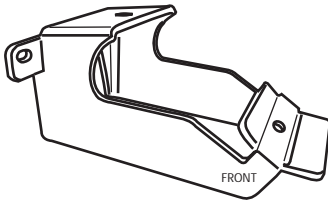

H1 2x

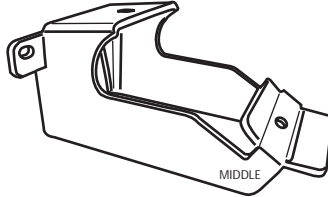

H2 2x

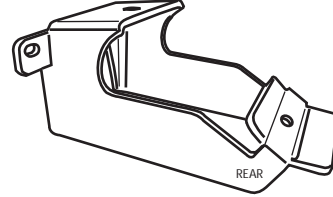

H3 2x



REAR
TRASERO
ARRIERE

PASSENGER'S SIDE
LADO de PASAJERO
COTE DU PASSAGER

FRONT
FRENTE
DEVANT

I 2x

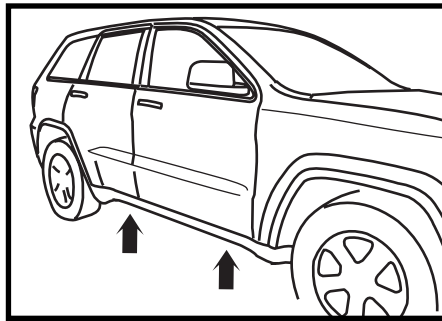
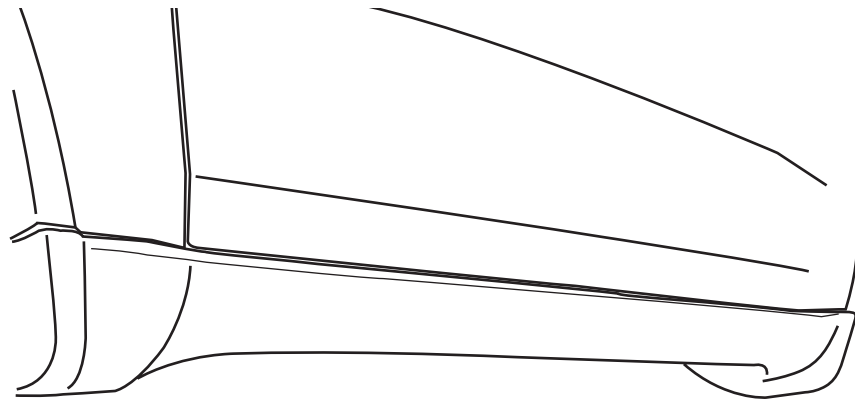

1

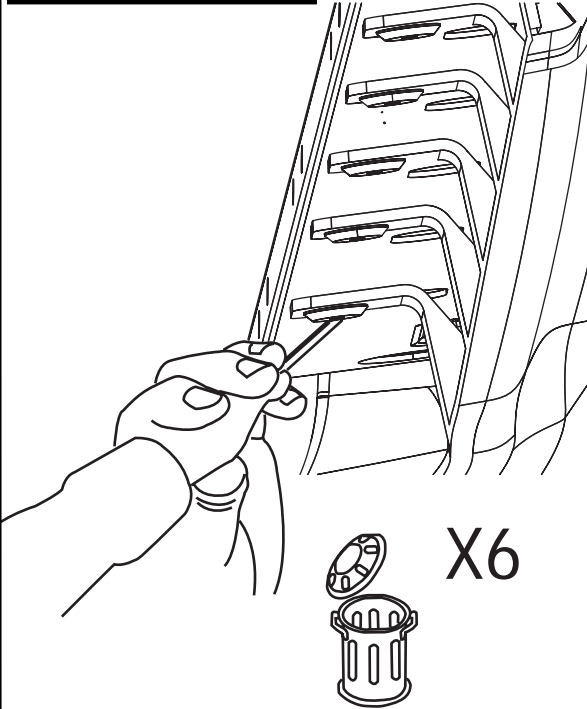
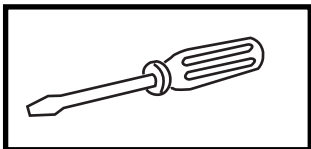

2

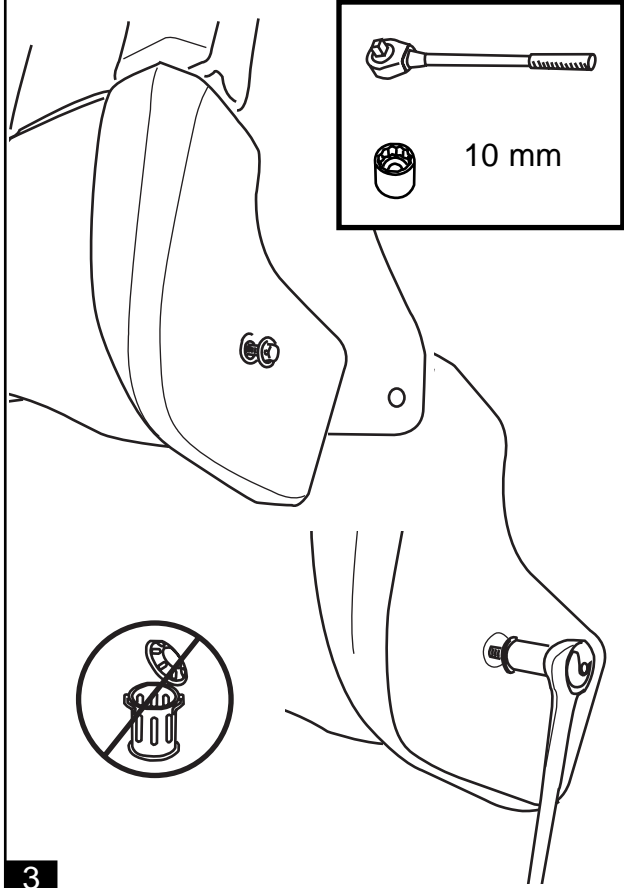
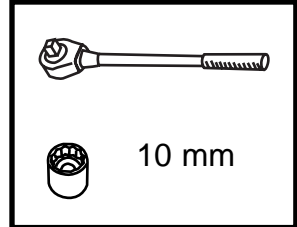

3

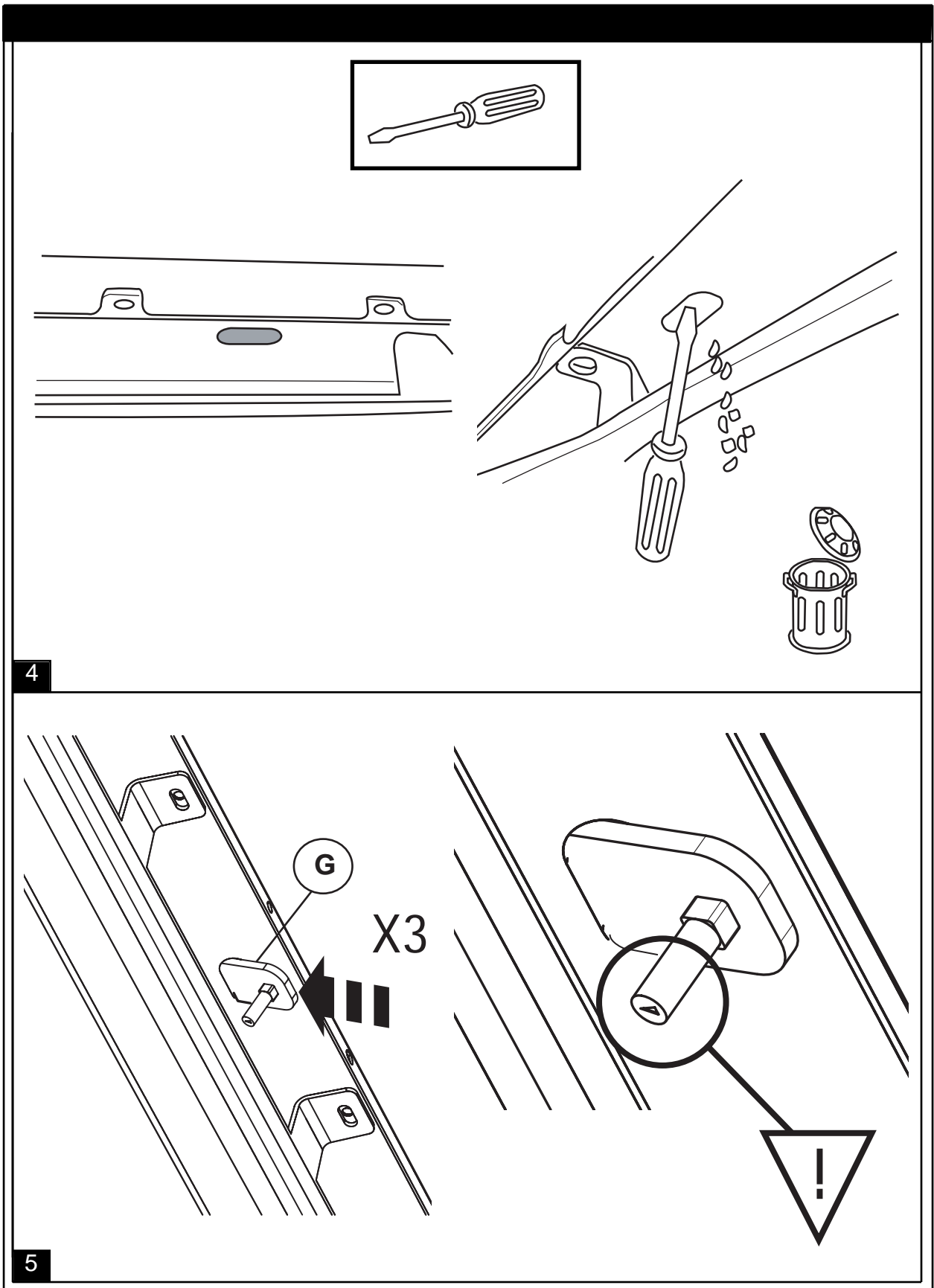

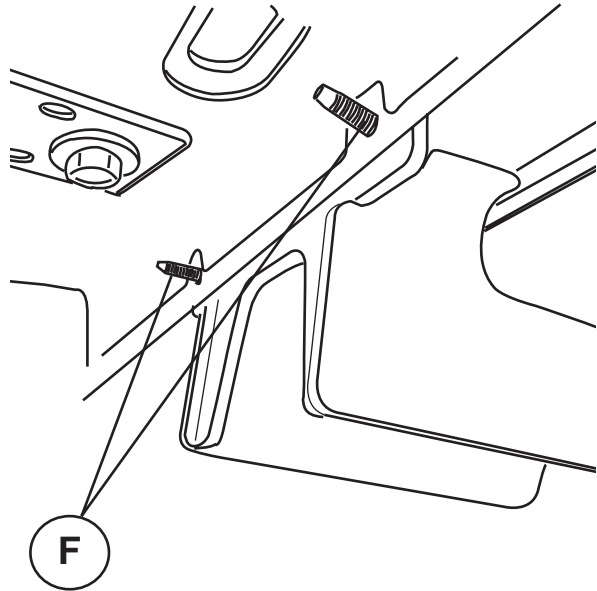
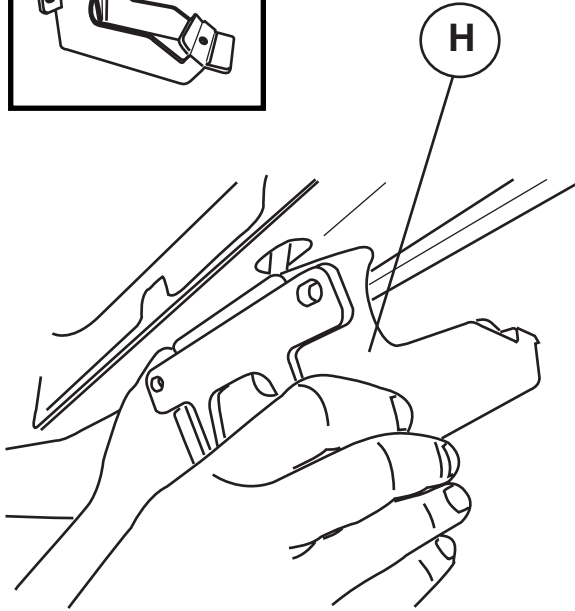
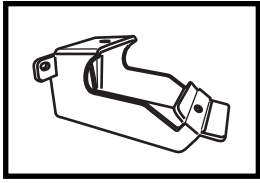

6

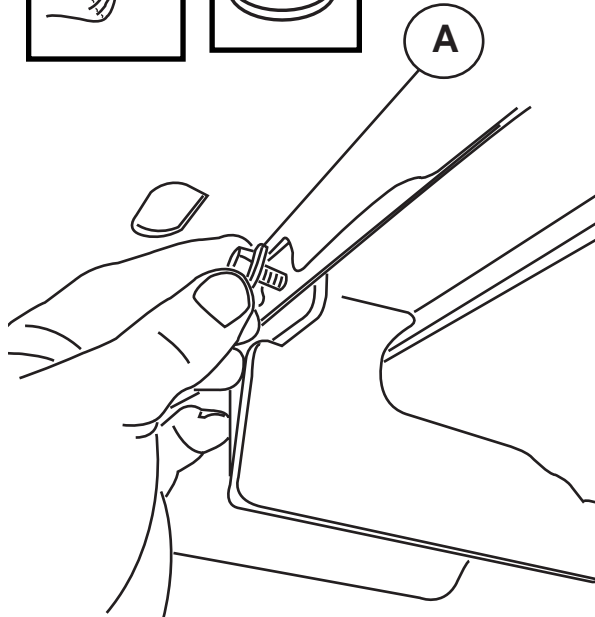
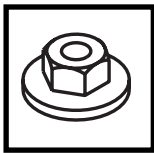

10 ft-lbs (120 in-lbs)

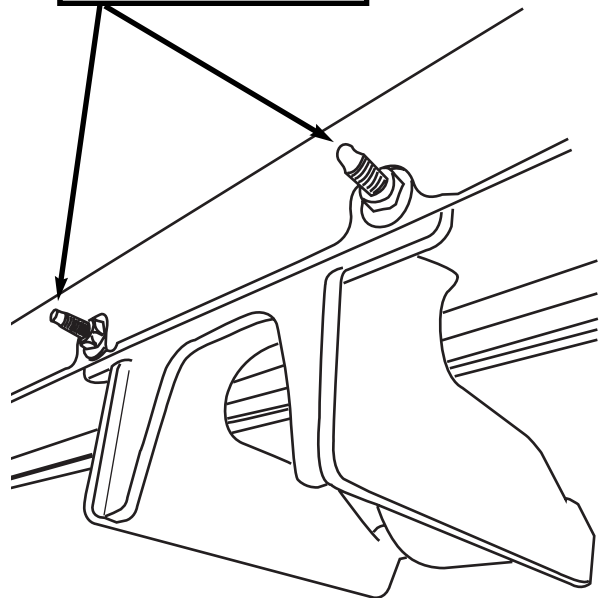

7

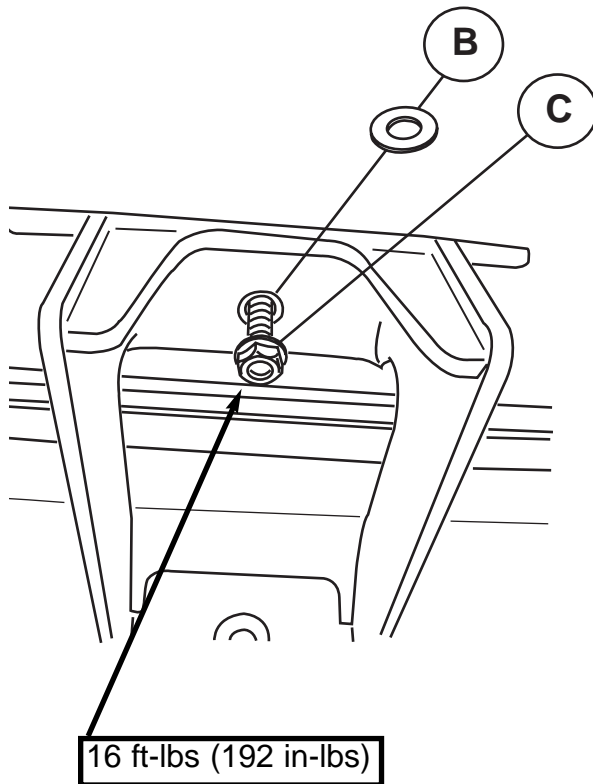

8

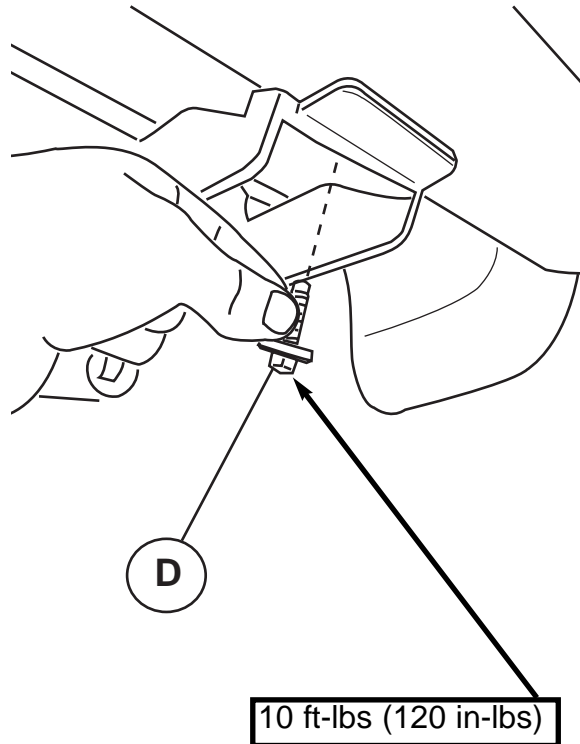

9

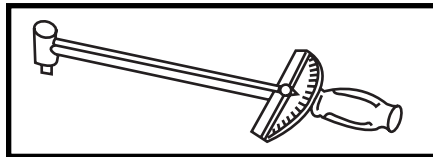

Tighten all M8 fasteners to 16 ft-lbs. (192 in-lbs.) (22 N.m). Tighten all M6 fasteners to 10 ft-lbs. (120 in-lbs.) (13.5 N.m). Repeat for Driver's side.
CAUTION - Do Not Over-torque

Apriete todos M8 clerres a 16 ft-lbs. (192 in-lbs.) (22 N.m). Apriete todos M6 clerres a 10 ft-lbs. (13.5 N.m). (120 in-lbs.) Repita el lado de pasajero.
Precaución: No apriete demasiado

Resserrer tous M8 fermoira pour 16 ft-lbs. (192 in-lbs.) (22 N.m). Resserrer tous M6 fermoira pour 10 ft-lbs. (120 in-lbs.) (13.5 N.m). Répéter pour le côté du chauffeur.

Attention: Ne pas surcoupler

10

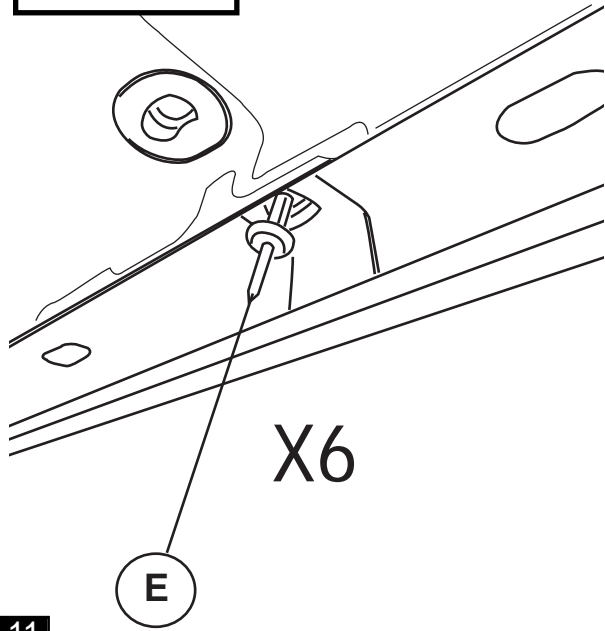
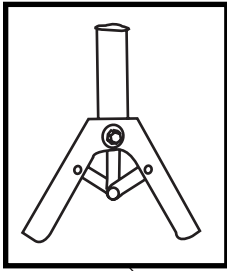

11

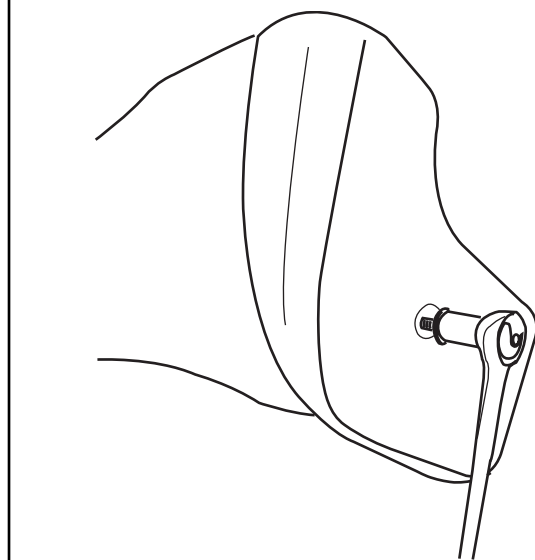
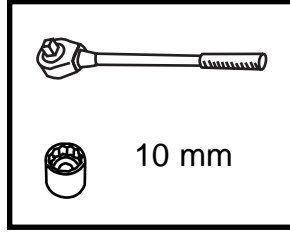

12

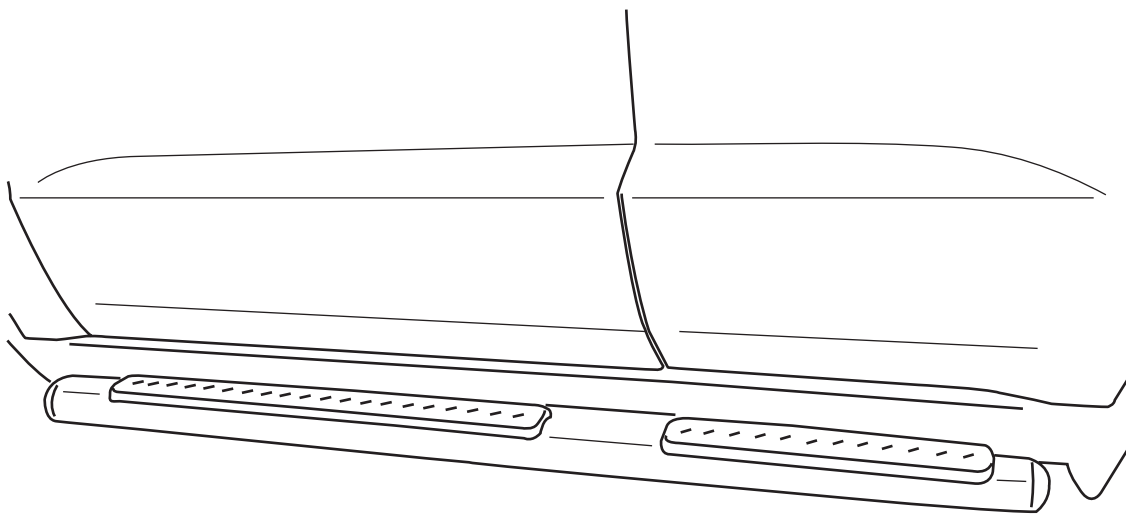

13